

**PRELIMINARY COPY**

FOR DISCUSSION PURPOSES ONLY

ISSUE DATE: 09/03/2016

**FILL NOTES:**

THIS PLAN SHOWS DETAILS OF WORKS AFFECTING THE NATURAL SURFACE OF THE LAND WITHIN THE SUBDIVISION WHICH HAVE BEEN CARRIED OUT OR ARE PROPOSED TO BE CARRIED OUT PRIOR TO REGISTRATION OF THE PLAN OF SUBDIVISION, BEING FILL PLACED ON THE LAND TO THE EXTENT AND DEPTH SHOWN ON THIS PLAN.

THIS PLAN DOES NOT SHOW ANY OTHER FILL WHICH MAY HAVE BEEN PLACED ON THE LAND PRIOR TO THE CIVIL WORKS BEING UNDERTAKEN.

THIS PLAN HAS BEEN PREPARED FOR THE PURPOSE OF CONSTRUCTING SUBDIVISIONAL WORKS AND IS NOT A RECORD OF 'AS BUILT DETAILS'.

FILLING SHOWN LESS THAN 200mm DEEP IS GRADED OR SPREAD OVER ALLOTMENTS TO CORRECT MINOR SURFACE IRREGULARITIES SUCH AS FURROWS ETC AND LOT GRADING.

IRRESPECTIVE OF THE DEPTH OF FILLING FOUNDATIONS MUST BE DESIGNED AND CONSTRUCTED IN ACCORDANCE WITH A SOIL CLASSIFICATION AND REPORT PREPARED FOR THE PURPOSE AND IN ACCORDANCE WITH THE APPROPRIATE BUILDING REGULATIONS.

THE AREA MARKED THUS ON THIS PLAN INDICATES FILL DEEPER THAN 200mm PLACED ON ALLOTMENTS.

THE EXTENT OF AND DEPTH OF FILL MUST BE CONFIRMED BY A PROPER GEOTECHNICAL INVESTIGATION BY AN EXPERIENCED PRACTITIONER.

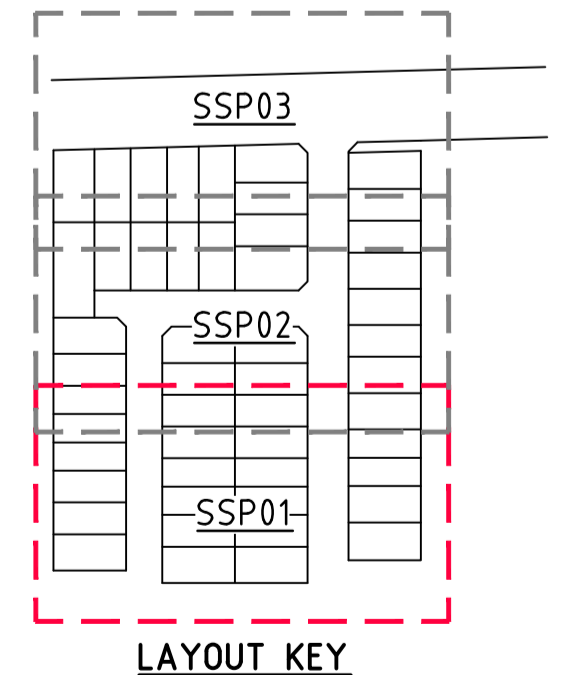
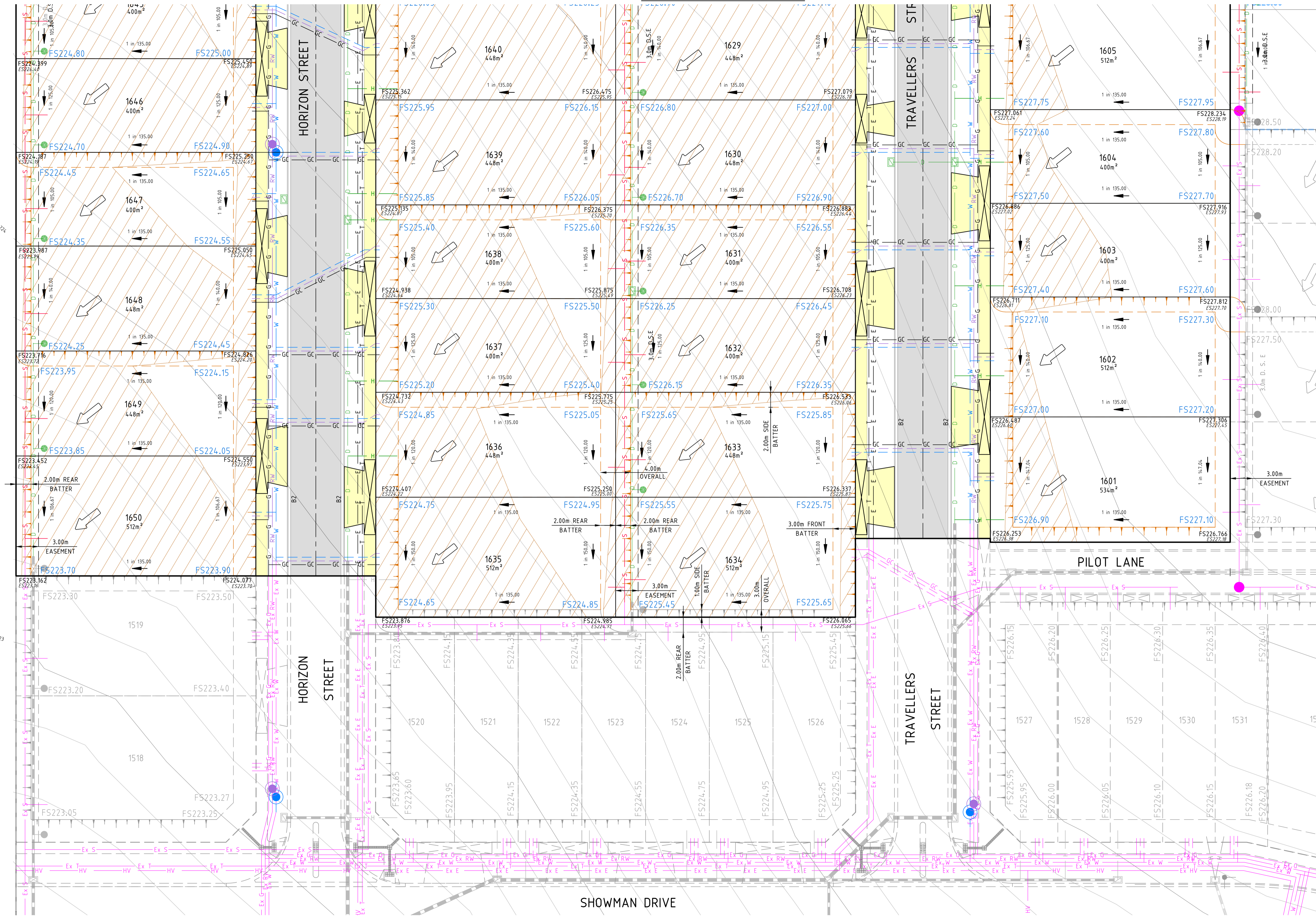

Drawing File: G:\Design\12340\_16-Bloomdale Diggers Rest\Acad\General\12340\_16SSP01.dwg - 12340\_16SSP01 Date/Time: Wed Mar 09, 2016 - 8:19:00m - matthew.copado

**NOT TO BE USED FOR CONSTRUCTION**

B	RE-ISSUED TO CLIENT	09/03/16	TL
A	ISSUED TO CLIENT	18/02/16	TL
REV	AMENDMENTS	DATE	APP'D.

Drawn M.CAPALDO  
Date 29/10/15  
AN -  
Designed K.PHAL  
Date 25/10/15  
AN  
Verified -  
Date -  
AN  
Audited -  
Date -  
AN  
Approved -  
Date -  
AN

**LEGEND**

	EXISTING WATER MAIN		WATER
	EXISTING GAS MAIN		RECYCLED WATER
	EXISTING ELECTRICAL CABLE		TELECOMMUNICATIONS
	EXISTING SEWER MAIN & MANHOLE		ELECTRICITY
	EXISTING TELECOMM. CABLE AND PIT		GAS
	EXISTING STORMWATER DRAIN & PIT		STREET NAME SIGN
	EXISTING ELEC. POLE & O'HEAD LINES		REGRADE LOT AT MIN 1 IN 150
	EXISTING STORMWATER DRAIN & PIT CONSTRUCTED PRE DEVELOPMENT		DW HYDRANT
	EXISTING SURFACE LEVEL (CORNER)		NDW HYDRANT
	FINISHED SURFACE LEVEL (CORNER)		GRADE OF ALLOTMENT (ALONG SIDE)
	FINISHED SURFACE LEVEL (EARTHWORKS PAD)		BATTER (GRADE AS SPECIFIED)
	PERMANENT SURVEY MARK		ALLOTMENT PAD BOUNDARY
	TEMPORARY BENCH MARK		

**INVESTA**

Coords: MGA  
Levels: AHD

Scale @ A1/A3

1 in 135.00

1 in 100.00

1 in 120.00

1 in 150.00

1 in 180.00

1 in 200.00

1 in 250.00

1 in 300.00

1 in 400.00

1 in 500.00

1 in 600.00

1 in 700.00

1 in 800.00

1 in 900.00

1 in 1000.00

**BLOOMDALE ESTATE**

STAGE 16  
85 DAVIS ROAD, DIGGERS REST  
SALES SERVICING PLAN  
SHEET 01 OF 03  
Drawing No. 12340.16SSP01 Rev B  
Sheet No. 01 PRELIMINARY  
© Dalton Consulting Engineers Pty Ltd

**DALTON CONSULTING ENGINEERS**

ABN 78 429 221 049  
QUEENSLAND  
T 61 7 3217 7234  
E info@dceng.com.au

VICTORIA  
T 61 3 9888 6866  
W dceng.com.au



FOR CONTINUATION REFER TO SHEET 03

PRELIMINARY COPY

FOR DISCUSSION PURPOSES ONLY

ISSUE DATE: 09/03/2016

FILL NOTES:

THIS PLAN SHOWS DETAILS OF WORKS AFFECTING THE NATURAL SURFACE OF THE LAND WITHIN THE SUBDIVISION WHICH HAVE BEEN CARRIED OUT OR ARE PROPOSED TO BE CARRIED OUT PRIOR TO REGISTRATION OF THE PLAN OF SUBDIVISION, BEING FILL PLACED ON THE LAND TO THE EXTENT AND DEPTH SHOWN ON THIS PLAN.

THIS PLAN DOES NOT SHOW ANY OTHER FILL WHICH MAY HAVE BEEN PLACED ON THE LAND PRIOR TO THE CIVIL WORKS BEING UNDERTAKEN.

THIS PLAN HAS BEEN PREPARED FOR THE PURPOSE OF CONSTRUCTING SUBDIVISIONAL WORKS AND IS NOT A RECORD OF 'AS BUILT DETAILS'.

FILLING SHOWN LESS THAN 200mm DEEP IS GRADED OR SPREAD OVER ALLOTMENTS TO CORRECT MINOR SURFACE IRREGULARITIES SUCH AS FURROWS ETC AND LOT GRADING.

IRRESPECTIVE OF THE DEPTH OF FILLING FOUNDATIONS MUST BE DESIGNED AND CONSTRUCTED IN ACCORDANCE WITH A SOIL CLASSIFICATION AND REPORT PREPARED FOR THE PURPOSE AND IN ACCORDANCE WITH THE APPROPRIATE BUILDING REGULATIONS.

THE AREA MARKED THUS ON THIS PLAN INDICATES FILL DEEPER THAN 200mm PLACED ON ALLOTMENTS.

THE EXTENT OF AND DEPTH OF FILL MUST BE CONFIRMED BY A PROPER GEOTECHNICAL INVESTIGATION BY AN EXPERIENCED PRACTITIONER.

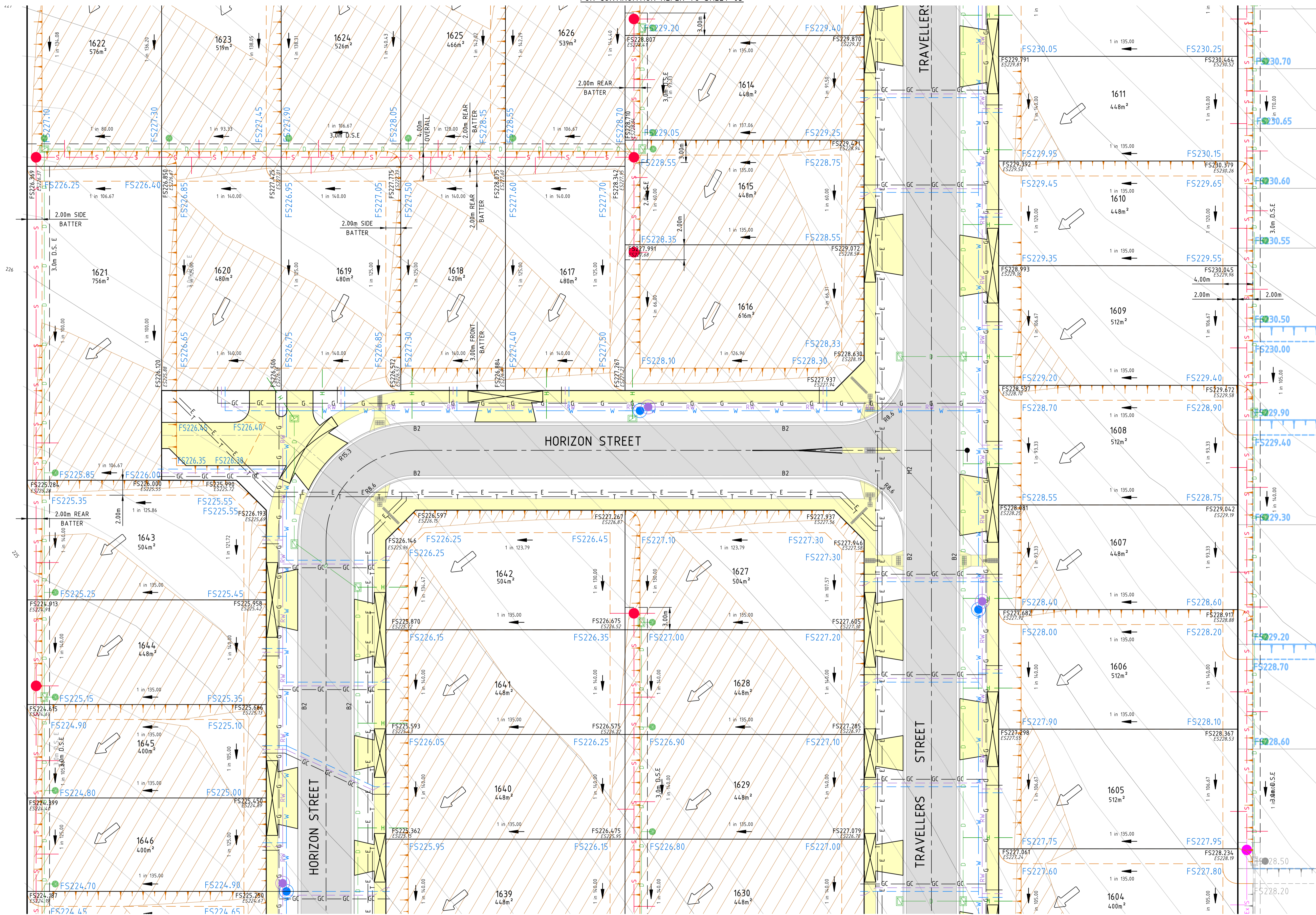
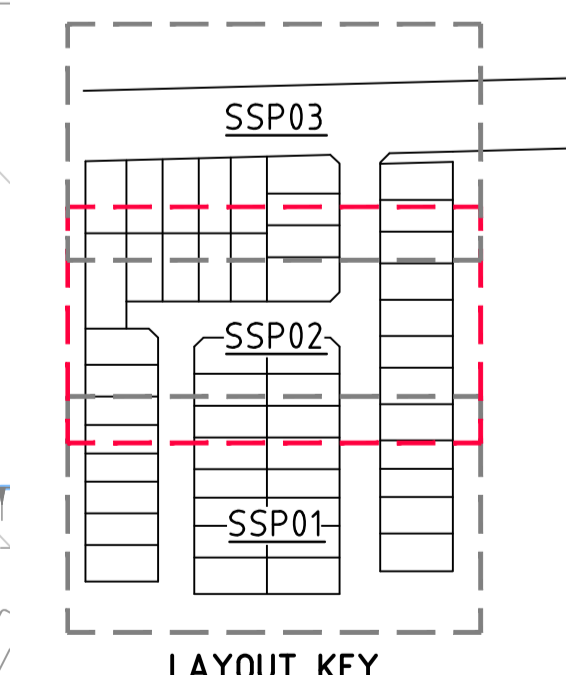

FOR CONTINUATION REFER TO SHEET 01

NOT TO BE USED FOR CONSTRUCTION

Table with columns: REV, AMENDMENTS, DATE, APP'D. Includes entries for re-issued and issued to client.

Drawn M.CAPALDO Date 29/10/15
AN - Designed K.PHAL Date 25/10/15
Verified -
Date -
Audited -
Date -
AN Approved -
Date -
AN

- Legend items: EX W - EXISTING WATER MAIN, EX G - EXISTING GAS MAIN, EX E - EXISTING ELECTRICAL CABLE, EX S - EXISTING SEWER MAIN & MANHOLE, EX T - EXISTING TELECOMM. CABLE AND PIT, EX P - EXISTING ELEC. POLE & O'HEAD LINES, EX D - EXISTING DRAIN & PIT, EX C - EXISTING CONDUIT, ES - EXISTING SURFACE LEVEL (CORNER), FS - FINISHED SURFACE LEVEL (CORNER), FS - FINISHED SURFACE LEVEL (EARTHWORKS PAD), PERMANENT SURVEY MARK, TEMPORARY BENCH MARK

- Legend items: S - SEWER MAIN AND MANHOLE, SW - STORMWATER DRAIN & PIT, P - SW DRAIN & PIT CONSTRUCTED IN PREVIOUS STAGES, I - PROPERTY INLETS, H - HOUSE DRAIN, GC - GAS CONDUIT, W - WATER CONDUIT, RW - RECYCLED WATER CONDUIT, TC - TELECOMM. CONDUIT, FUTURE BATTER (GRADE AS SPECIFIED), FUTURE ALLOTMENT PAD BOUNDARY

- Legend items: W - WATER, RW - RECYCLED WATER, T - TELECOMMUNICATIONS, E - ELECTRICITY, G - GAS, S - STREET NAME SIGN, R - REGRADE LOT AT MIN 1 IN 150, H - DW HYDRANT, W - NW HYDRANT, G - GRADE OF ALLOTMENT (ALONG SIDE), B - BATTER (GRADE AS SPECIFIED), A - ALLOTMENT PAD BOUNDARY

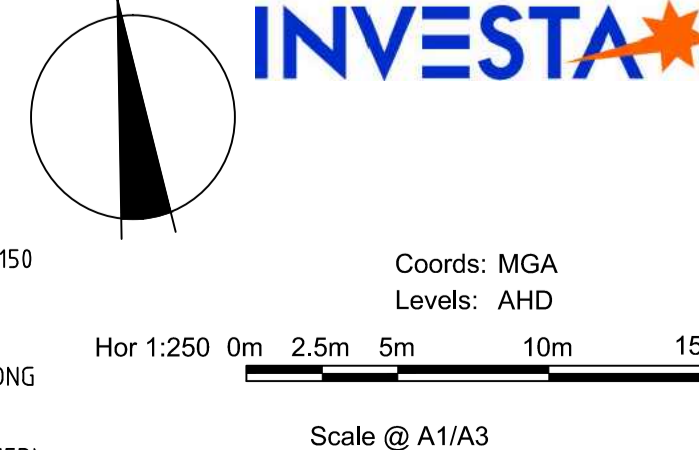

INVESTA BLOOMDALE ESTATE
STAGE 16
85 DAVIS ROAD, DIGGERS REST
SALES SERVICING PLAN
SHEET 02 OF 03
Drawing No. 12340.16SSP02 Rev B
Sheet No. 02 PRELIMINARY
© Dalton Consulting Engineers Pty Ltd

DALTON CONSULTING ENGINEERS
ABN 78 429 221 049
QUEENSLAND
T 61 7 3217 7234
E info@dceng.com.au

Drawing File: C:\Design\12340.16-Bloomdale Diggers Rest\Acad\General\12340.16SSP01.dwg - 12340.16SSP02
Date/Time: Wed Mar 09, 2016 - 8:19:00 - matt@dceng.com.au



**PRELIMINARY COPY**

FOR DISCUSSION PURPOSES ONLY

ISSUE DATE: 09/03/2016

**FILL NOTES:**

THIS PLAN SHOWS DETAILS OF WORKS AFFECTING THE NATURAL SURFACE OF THE LAND WITHIN THE SUBDIVISION WHICH HAVE BEEN CARRIED OUT OR ARE PROPOSED TO BE CARRIED OUT PRIOR TO REGISTRATION OF THE PLAN OF SUBDIVISION, BEING FILL PLACED ON THE LAND TO THE EXTENT AND DEPTH SHOWN ON THIS PLAN.

THIS PLAN DOES NOT SHOW ANY OTHER FILL WHICH MAY HAVE BEEN PLACED ON THE LAND PRIOR TO THE CIVIL WORKS BEING UNDERTAKEN.

THIS PLAN HAS BEEN PREPARED FOR THE PURPOSE OF CONSTRUCTING SUBDIVISIONAL WORKS AND IS NOT A RECORD OF 'AS BUILT DETAILS'.

FILLING SHOWN LESS THAN 200mm DEEP IS GRADED OR SPREAD OVER ALLOTMENTS TO CORRECT MINOR SURFACE IRREGULARITIES SUCH AS FURROWS ETC AND LOT GRADING.

IRRESPECTIVE OF THE DEPTH OF FILLING FOUNDATIONS MUST BE DESIGNED AND CONSTRUCTED IN ACCORDANCE WITH A SOIL CLASSIFICATION AND REPORT PREPARED FOR THE PURPOSE AND IN ACCORDANCE WITH THE APPROPRIATE BUILDING REGULATIONS.

THE AREA MARKED THUS ON THIS PLAN INDICATES FILL DEEPER THAN 200mm PLACED ON ALLOTMENTS.

THE EXTENT OF AND DEPTH OF FILL MUST BE CONFIRMED BY A PROPER GEOTECHNICAL INVESTIGATION BY AN EXPERIENCED PRACTITIONER.

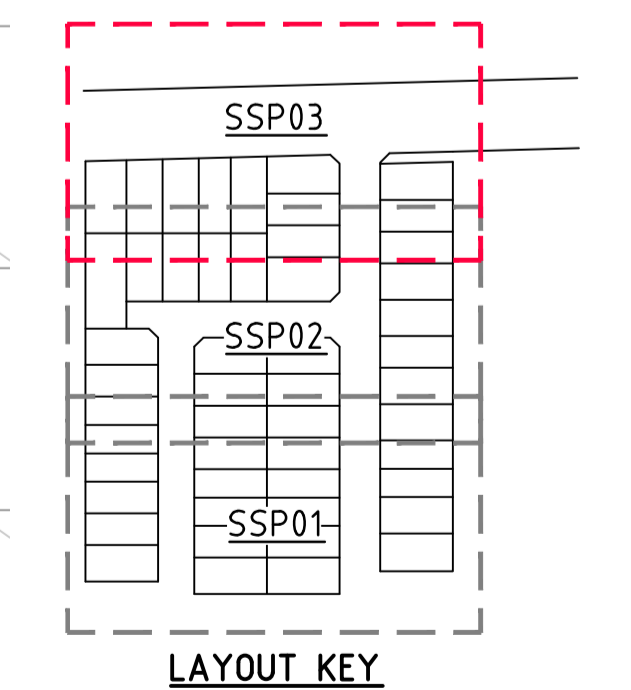
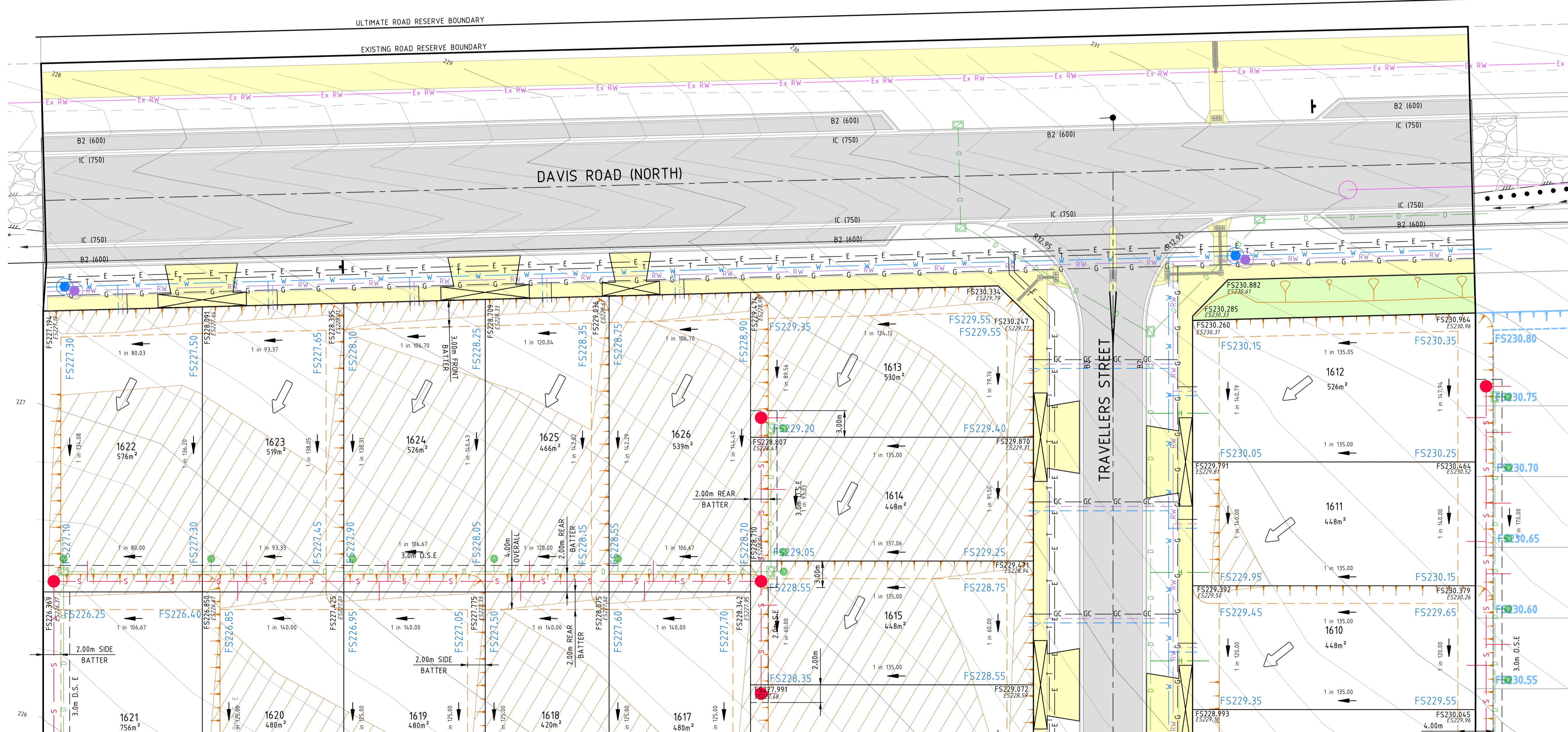
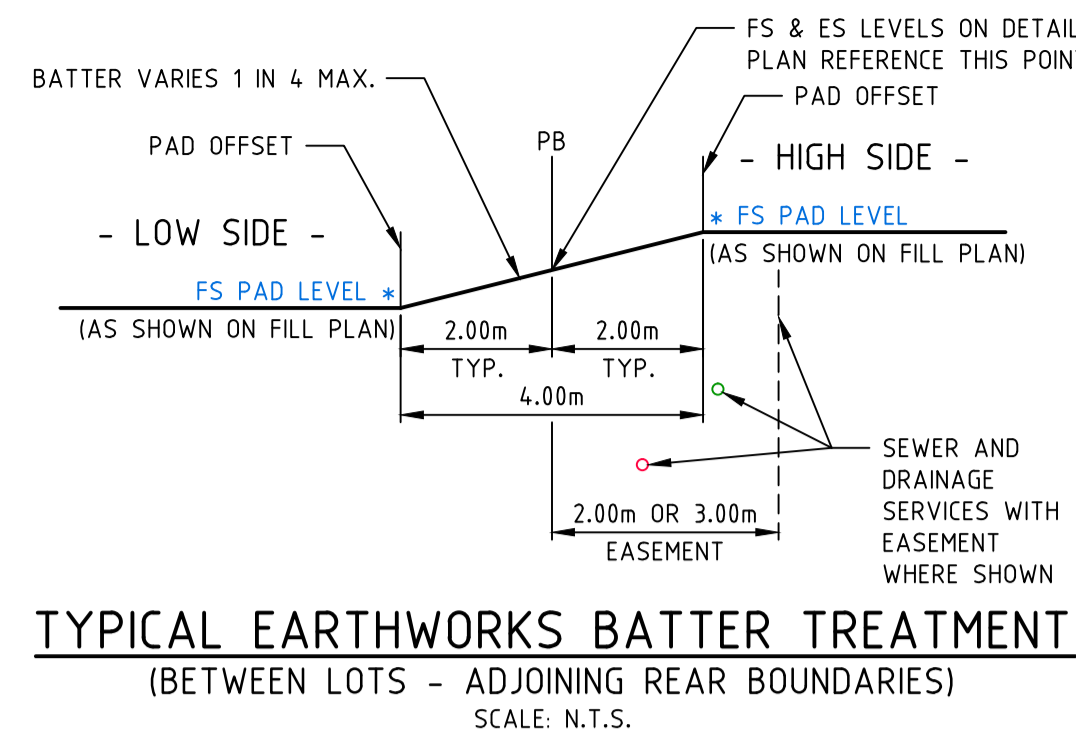
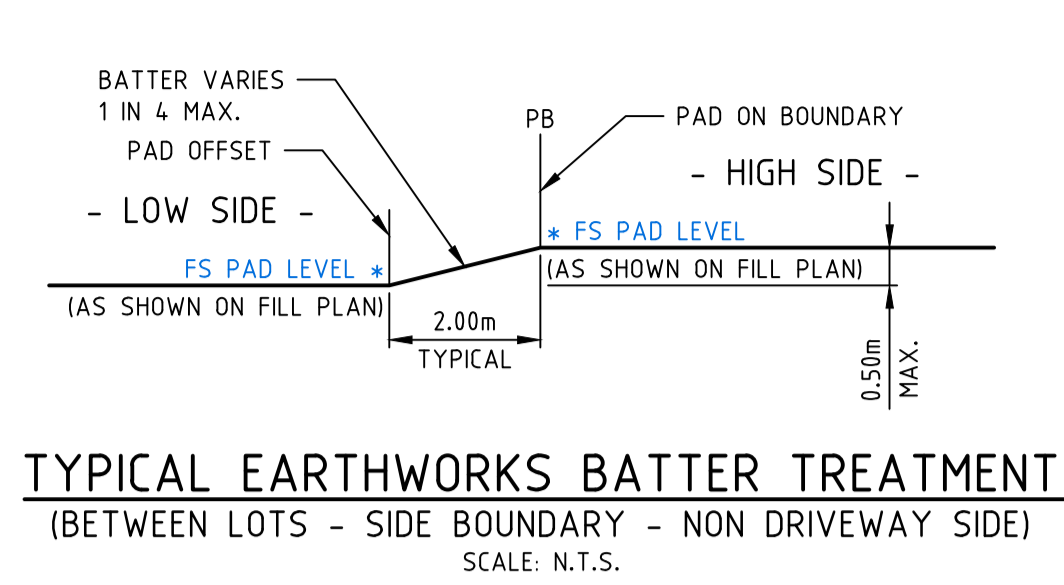
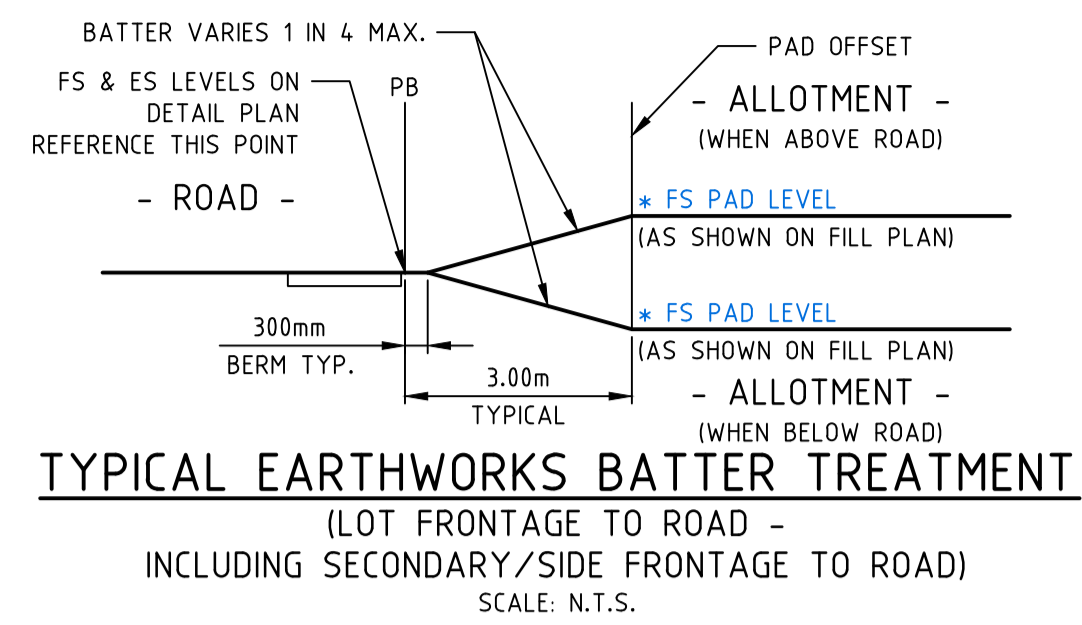

Drawing File: C:\Design\12340\16-Bloomdale Diggers Rest\Acad\General\12340\_16SSP03.dwg - 12340\_16SSP03 Date/Time: Wed Mar 09, 2016 - 9:19am - matthew.copello

FOR CONTINUATION REFER TO SHEET 02

<b>NOT TO BE USED FOR CONSTRUCTION</b>			
B	RE-ISSUED TO CLIENT	09/03/16	TL
A	ISSUED TO CLIENT	18/02/16	TL
REV	AMENDMENTS	DATE	APP'D.

Drawn M.CAPALDO  
Date 29/10/15  
AN -  
Designed K.PHAL  
Date 25/10/15  
AN  
Verified -  
Date -  
AN  
Audited -  
Date -  
AN  
Approved -  
Date -  
AN

- LEGEND**
- Ex W- EXISTING WATER MAIN
  - Ex G- EXISTING GAS MAIN
  - Ex E- EXISTING ELECTRICAL CABLE
  - Ex S- EXISTING SEWER MAIN & MANHOLE
  - Ex T- EXISTING TELECOMM. CABLE AND PIT
  - Ex P- EXISTING ELEC. POLE & O'HEAD LINES
  - Ex D- EXISTING STORMWATER DRAIN & PIT
  - Ex C- EXISTING PRE DEVELOPMENT CONSTRUCTED
  - ES - EXISTING SURFACE LEVEL (CORNER)
  - FS - FINISHED SURFACE LEVEL (CORNER)
  - FS - FINISHED SURFACE LEVEL (EARTHWORKS PAD)
  - ▲ - PERMANENT SURVEY MARK
  - ▲ - TEMPORARY BENCH MARK
  - S- SEWER MAIN AND MANHOLE
  - S- STORMWATER DRAIN & PIT
  - S- SW DRAIN & PIT CONSTRUCTED IN PREVIOUS STAGES
  - P- PROPERTY INLETS
  - H- HOUSE DRAIN
  - GC- GAS CONDUIT
  - WC- WATER CONDUIT
  - RWC- RECYCLED WATER CONDUIT
  - TC- TELECOMM. CONDUIT
  - F- FUTURE BATTER (GRADE AS SPECIFIED)
  - F- FUTURE ALLOTMENT PAD BOUNDARY
  - W- WATER
  - RW- RECYCLED WATER
  - T- TELECOMMUNICATIONS
  - E- ELECTRICITY
  - G- GAS
  - S- STREET NAME SIGN
  - D- REGRADE LOT AT MIN 1 IN 150
  - H- DW HYDRANT
  - N- NDW HYDRANT
  - G- GRADE OF ALLOTMENT (ALONG SIDE)
  - B- BATTER (GRADE AS SPECIFIED)
  - A- ALLOTMENT PAD BOUNDARY

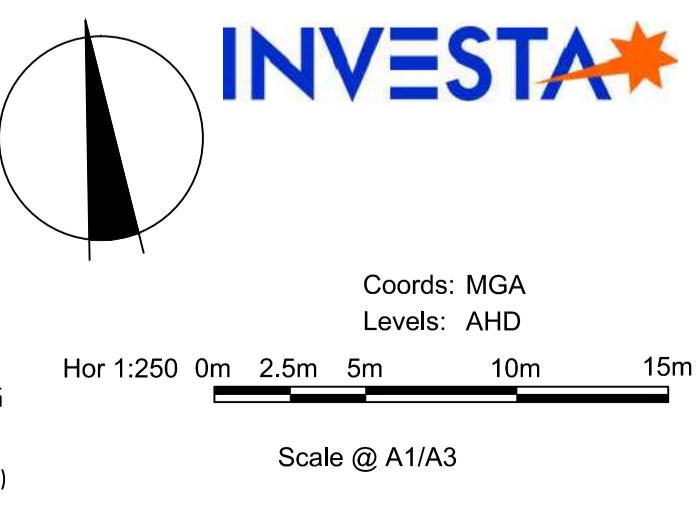

**INVESTA** BLOOMDALE ESTATE  
STAGE 16  
85 DAVIS ROAD, DIGGERS REST  
SALES SERVICING PLAN  
SHEET 03 OF 03  
Drawing No. 12340.16SSP03 Rev B  
Sheet No. 03 PRELIMINARY  
© Dalton Consulting Engineers Pty Ltd

**DALTON CONSULTING ENGINEERS**  
ABN 78 429 221 049  
QUEENSLAND  
T 61 7 3217 7234  
E info@dceng.com.au

VICTORIA  
T 61 3 9888 6866  
W dceng.com.au