

TYPICAL EARTHWORKS BATTER TREATMENT
(LOT FRONTAGE TO ROAD - INCLUDING SECONDARY/SIDE FRONTAGE TO ROAD)
SCALE: N.T.S.

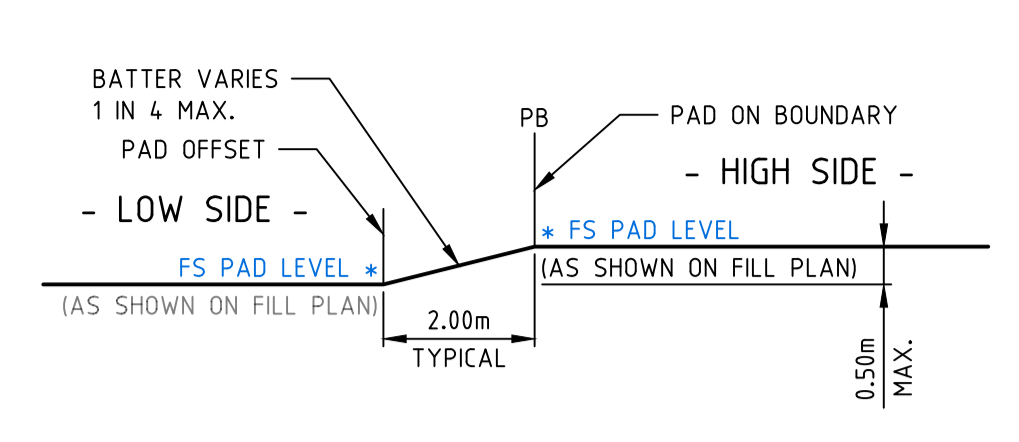

TYPICAL EARTHWORKS BATTER TREATMENT
(BETWEEN LOTS - SIDE BOUNDARY - NON DRIVEWAY SIDE)
SCALE: N.T.S.

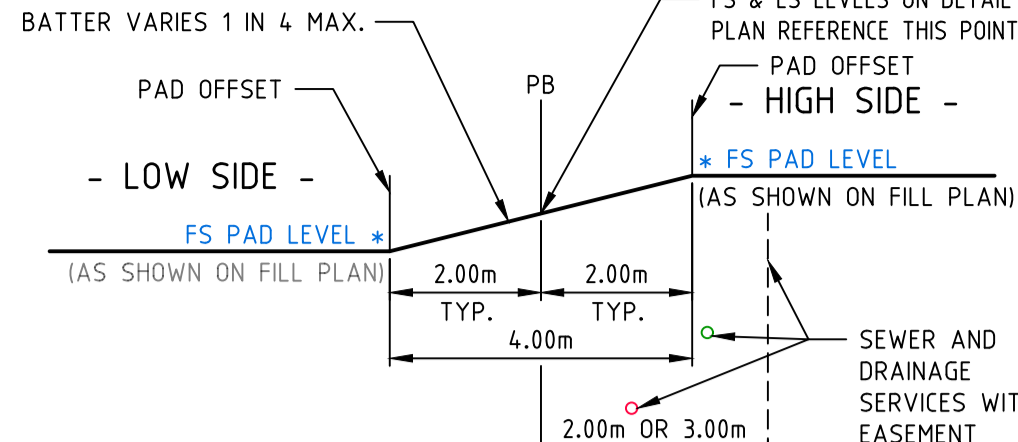

TYPICAL EARTHWORKS BATTER TREATMENT
(BETWEEN LOTS - ADJOINING REAR BOUNDARIES)
SCALE: N.T.S.

FILL NOTES:

THIS PLAN SHOWS DETAILS OF WORKS AFFECTING THE NATURAL SURFACE OF THE LAND WITHIN THE SUBDIVISION WHICH HAVE BEEN CARRIED OUT OR ARE PROPOSED TO BE CARRIED OUT PRIOR TO REGISTRATION OF THE PLAN OF SUBDIVISION, BEING FILL PLACED ON THE LAND TO THE EXTENT AND DEPTH SHOWN ON THIS PLAN.

THIS PLAN DOES NOT SHOW ANY OTHER FILL WHICH MAY HAVE BEEN PLACED ON THE LAND PRIOR TO THE CIVIL WORKS BEING UNDERTAKEN.

THIS PLAN HAS BEEN PREPARED FOR THE PURPOSE OF CONSTRUCTING SUBDIVISIONAL WORKS AND IS NOT A RECORD OF 'AS BUILT DETAILS'.

FILLING SHOWN LESS THAN 200mm DEEP IS GRADED OR SPREAD OVER ALLOTMENTS TO CORRECT MINOR SURFACE IRREGULARITIES SUCH AS FURROWS ETC AND LOT GRADING.

IRRESPECTIVE OF THE DEPTH OF FILLING FOUNDATIONS MUST BE DESIGNED AND CONSTRUCTED IN ACCORDANCE WITH A SOIL CLASSIFICATION AND REPORT PREPARED FOR THE PURPOSE AND IN ACCORDANCE WITH THE APPROPRIATE BUILDING REGULATIONS.

THE AREA MARKED THUS ON THIS PLAN INDICATES FILL DEEPER THAN 200mm PLACED ON ALLOTMENTS.

THE EXTENT OF AND DEPTH OF FILL MUST BE CONFIRMED BY A PROPER GEOTECHNICAL INVESTIGATION BY AN EXPERIENCED PRACTITIONER.

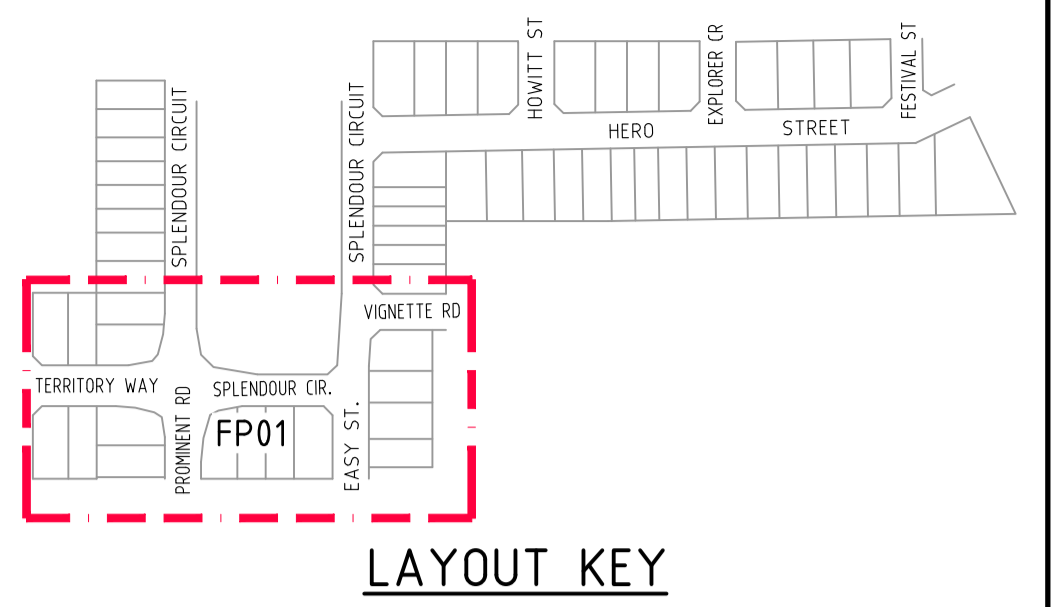

LAYOUT KEY

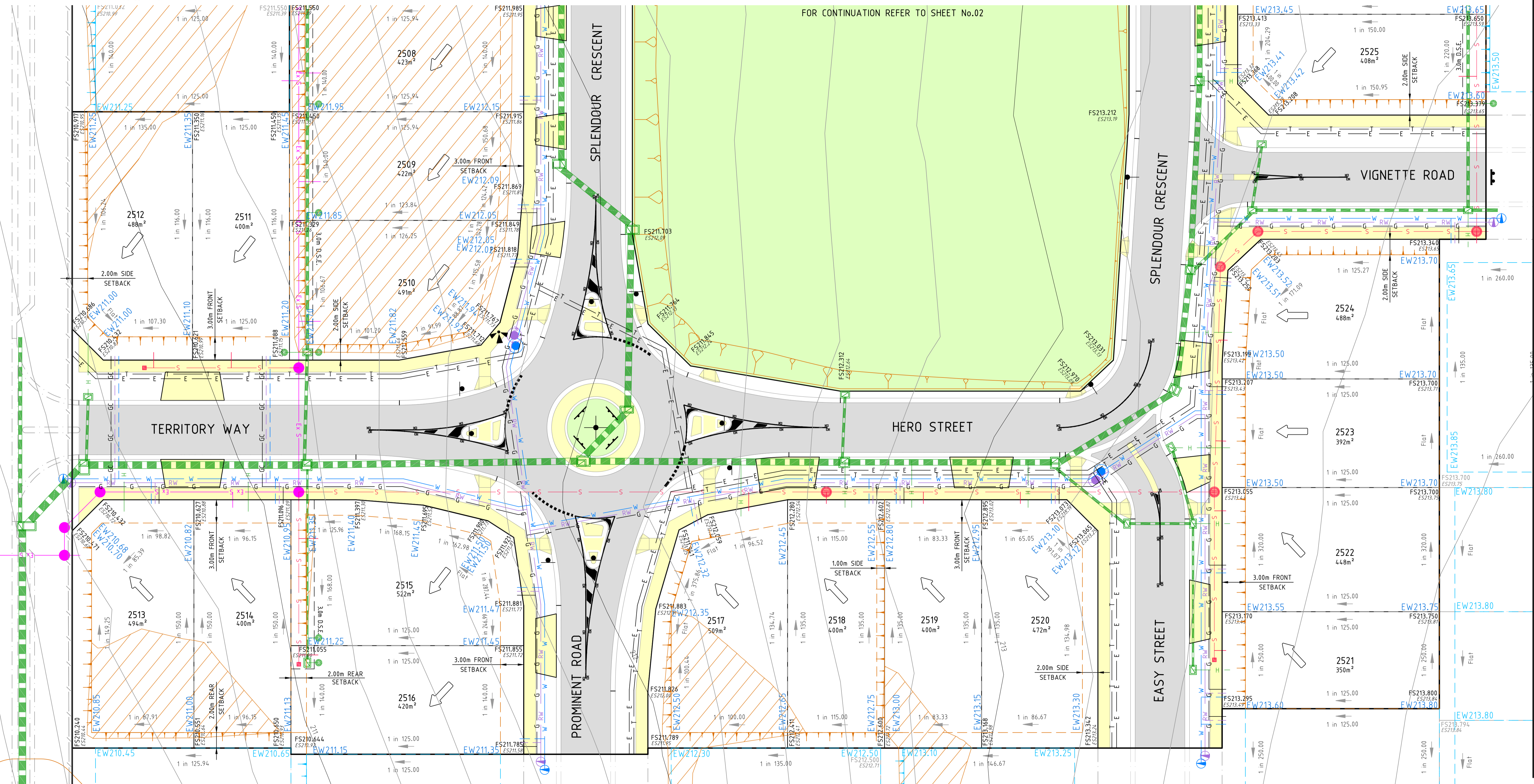

NOT TO BE USED FOR CONSTRUCTION

Drawn -	Date -	AN	Designed -	Date -	AN	Verified -	Date -	AN	Audited -	Date -	AN	Approved -	Date -	AN
A	PRELIMINARY ISSUE		24/10/16	TL										
REV	AMENDMENTS													

Written dimensions to take precedence over scale. Contractor shall check and verify all dimensions on site. Discrepancies to be brought to the attention of the Superintendent.

LEGEND

- Ex W - EXISTING WATER MAIN
- Ex G - EXISTING GAS MAIN
- Ex E - EXISTING ELECTRICAL CABLE
- Ex S - EXISTING SEWER MAIN & MANHOLE
- Ex T - EXISTING TELECOMM. CABLE
- Ex SD - EXISTING STORMWATER DRAIN & PIT
- Ex CD - EXISTING CONSTRUCTED PRE DEVELOPMENT BATTER (GRADE AS SPECIFIED) (SHOWN WHERE GRADES > 1 in 10)
- AB - ALLOTMENT PAD BOUNDARY
- S - SEWER MAIN AND MANHOLE
- SD - STORMWATER DRAIN & PIT
- SW - SW DRAIN & PIT CONSTRUCTED IN PREVIOUS STAGES
- GD - GAS DRAIN
- GC - GAS CONDUIT
- WC - WATER CONDUIT
- RC - RECYCLED WATER CONDUIT
- ES - EXISTING SURFACE LEVEL (CORNER)
- FS - FINISHED SURFACE LEVEL (CORNER)
- EW - EARTHWORKS PAD LEVEL (FUTURE)
- EW - EARTHWORKS PAD LEVEL
- EX - EARTHWORKS PAD LEVEL
- W - WATER
- RW - RECYCLED WATER
- T - TELECOMMUNICATIONS
- E - ELECTRICITY
- G - GAS
- SN - STREET NAME SIGN
- DW - DW HYDRANT
- NW - NDW HYDRANT
- DF - DIRECTION OF FALL (1 IN 150 MINIMUM)
- DW - DW WASHOUT
- NDW - NDW WASHOUT

AVID Property Group

Coords: MGA
Levels: AHD

Scale @ A1/A3 1:250/1:500

BLOOMDALE ESTATE - AREA B

STAGE 25
120 DIGGERS REST-COIMADAI ROAD, DIGGERS REST, 3427

SALES SERVICING PLAN

SHEET 01 OF 04
Drawing No. 12563.25SSP01 Rev A

Sheet No. 01 PRELIMINARY

© Dalton Consulting Engineers Pty Ltd

DALTON CONSULTING ENGINEERS

ABN 78 429 221 049
QUEENSLAND
T 61 7 3374 9000
E info@dceng.com.au

VICTORIA
T 61 3 9813 7400
W dceng.com.au

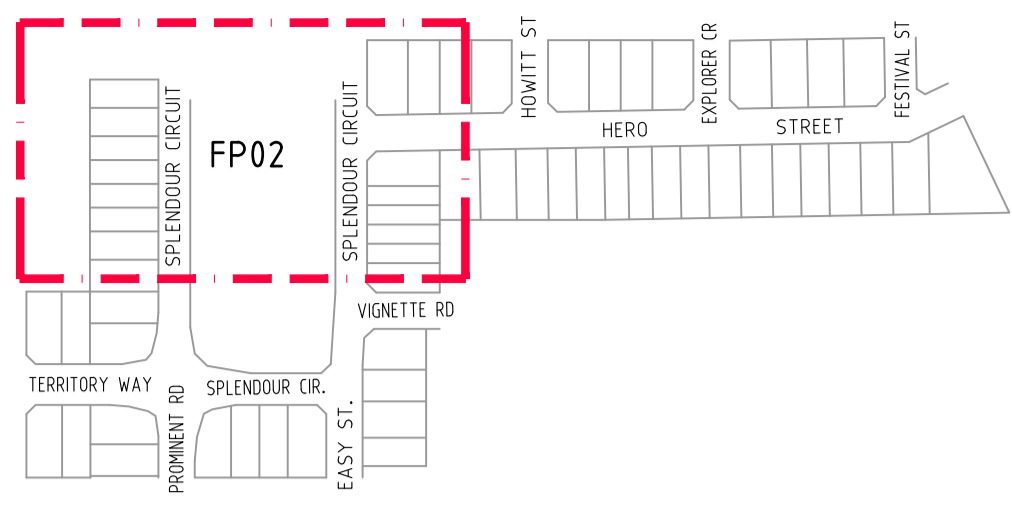

LAYOUT KEY

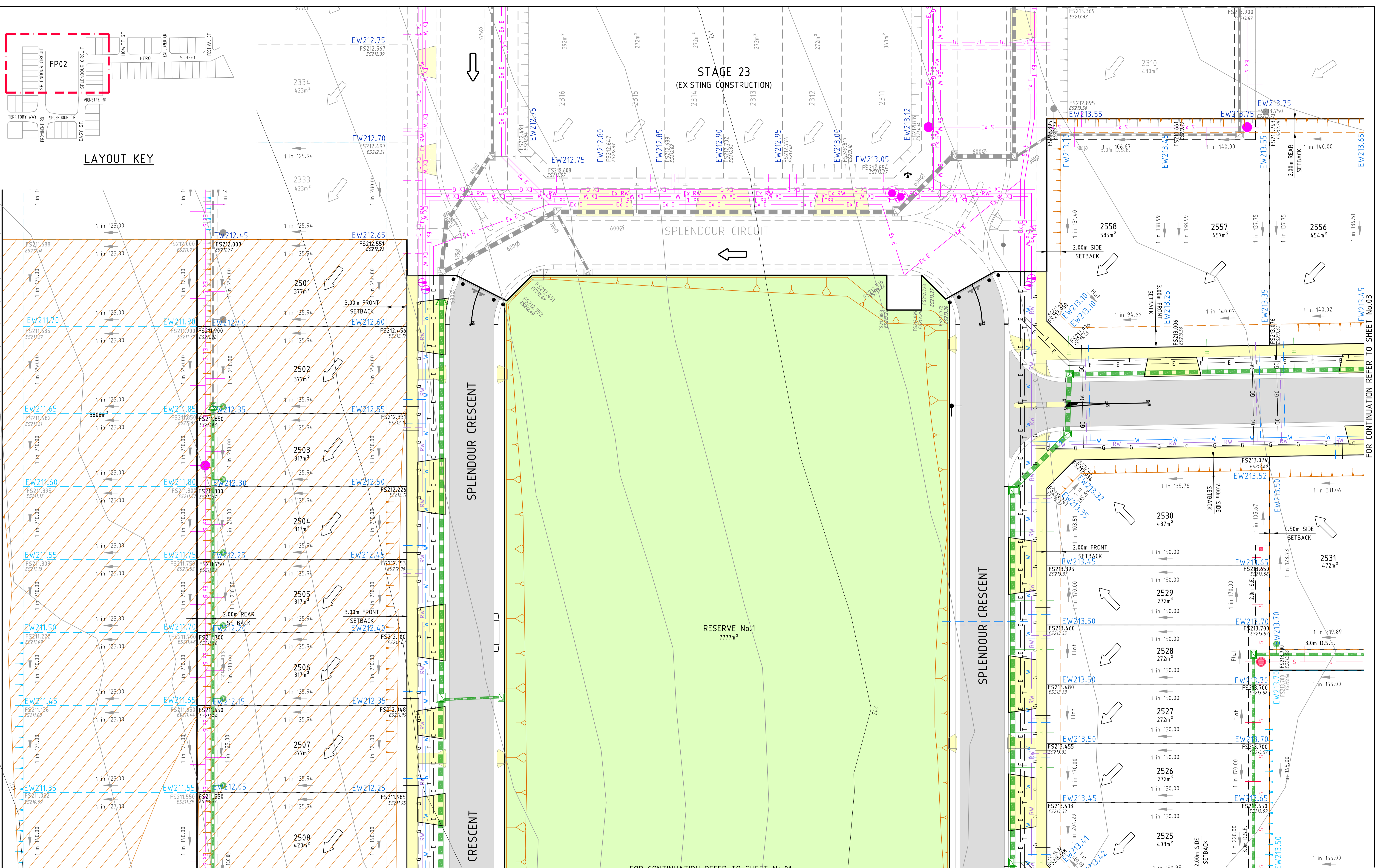

FOR CONTINUATION REFER TO SHEET No.01

FOR CONTINUATION REFER TO SHEET No.03

NOT TO BE USED FOR CONSTRUCTION

Drawn -		Date -	
AN -		Designed -	
Date -		AN -	
Verified -		Date -	
AN -		Audited -	
Date -		AN -	
Approved -		Date -	
AN -			

REV	PRELIMINARY ISSUE	AMENDMENTS	24/10/16	TL
REV			DATE	APP'D.

- Ex W - EXISTING WATER MAIN
- Ex G - EXISTING GAS MAIN
- Ex E - EXISTING ELECTRICAL CABLE
- Ex S - EXISTING SEWER MAIN & MANHOLE
- Ex T - EXISTING TELECOMM. CABLE
- Ex SD - EXISTING STORMWATER DRAIN & PIT
- Ex H - EXISTING HOUSE DRAIN
- Ex GC - EXISTING GAS CONDUIT
- Ex WC - EXISTING WATER CONDUIT
- Ex RWC - EXISTING RECYCLED WATER CONDUIT
- Ex FSL - EXISTING SURFACE LEVEL (CORNER)
- Ex FSL - FINISHED SURFACE LEVEL (CORNER)
- Ex FSL - EARTHWORKS PAD LEVEL (FUTURE)
- Ex E - EARTHWORKS PAD LEVEL

- S - SEWER MAIN AND MANHOLE
- SD - STORMWATER DRAIN & PIT
- SW - SW DRAIN & PIT CONSTRUCTED IN PREVIOUS STAGES
- H - HOUSE DRAIN
- GC - GAS CONDUIT
- WC - WATER CONDUIT
- RWC - RECYCLED WATER CONDUIT
- FS - FINISHED SURFACE LEVEL (CORNER)
- EW - EARTHWORKS PAD LEVEL
- EW - EX. EARTHWORKS PAD LEVEL

- W - WATER
- RW - RECYCLED WATER
- T - TELECOMMUNICATIONS
- E - ELECTRICITY
- G - GAS
- W - WATER CONDUIT
- DW - DW HYDRANT
- NW - NDW HYDRANT
- FS - FINISHED SURFACE LEVEL (CORNER)
- EW - EARTHWORKS PAD LEVEL
- EW - EX. EARTHWORKS PAD LEVEL

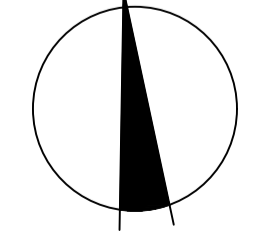

Coords: MGA
Levels: AHD

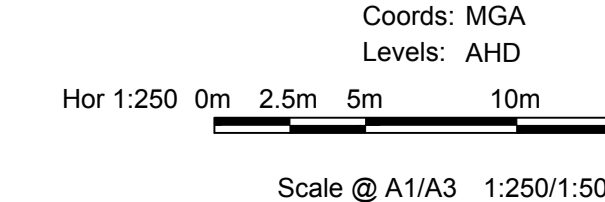

BLOOMDALE ESTATE - AREA B
STAGE 25
120 DIGGERS REST-COIMADAI ROAD, DIGGERS REST, 3427
SALES SERVICING PLAN
SHEET 02 OF 04
Drawing No. 12563.25SSP02 Rev A
 Sheet No. 02 **PRELIMINARY**
 © Dalton Consulting Engineers Pty Ltd



ABN 78 429 221 049
 QUEENSLAND
 T 61 7 3374 9000
 E info@dceng.com.au

VICTORIA
 T 61 3 9813 7400
 W dceng.com.au

Drawing File: C:\Design\12563.25SSP02 - Bloomdale Area B Stage 25\Acad\General\12563.25SSP01.dwg - 12563.25SSP02
 Date/Time: Mon Jun 19, 2017 - 2:12pm - matthew.capolino

STAGE 24
(EXISTING CONSTRUCTION)

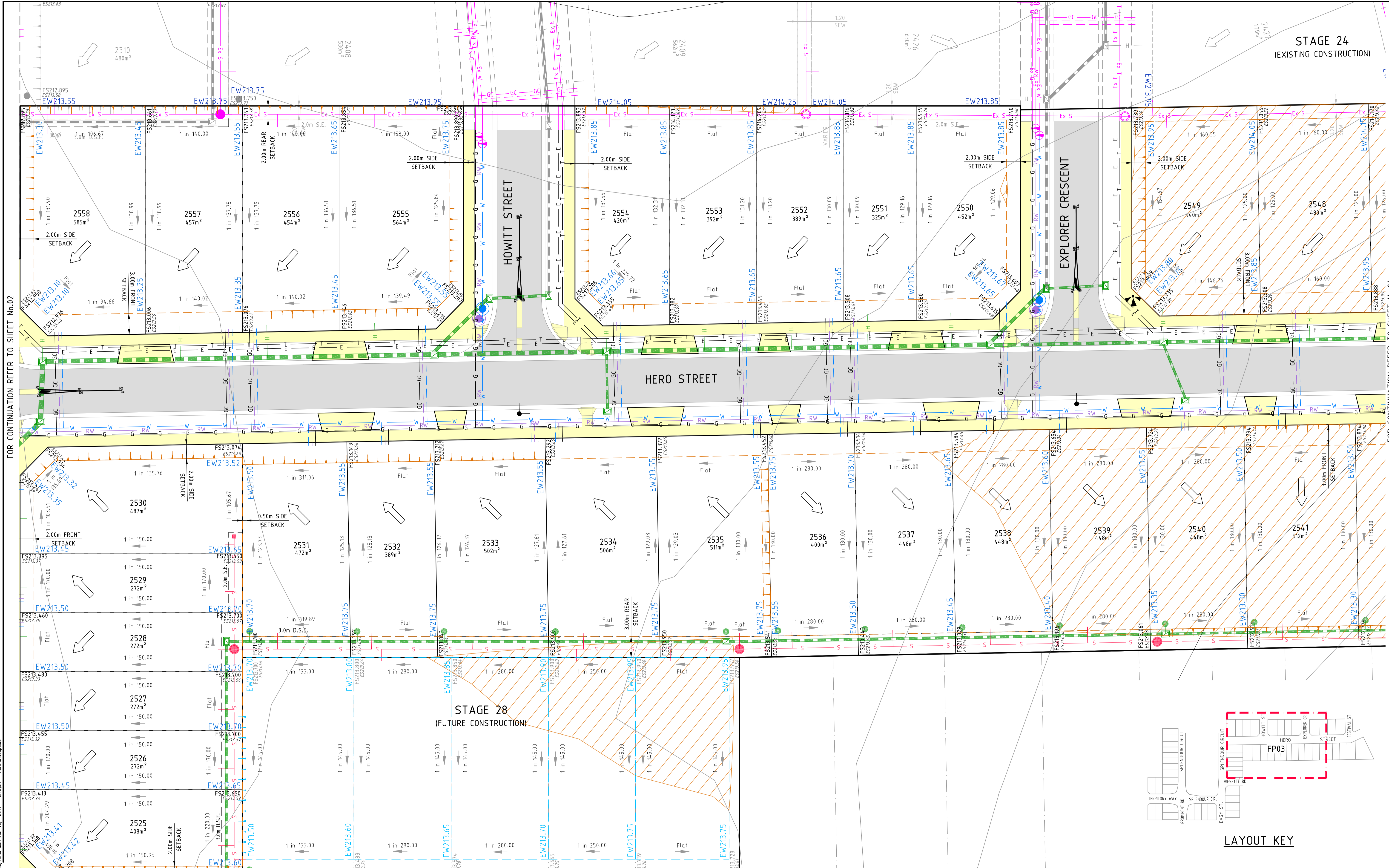

FOR CONTINUATION REFER TO SHEET No.02

FOR CONTINUATION REFER TO SHEET No.04

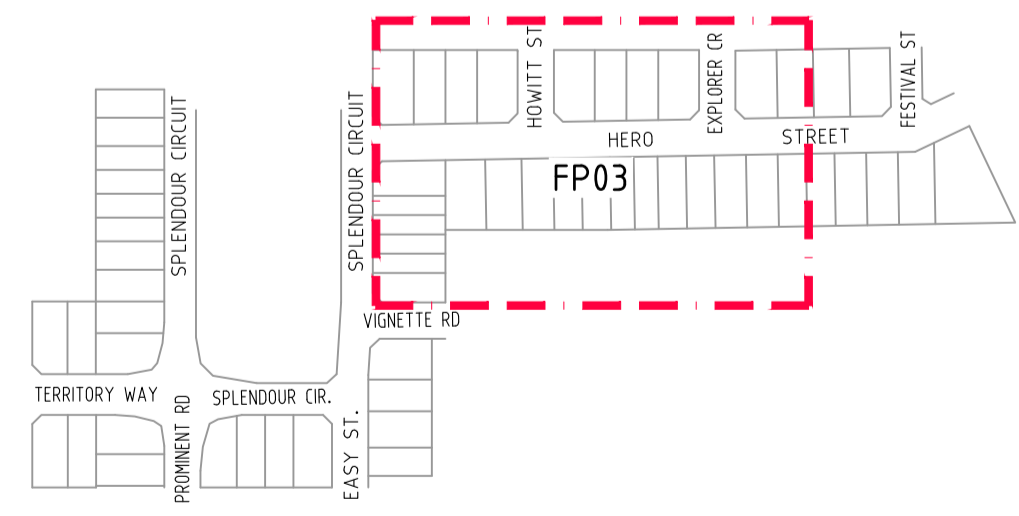

LAYOUT KEY

Drawing File: C:\Design\2500\12563.25SSP03 - Bloondale Area B Stage 24\Acad\General\12563.25SSP03.dwg - 12563.25SSP03
 Date/Time: Mon Jun 19, 2017 - 2:13pm - matthew.capolino

NOT TO BE USED FOR CONSTRUCTION

Drawn -	Date -	AN
Designed -	Date -	AN
Verified -	Date -	AN
Audited -	Date -	AN
Approved -	Date -	AN

A	PRELIMINARY ISSUE	24/10/16	TL
REV	AMENDMENTS	DATE	APP'D.

Written dimensions to take precedence over scale. Contractor shall check and verify all dimensions on site. Discrepancies to be brought to the attention of the Superintendent.

LEGEND

- EX W EXISTING WATER MAIN
- EX G EXISTING GAS MAIN
- EX E EXISTING ELECTRICAL CABLE
- EX S EXISTING SEWER MAIN & MANHOLE
- EX T EXISTING TELECOMM. CABLE
- EX ST EXISTING STORMWATER DRAIN & PIT CONSTRUCTED PRE DEVELOPMENT
- EX B BATTER (GRADE AS SPECIFIED) (SHOWN WHERE GRADES > 1 in 10)
- EX A ALLOTMENT PAD BOUNDARY
- S SEWER MAIN AND MANHOLE
- SW SW DRAIN & PIT CONSTRUCTED IN PREVIOUS STAGES
- H HOUSE DRAIN
- GC GAS CONDUIT
- W WATER CONDUIT
- RW RECYCLED WATER CONDUIT
- W WATER
- RW RECYCLED WATER
- T TELECOMMUNICATIONS
- E ELECTRICITY
- G GAS
- S STREET NAME SIGN
- DW DW HYDRANT
- NDW NDW HYDRANT
- DIRECTION OF FALL (1 IN 150 MINIMUM)
- DW DW WASHOUT
- NDW NDW WASHOUT
- FS FINISHED SURFACE LEVEL (CORNER)
- FS FINISHED SURFACE LEVEL (CORNER)
- FS EARTHWORKS PAD LEVEL (FUTURE)
- EW EARTHWORKS PAD LEVEL
- EX. EARTHWORKS PAD LEVEL

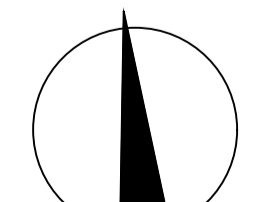

AVID
Property Group

Coords: MGA
Levels: AHD
Scale @ A1/A3 1:250/1:500

BLOONDALE ESTATE - AREA B
STAGE 25
 120 DIGGERS REST-COMADAI ROAD, DIGGERS REST, 3427
SALES SERVICING PLAN
SHEET 03 OF 04
 Drawing No. 12563.25SSP03 Rev A
 Sheet No. 03 PRELIMINARY
 © Dalton Consulting Engineers Pty Ltd

DALTON CONSULTING ENGINEERS
 ABN 78 429 221 049
 QUEENSLAND
 T 61 7 3374 9000
 E info@dceng.com.au
 VICTORIA
 T 61 3 9813 7400
 W dceng.com.au

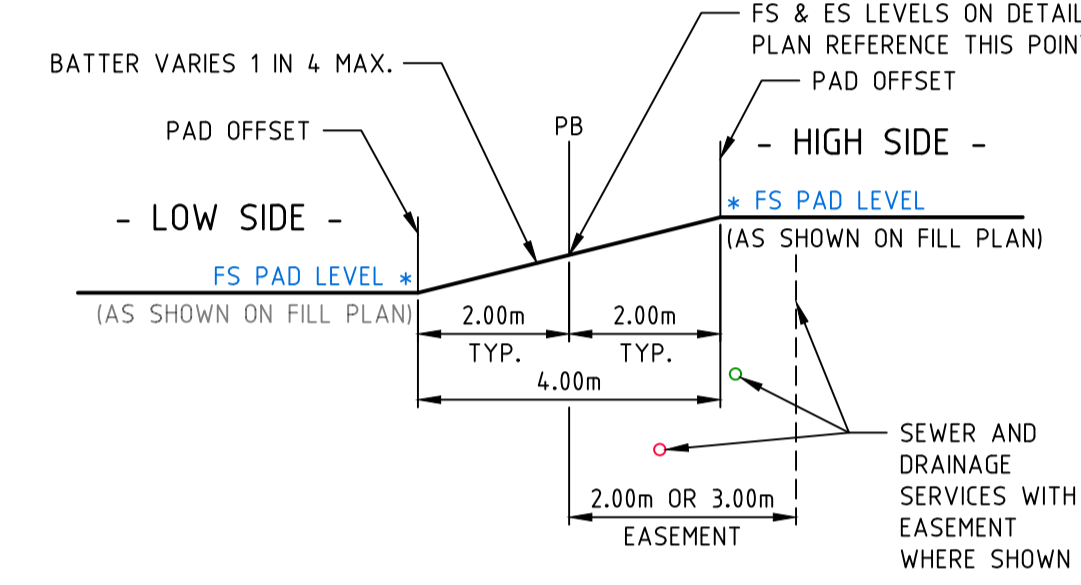
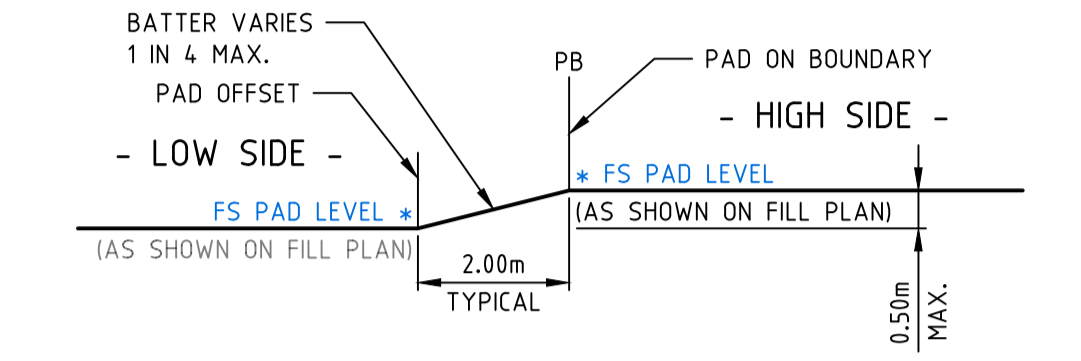
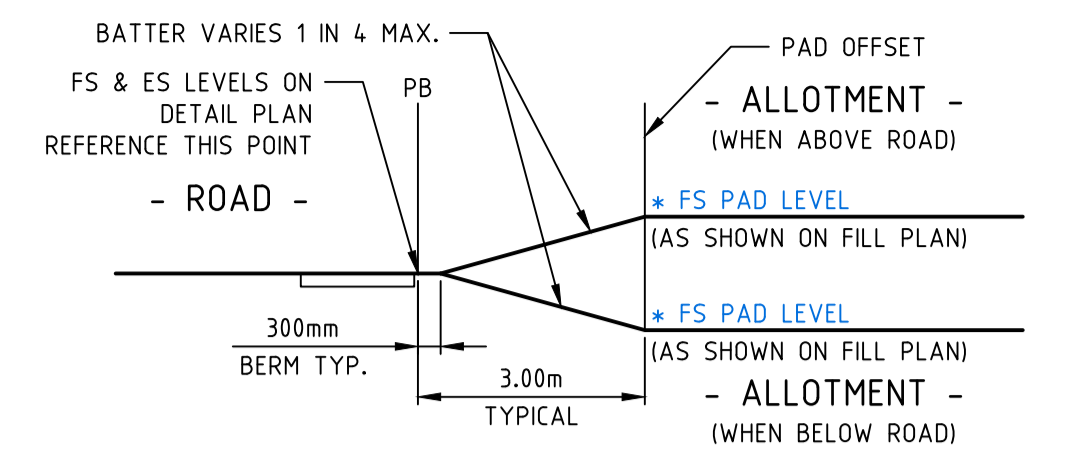
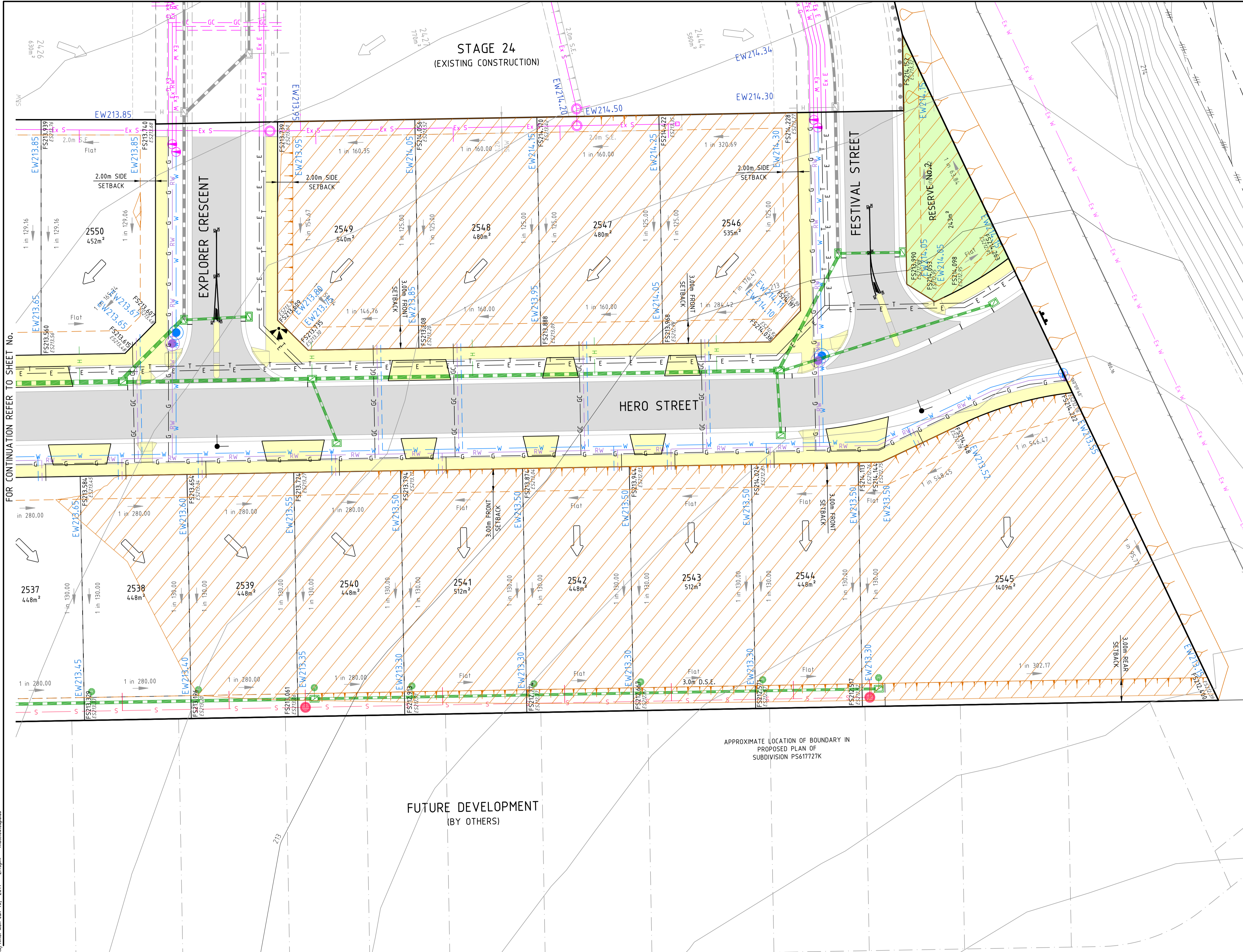

FILL NOTES:
THIS PLAN SHOWS DETAILS OF WORKS AFFECTING THE NATURAL SURFACE OF THE LAND WITHIN THE SUBDIVISION WHICH HAVE BEEN CARRIED OUT OR ARE PROPOSED TO BE CARRIED OUT PRIOR TO REGISTRATION OF THE PLAN OF SUBDIVISION, BEING FILL PLACED ON THE LAND TO THE EXTENT AND DEPTH SHOWN ON THIS PLAN.
THIS PLAN DOES NOT SHOW ANY OTHER FILL WHICH MAY HAVE BEEN PLACED ON THE LAND PRIOR TO THE CIVIL WORKS BEING UNDERTAKEN.
THIS PLAN HAS BEEN PREPARED FOR THE PURPOSE OF CONSTRUCTING SUBDIVISIONAL WORKS AND IS NOT A RECORD OF 'AS BUILT DETAILS'.
FILLING SHOWN LESS THAN 200mm DEEP IS GRADED OR SPREAD OVER ALLOTMENTS TO CORRECT MINOR SURFACE IRREGULARITIES SUCH AS FURROWS ETC AND LOT GRADING.
IRRESPECTIVE OF THE DEPTH OF FILLING FOUNDATIONS MUST BE DESIGNED AND CONSTRUCTED IN ACCORDANCE WITH A SOIL CLASSIFICATION AND REPORT PREPARED FOR THE PURPOSE AND IN ACCORDANCE WITH THE APPROPRIATE BUILDING REGULATIONS.
THE AREA MARKED THUS ON THIS PLAN INDICATES FILL DEEPER THAN 200mm PLACED ON ALLOTMENTS.
THE EXTENT OF AND DEPTH OF FILL MUST BE CONFIRMED BY A PROPER GEOTECHNICAL INVESTIGATION BY AN EXPERIENCED PRACTITIONER.

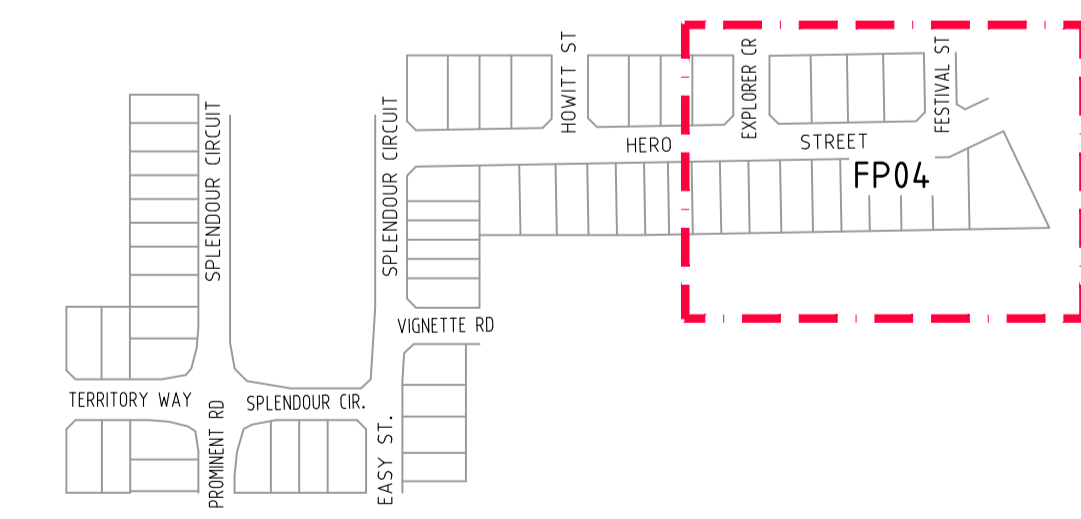

LAYOUT KEY

Drawing File: C:\Design\12563\12563-12563-Blomdale Area B Stage 25\Acad\General\12563.25SSP01.dwg - 12563.25SSP04
Date/Time: Mon Jun 19, 2017 - 2:13pm - matthew.copello

NOT TO BE USED FOR CONSTRUCTION

Drawn -	Date -	AN	Designed -	Date -	AN	Verified -	Date -	AN	Audited -	Date -	AN	Approved -	Date -	AN
A	PRELIMINARY ISSUE			24/10/16	TL									
REV	AMENDMENTS		DATE	APPD.										

Written dimensions to take precedence over scale. Contractor shall check and verify all dimensions on site. Discrepancies to be brought to the attention of the Superintendent.

LEGEND

	EXISTING WATER MAIN		WATER
	EXISTING GAS MAIN		RECYCLED WATER
	EXISTING ELECTRICAL CABLE		TELECOMMUNICATIONS
	EXISTING SEWER MAIN & MANHOLE		ELECTRICITY
	EXISTING TELECOMM. CABLE		GAS
	EXISTING SEWER MAIN & MANHOLE		STREET NAME SIGN
	EXISTING TELECOMM. CABLE		DW HYDRANT
	EXISTING STORMWATER DRAIN & PIT		NDW HYDRANT
	EXISTING TELECOMM. CABLE		DW WASHOUT
	EXISTING STORMWATER DRAIN & PIT CONSTRUCTED PRE DEVELOPMENT		NDW WASHOUT
	EXISTING STORMWATER DRAIN & PIT CONSTRUCTED PRE DEVELOPMENT BATTER (GRADE AS SPECIFIED) (SHOWN WHERE GRADES > 1 in 10)		DIRECTION OF FALL (1 IN 150 MINIMUM)
	EXISTING STORMWATER DRAIN & PIT CONSTRUCTED PRE DEVELOPMENT BATTER (GRADE AS SPECIFIED) (SHOWN WHERE GRADES > 1 in 10) ALLOTMENT PAD BOUNDARY		EXISTING SURFACE LEVEL (CORNER)
			FINISHED SURFACE LEVEL (CORNER)
			EARTHWORKS PAD LEVEL (FUTURE)
			EARTHWORKS PAD LEVEL (EX. EARTHWORKS PAD LEVEL)

AVID Property Group

Coords: MGA
Levels: AHD

Scale @ A1/A3 1:250/1:500

BLOOMDALE ESTATE - AREA B
STAGE 25
120 DIGGERS REST-COIMADAI ROAD, DIGGERS REST, 3427
SALES SERVICING PLAN
SHEET 04 OF 04
Drawing No. 12563.25SSP04 Rev A
Sheet No. 04 PRELIMINARY
© Dalton Consulting Engineers Pty Ltd

DALTON CONSULTING ENGINEERS
ABN 78 429 221 049
QUEENSLAND
T 61 7 3374 9000
E info@dceng.com.au

VICTORIA
T 61 3 9813 7400
W dceng.com.au