

TYPICAL EARTHWORKS BATTER TREATMENT
(LOT FRONTAGE TO ROAD - INCLUDING SECONDARY/SIDE FRONTAGE TO ROAD)
SCALE: N.T.S.

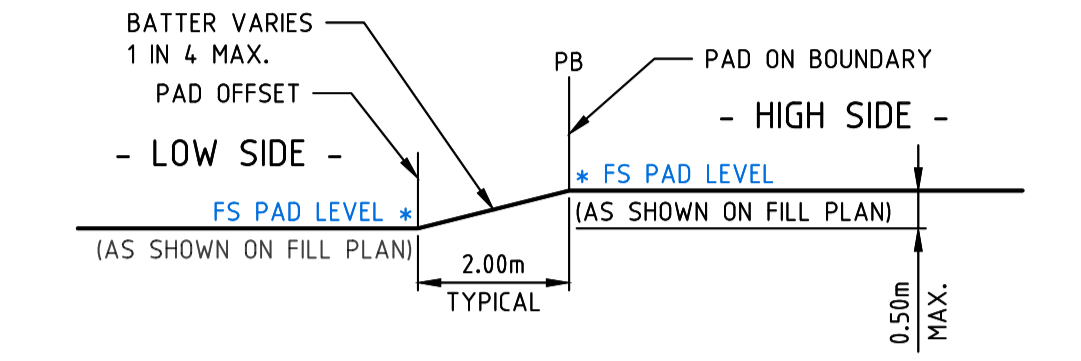

TYPICAL EARTHWORKS BATTER TREATMENT
(BETWEEN LOTS - SIDE BOUNDARY - NON DRIVEWAY SIDE)
SCALE: N.T.S.

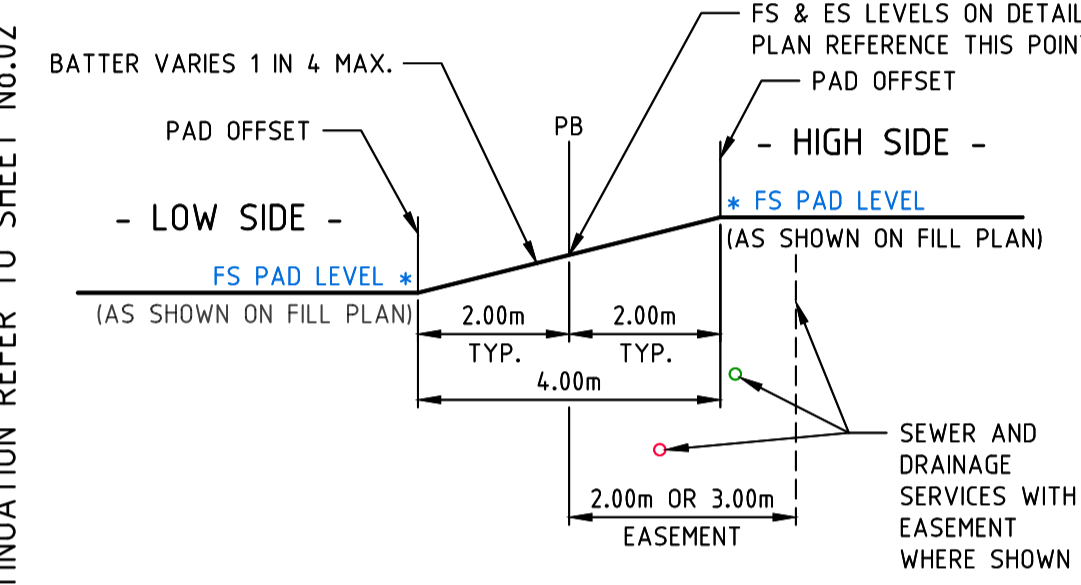

TYPICAL EARTHWORKS BATTER TREATMENT
(BETWEEN LOTS - ADJOINING REAR BOUNDARIES)
SCALE: N.T.S.

FILL NOTES:
THIS PLAN SHOWS DETAILS OF WORKS AFFECTING THE NATURAL SURFACE OF THE LAND WITHIN THE SUBDIVISION WHICH HAVE BEEN CARRIED OUT OR ARE PROPOSED TO BE CARRIED OUT PRIOR TO REGISTRATION OF THE PLAN OF SUBDIVISION, BEING FILL PLACED ON THE LAND TO THE EXTENT AND DEPTH SHOWN ON THIS PLAN.

THIS PLAN DOES NOT SHOW ANY OTHER FILL WHICH MAY HAVE BEEN PLACED ON THE LAND PRIOR TO THE CIVIL WORKS BEING UNDERTAKEN.

THIS PLAN HAS BEEN PREPARED FOR THE PURPOSE OF CONSTRUCTING SUBDIVISIONAL WORKS AND IS NOT A RECORD OF 'AS BUILT DETAILS'.

FILLING SHOWN LESS THAN 200mm DEEP IS GRADED OR SPREAD OVER ALLOTMENTS TO CORRECT MINOR SURFACE IRREGULARITIES SUCH AS FURROWS ETC AND LOT GRADING.

IRRESPECTIVE OF THE DEPTH OF FILLING FOUNDATIONS MUST BE DESIGNED AND CONSTRUCTED IN ACCORDANCE WITH A SOIL CLASSIFICATION AND REPORT PREPARED FOR THE PURPOSE AND IN ACCORDANCE WITH THE APPROPRIATE BUILDING REGULATIONS.

THE AREA MARKED WITH ON THIS PLAN INDICATES FILL DEEPER THAN 200mm PLACED ON ALLOTMENTS.

THE EXTENT OF AND DEPTH OF FILL MUST BE CONFIRMED BY A PROPER GEOTECHNICAL INVESTIGATION BY AN EXPERIENCED PRACTITIONER.

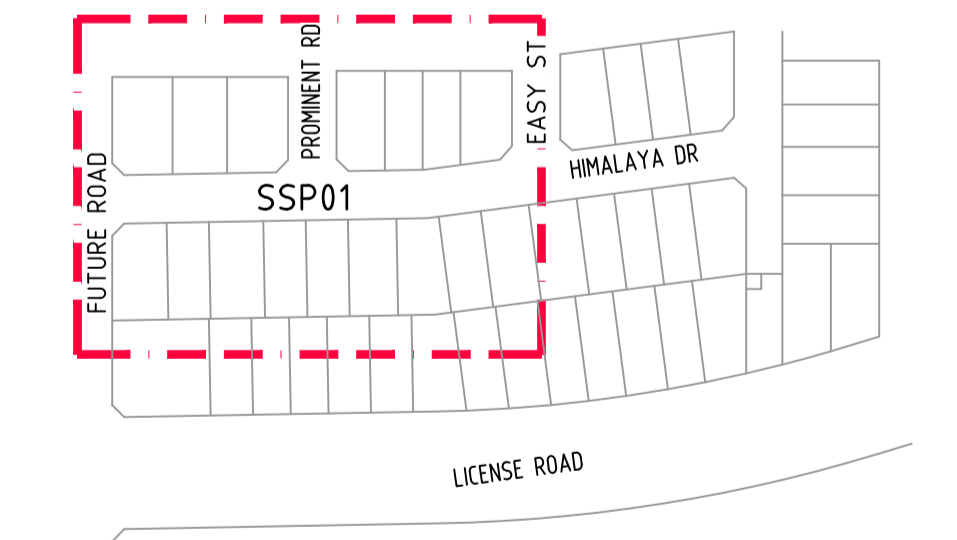

LAYOUT KEY

FOR CONTINUATION REFER TO SHEET No.03

Drawing File: C:\Design\12563.27SSP01 - Bloomdale Area B Stage 27\Acad\General\12563.27SSP01.dwg - 12563.27SSP01.dwg
Date/Time: Wed Jul 12, 2017 - 9:10:00am - matthew.copridge

NOT TO BE USED FOR CONSTRUCTION

Drawn -
Date -
AN -
Designed -
Date -
AN 1871601
Verified -
Date -
AN
Audited -
Date -
AN
Approved -
Date -
AN

A	PRELIMINARY ISSUE	19/06/17	TL
REV	AMENDMENTS	DATE	APP'D.

Written dimensions to take precedence over scale. Contractor shall check and verify all dimensions on site. Discrepancies to be brought to the attention of the Superintendent.

- LEGEND**
- EXISTING WATER MAIN
 - EXISTING GAS MAIN
 - EXISTING ELECTRICAL CABLE
 - EXISTING SEWER MAIN & MANHOLE
 - EXISTING TELECOMM. CABLE
 - EXISTING STORMWATER DRAIN & PIT
 - EXISTING STORMWATER DRAIN & PIT CONSTRUCTED PRE DEVELOPMENT
 - BATTER (GRADE AS SPECIFIED) (SHOWN WHERE GRADES > 1 IN 10)
 - ALLOTMENT PAD BOUNDARY
 - WATER
 - RECYCLED WATER
 - TELECOMMUNICATIONS
 - ELECTRICITY
 - GAS
 - STREET NAME SIGN
 - DW HYDRANT
 - NDW HYDRANT
 - DIRECTION OF FALL (1 IN 150 MINIMUM)
 - DW WASHOUT
 - NDW WASHOUT
 - EXISTING SURFACE LEVEL (CORNER)
 - FINISHED SURFACE LEVEL (CORNER)
 - EARTHWORKS PAD LEVEL (FUTURE)
 - EARTHWORKS PAD LEVEL
 - EX. EARTHWORKS PAD LEVEL



Coords: MGA
Levels: AHD
Scale @ A1/A3 1:250/1:500

BLOOMDALE ESTATE
STAGE 27
120 DIGGERS REST - COIMDAI ROAD, DIGGERS REST, 3427
SALES SERVICING PLAN
SHEET 01 OF 04
Drawing No. 12563.27SSP01 Rev A
Sheet No. 01 PRELIMINARY
© Dalton Consulting Engineers Pty Ltd



ABN 78 429 221 049
QUEENSLAND
T 61 7 3374 9000
E info@dceng.com.au

VICTORIA
T 61 3 9813 7400
W dceng.com.au

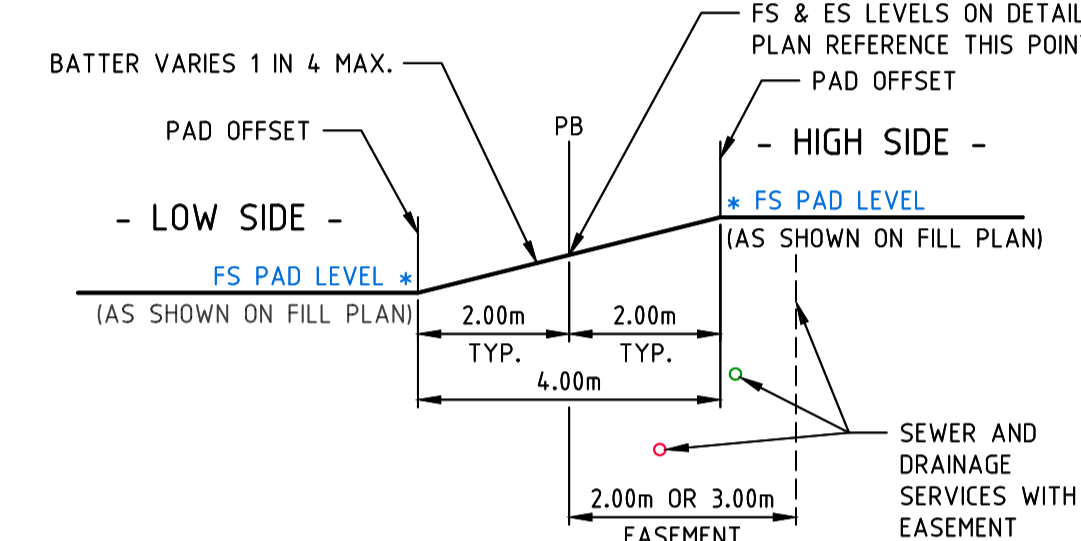
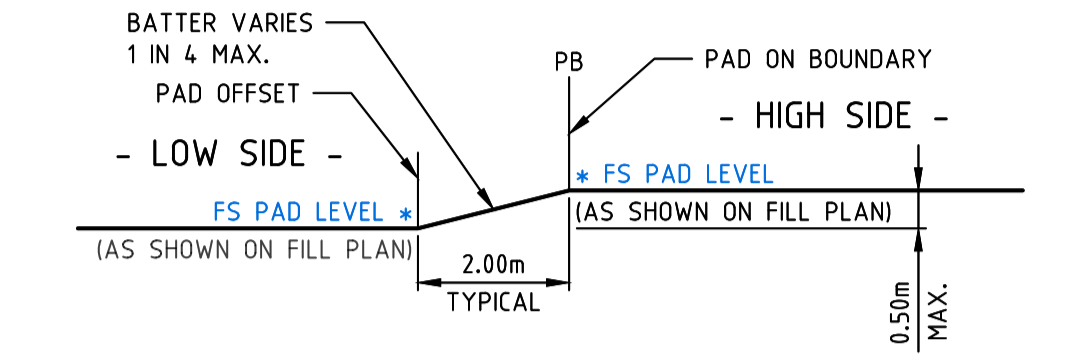
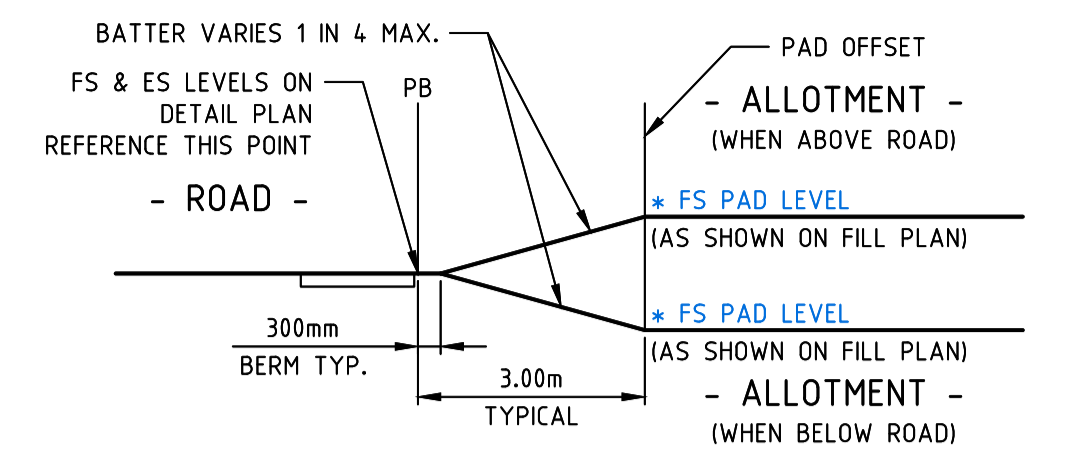
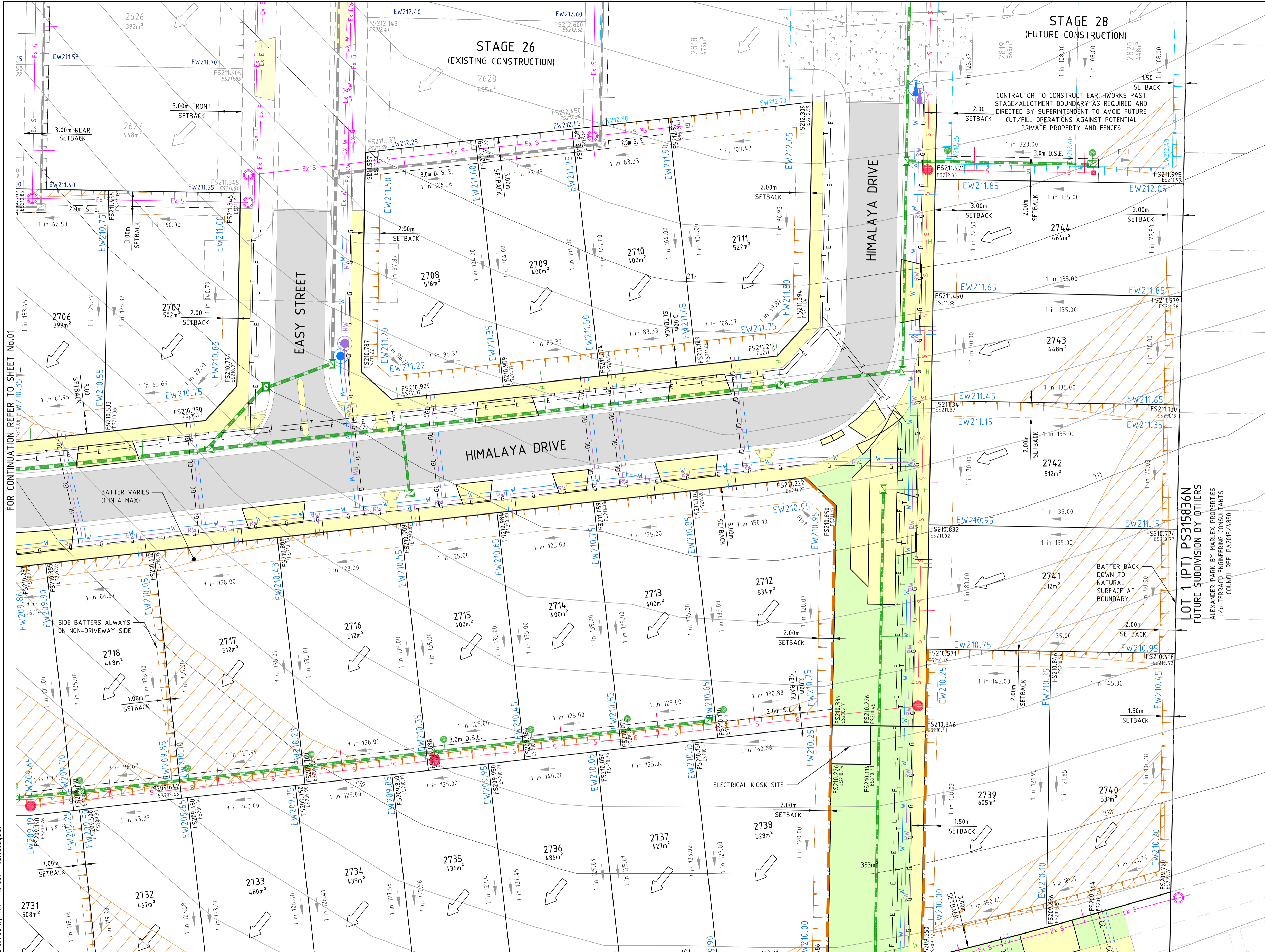

FILL NOTES:

THIS PLAN SHOWS DETAILS OF WORKS AFFECTING THE NATURAL SURFACE OF THE LAND WITHIN THE SUBDIVISION WHICH HAVE BEEN CARRIED OUT OR ARE PROPOSED TO BE CARRIED OUT PRIOR TO REGISTRATION OF THE PLAN OF SUBDIVISION, BEING FILL PLACED ON THE LAND TO THE EXTENT AND DEPTH SHOWN ON THIS PLAN.

THIS PLAN DOES NOT SHOW ANY OTHER FILL WHICH MAY HAVE BEEN PLACED ON THE LAND PRIOR TO THE CIVIL WORKS BEING UNDERTAKEN.

THIS PLAN HAS BEEN PREPARED FOR THE PURPOSE OF CONSTRUCTING SUBDIVISIONAL WORKS AND IS NOT A RECORD OF 'AS BUILT DETAILS'.

FILLING SHOWN LESS THAN 200mm DEEP IS GRADED OR SPREAD OVER ALLOTMENTS TO CORRECT MINOR SURFACE IRREGULARITIES SUCH AS FURROWS ETC AND LOT GRADING.

IRRESPECTIVE OF THE DEPTH OF FILLING FOUNDATIONS MUST BE DESIGNED AND CONSTRUCTED IN ACCORDANCE WITH A SOIL CLASSIFICATION AND REPORT PREPARED FOR THE PURPOSE AND IN ACCORDANCE WITH THE APPROPRIATE BUILDING REGULATIONS.

THE AREA MARKED WITH ON THIS PLAN INDICATES FILL DEEPER THAN 200mm PLACED ON ALLOTMENTS.

THE EXTENT OF AND DEPTH OF FILL MUST BE CONFIRMED BY A PROPER GEOTECHNICAL INVESTIGATION BY AN EXPERIENCED PRACTITIONER.

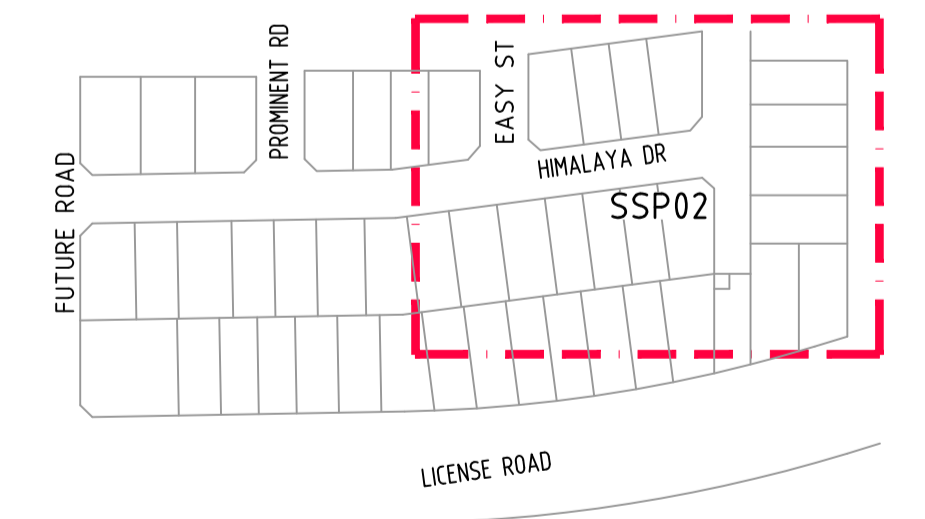

NOT TO BE USED FOR CONSTRUCTION

Drawn -	AN	Date -	19/06/17	TL
Designed -	AN	Date -	18/10/16	
Verified -	AN	Date -		
Audited -	AN	Date -		
Approved -	AN	Date -		
REV	AMENDMENTS	DATE	APP'D.	

Written dimensions to take precedence over scale. Contractor shall check and verify all dimensions on site. Discrepancies to be brought to the attention of the Superintendent.

LEGEND

	EXISTING WATER MAIN		WATER
	EXISTING GAS MAIN		RECYCLED WATER
	EXISTING ELECTRICAL CABLE		TELECOMMUNICATIONS
	EXISTING SEWER MAIN & MANHOLE		ELECTRICITY
	EXISTING TELECOMM. CABLE		GAS
	EXISTING STORMWATER DRAIN & PIT		STREET NAME SIGN
	EXISTING STORMWATER DRAIN & PIT CONSTRUCTED PRE DEVELOPMENT (BATTER (GRADE AS SPECIFIED) (SHOWN WHERE GRADES > 1 IN 10))		DW HYDRANT
	ALLOTMENT PAD BOUNDARY		NDW HYDRANT
			DIRECTION OF FALL (1 IN 150 MINIMUM)
			DW WASHOUT
			NDW WASHOUT

LEGEND

	SEWER MAIN AND MANHOLE		WATER
	STORMWATER DRAIN & PIT		RECYCLED WATER
	SW DRAIN & PIT CONSTRUCTED IN PREVIOUS STAGES		TELECOMMUNICATIONS
	EXISTING HOUSE DRAIN		ELECTRICITY
	GAS CONDUIT		GAS
	WATER CONDUIT		STREET NAME SIGN
	RECYCLED WATER CONDUIT		DW HYDRANT
	EXISTING SURFACE LEVEL (CORNER)		NDW HYDRANT
	FINISHED SURFACE LEVEL (CORNER)		DIRECTION OF FALL (1 IN 150 MINIMUM)
	EARTHWORKS PAD LEVEL (FUTURE)		DW WASHOUT
	EARTHWORKS PAD LEVEL		NDW WASHOUT
	EX. EARTHWORKS PAD LEVEL		

AVID Property Group

Coords: MGA
Levels: AHD

Scale @ A1/A3 1:250/1:500

BLOOMDALE ESTATE

STAGE 27
120 DIGGERS REST - COIMDAI ROAD, DIGGERS REST, 3427

SALES SERVICING PLAN

SHEET 02 OF 04

Drawing No. 12563.27SSP02 Rev A

Sheet No. 02 PRELIMINARY

© Dalton Consulting Engineers Pty Ltd

DALTON CONSULTING ENGINEERS

ABN 78 429 221 049

QUEENSLAND
T 61 3 7374 9000
E info@dceng.com.au

VICTORIA
T 61 3 9813 7400
W dceng.com.au

FOR CONTINUATION REFER TO SHEET No.01

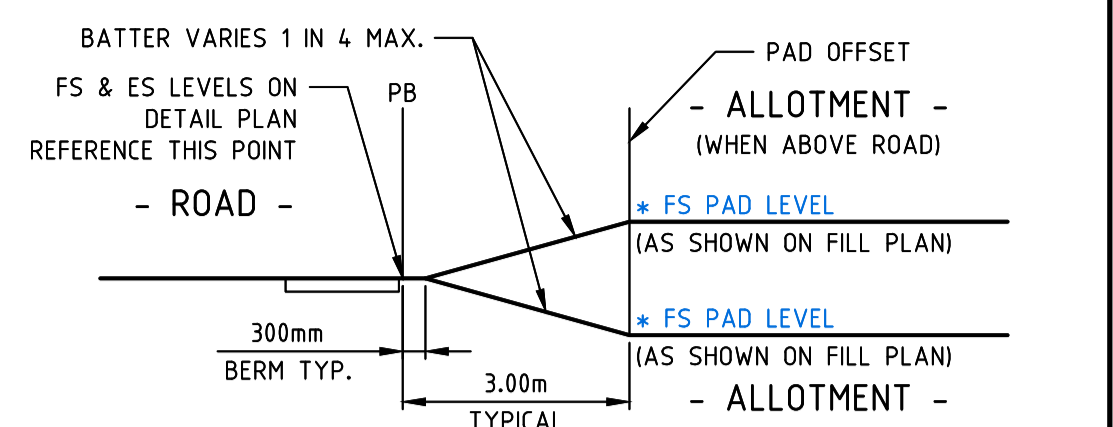
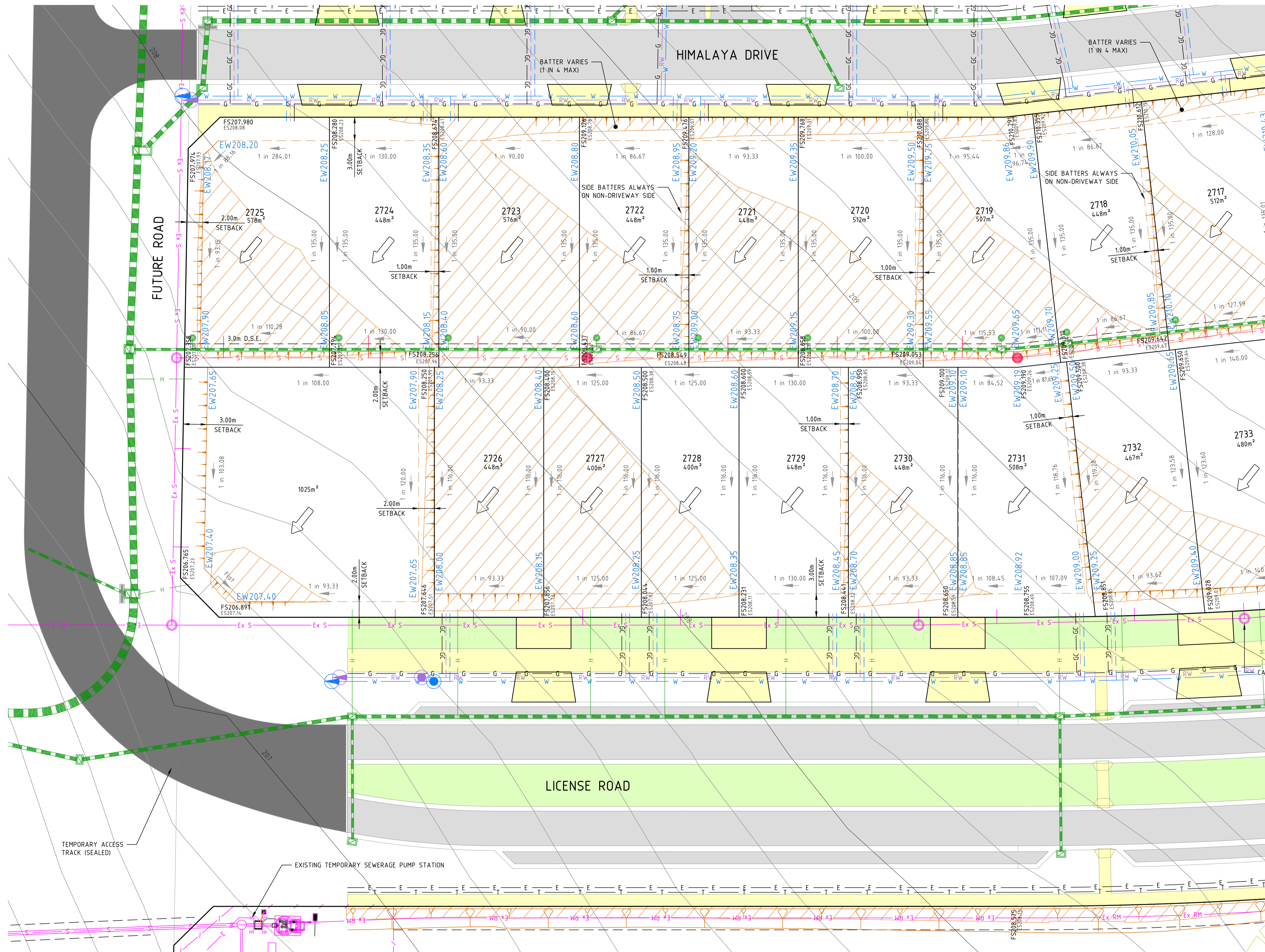

TYPICAL EARTHWORKS BATTER TREATMENT
(LOT FRONTAGE TO ROAD - INCLUDING SECONDARY/SIDE FRONTAGE TO ROAD)
SCALE: N.T.S.

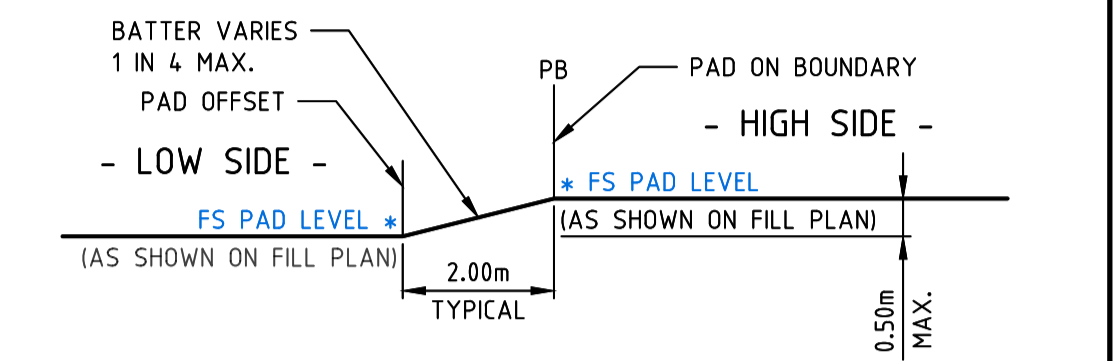

TYPICAL EARTHWORKS BATTER TREATMENT
(BETWEEN LOTS - SIDE BOUNDARY - NON DRIVEWAY SIDE)
SCALE: N.T.S.

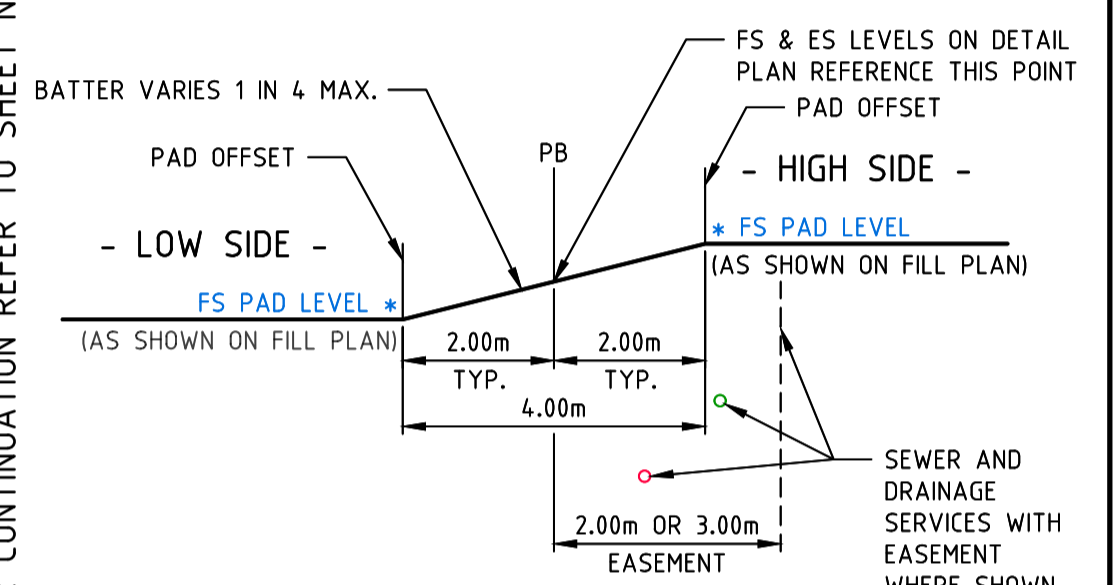

TYPICAL EARTHWORKS BATTER TREATMENT
(BETWEEN LOTS - ADJOINING REAR BOUNDARIES)
SCALE: N.T.S.

FILL NOTES:

THIS PLAN SHOWS DETAILS OF WORKS AFFECTING THE NATURAL SURFACE OF THE LAND WITHIN THE SUBDIVISION WHICH HAVE BEEN CARRIED OUT OR ARE PROPOSED TO BE CARRIED OUT PRIOR TO REGISTRATION OF THE PLAN OF SUBDIVISION, BEING FILL PLACED ON THE LAND TO THE EXTENT AND DEPTH SHOWN ON THIS PLAN.

THIS PLAN DOES NOT SHOW ANY OTHER FILL WHICH MAY HAVE BEEN PLACED ON THE LAND PRIOR TO THE CIVIL WORKS BEING UNDERTAKEN.

THIS PLAN HAS BEEN PREPARED FOR THE PURPOSE OF CONSTRUCTING SUBDIVISIONAL WORKS AND IS NOT A RECORD OF 'AS BUILT' DETAILS.

FILLING SHOWN LESS THAN 200mm DEEP IS GRADED OR SPREAD OVER ALLOTMENTS TO CORRECT MINOR SURFACE IRREGULARITIES SUCH AS FURROWS ETC AND LOT GRADING.

IRRESPECTIVE OF THE DEPTH OF FILL FOUNDATIONS MUST BE DESIGNED AND CONSTRUCTED IN ACCORDANCE WITH A SOIL CLASSIFICATION AND REPORT PREPARED FOR THE PURPOSE AND IN ACCORDANCE WITH THE APPROPRIATE BUILDING REGULATIONS.

THE AREA MARKED THUS  ON THIS PLAN INDICATES FILL DEEPER THAN 200mm PLACED ON ALLOTMENTS.

THE EXTENT OF AND DEPTH OF FILL MUST BE CONFIRMED BY A PROPER GEOTECHNICAL INVESTIGATION BY AN EXPERIENCED PRACTITIONER.

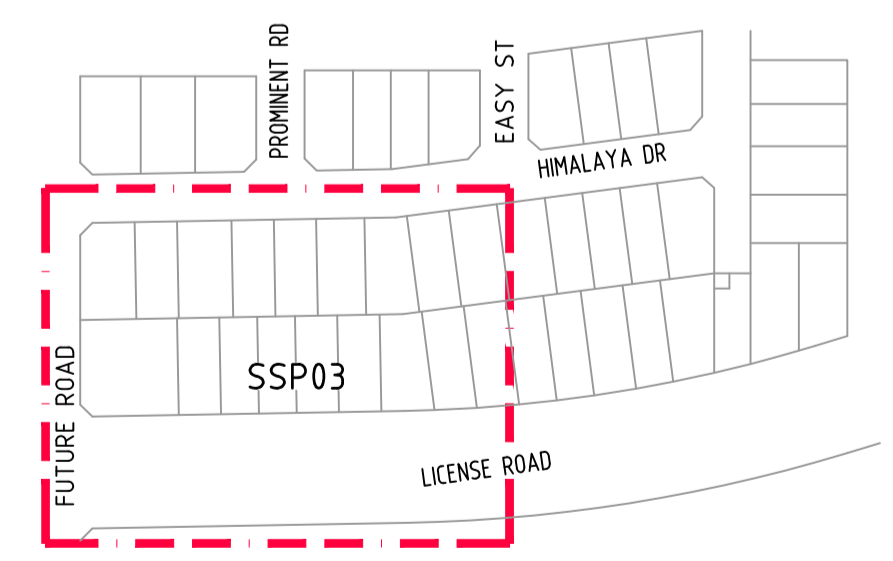

LAYOUT KEY

Drawing File: C:\Design\2563\12563\27-Bloomdale Area B Stage 27\Acad\General\12563.27SSP03.dwg - 12563.27SSP03 Date/Time: Wed Jul 12, 2017 - 9:10am -matthew.copridge-

NOT TO BE USED FOR CONSTRUCTION		Drawn - AN	Date - 19/06/17	TL
		Designed - AN	Date - 19/06/17	TL
		Verified - AN	Date - 19/06/17	TL
		Audited - AN	Date - 19/06/17	TL
		Approved - AN	Date - 19/06/17	TL
REV	AMENDMENTS	DATE	APP'D.	
A	PRELIMINARY ISSUE	19/06/17	TL	

LEGEND

- Ex W - EXISTING WATER MAIN
- Ex G - EXISTING GAS MAIN
- Ex E - EXISTING ELECTRICAL CABLE
- Ex S - EXISTING SEWER MAIN & MANHOLE
- Ex T - EXISTING TELECOMM. CABLE
- Ex H - EXISTING HOUSE DRAIN
- Ex SD - EXISTING STORMWATER DRAIN & PIT
- Ex C - EXISTING CONSTRUCTED PRE DEVELOPMENT
- Ex B - EXISTING BATTER (GRADE AS SPECIFIED)
- Ex A - EXISTING ALLOTMENT PAD BOUNDARY
- S - SEWER MAIN AND MANHOLE
- SD - STORMWATER DRAIN & PIT
- H - HOUSE DRAIN
- GC - GAS CONDUIT
- WC - WATER CONDUIT
- RC - RECYCLED WATER CONDUIT
- ES - EXISTING SURFACE LEVEL (CORNER)
- FS - FINISHED SURFACE LEVEL (CORNER)
- EW - EARTHWORKS PAD LEVEL (FUTURE)
- EW - EARTHWORKS PAD LEVEL
- EW - EX. EARTHWORKS PAD LEVEL
- W - WATER
- RW - RECYCLED WATER
- T - TELECOMMUNICATIONS
- E - ELECTRICITY
- G - GAS
- SN - STREET NAME SIGN
- DW - DW HYDRANT
- NW - NDW HYDRANT
- D - DIRECTION OF FALL (1 IN 150 MINIMUM)
- DW - DW WASHOUT
- NW - NDW WASHOUT

AVID
Property Group

Coords: MGA
Levels: AHD

Scale @ A1/A3 1:250/1:500

BLOOMDALE ESTATE
STAGE 27
120 DIGGERS REST - COIMDAI ROAD, DIGGERS REST, 3427
SALES SERVICING PLAN
SHEET 03 OF 04
Drawing No. 12563.27SSP03 Rev A
Sheet No. 03 PRELIMINARY
© Dalton Consulting Engineers Pty Ltd

DALTON CONSULTING ENGINEERS
ABN 78 429 221 049
QUEENSLAND
T 61 7 3374 9000
E info@dceng.com.au

VICTORIA
T 61 3 9813 7400
W dceng.com.au

FOR CONTINUATION REFER TO SHEET No.02

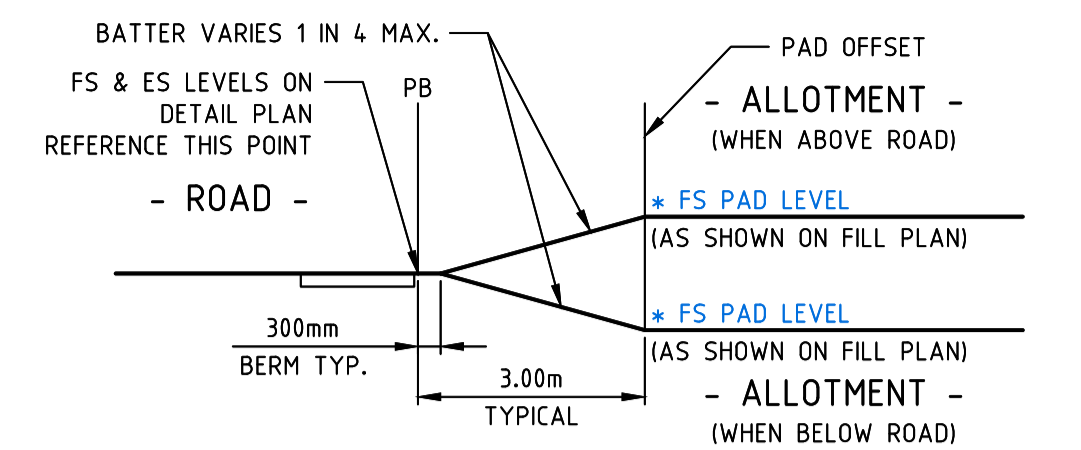
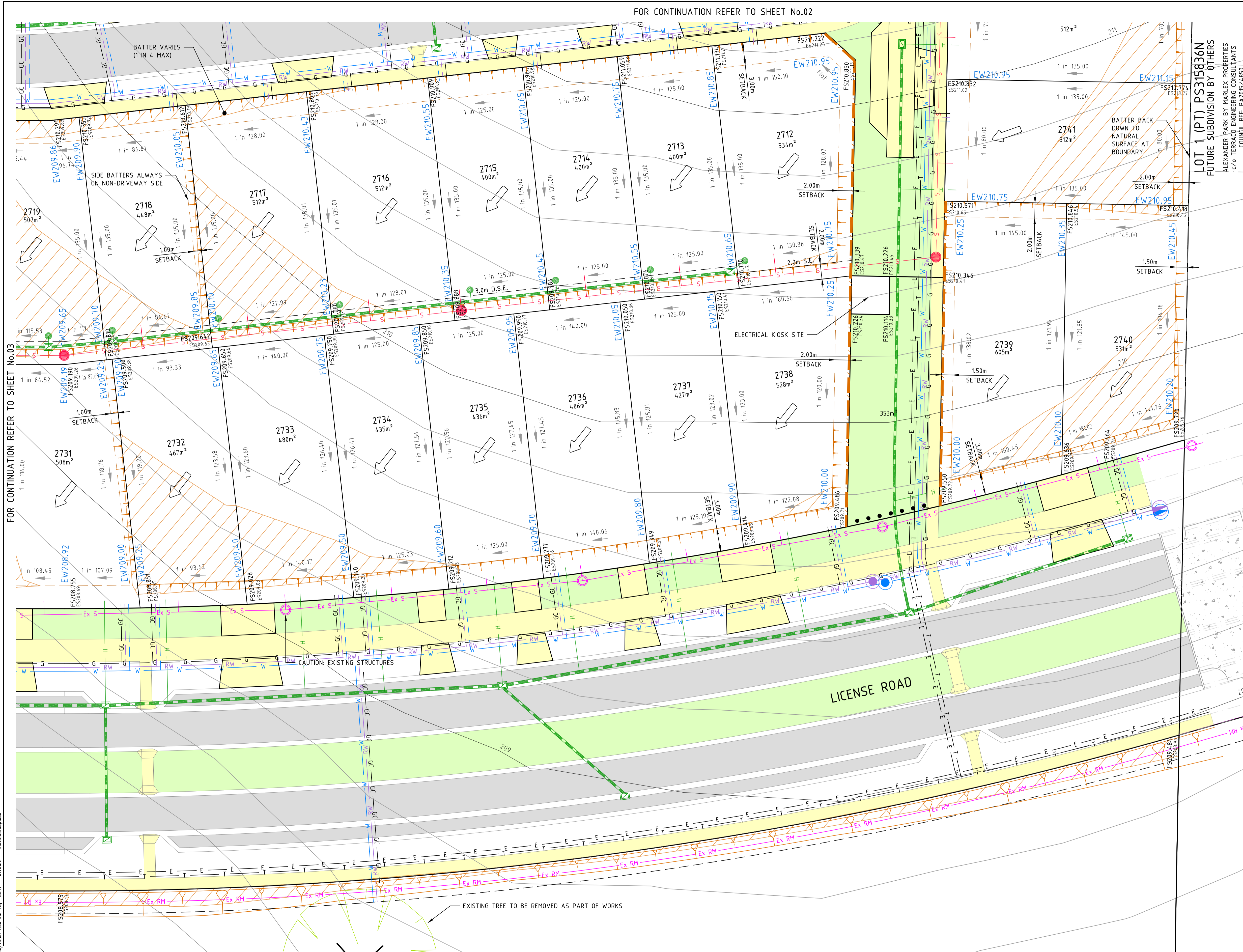

TYPICAL EARTHWORKS BATTER TREATMENT
(LOT FRONTAGE TO ROAD - INCLUDING SECONDARY/SIDE FRONTAGE TO ROAD)
SCALE: N.T.S.

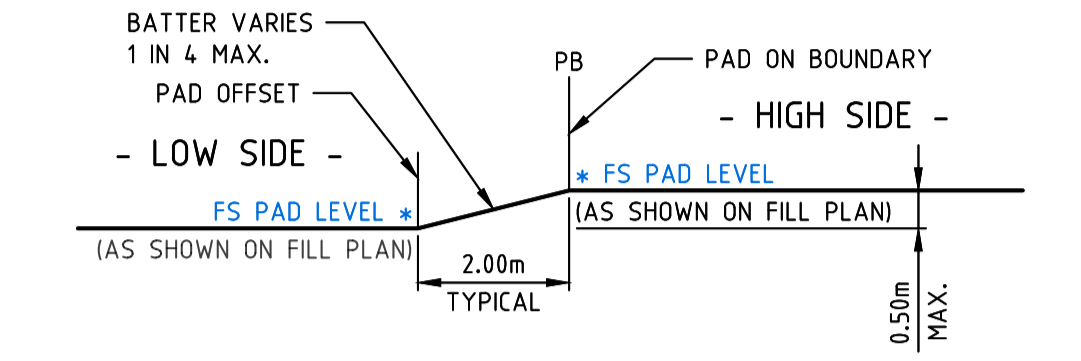

TYPICAL EARTHWORKS BATTER TREATMENT
(BETWEEN LOTS - SIDE BOUNDARY - NON DRIVEWAY SIDE)
SCALE: N.T.S.

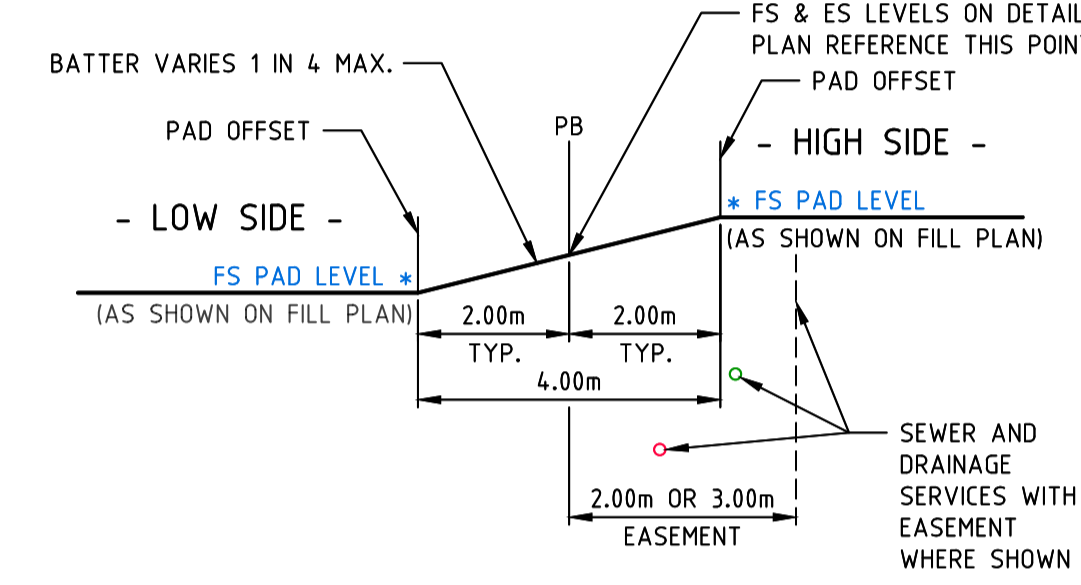

TYPICAL EARTHWORKS BATTER TREATMENT
(BETWEEN LOTS - ADJOINING REAR BOUNDARIES)
SCALE: N.T.S.

FILL NOTES:
THIS PLAN SHOWS DETAILS OF WORKS AFFECTING THE NATURAL SURFACE OF THE LAND WITHIN THE SUBDIVISION WHICH HAVE BEEN CARRIED OUT OR ARE PROPOSED TO BE CARRIED OUT PRIOR TO REGISTRATION OF THE PLAN OF SUBDIVISION, BEING FILL PLACED ON THE LAND TO THE EXTENT AND DEPTH SHOWN ON THIS PLAN.

THIS PLAN DOES NOT SHOW ANY OTHER FILL WHICH MAY HAVE BEEN PLACED ON THE LAND PRIOR TO THE CIVIL WORKS BEING UNDERTAKEN.

THIS PLAN HAS BEEN PREPARED FOR THE PURPOSE OF CONSTRUCTING SUBDIVISIONAL WORKS AND IS NOT A RECORD OF 'AS BUILT DETAILS'.

FILLING SHOWN LESS THAN 200mm DEEP IS GRADED OR SPREAD OVER ALLOTMENTS TO CORRECT MINOR SURFACE IRREGULARITIES SUCH AS FURROWS ETC AND LOT GRADING.

IRRESPECTIVE OF THE DEPTH OF FILLING FOUNDATIONS MUST BE DESIGNED AND CONSTRUCTED IN ACCORDANCE WITH A SOIL CLASSIFICATION AND REPORT PREPARED FOR THE PURPOSE AND IN ACCORDANCE WITH THE APPROPRIATE BUILDING REGULATIONS.

THE AREA MARKED WITH HATCHING ON THIS PLAN INDICATES FILL DEEPER THAN 200mm PLACED ON ALLOTMENTS.

THE EXTENT OF AND DEPTH OF FILL MUST BE CONFIRMED BY A PROPER GEOTECHNICAL INVESTIGATION BY AN EXPERIENCED PRACTITIONER.

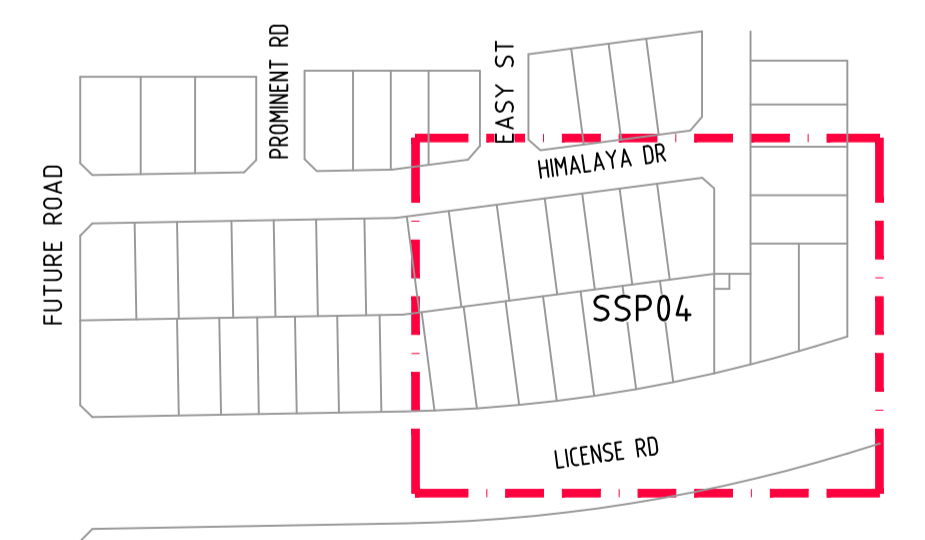

LAYOUT KEY

Drawing File: C:\Design\12563.27SSP04 - Bloomdale Area B Stage 2\Acad\General\12563.27SSP04.dwg - 12563.27SSP04
Date/Time: Wed Jul 12, 2017 - 9:10:00am - matthew.copridge

NOT TO BE USED FOR CONSTRUCTION

Drawn -			
Date -			
AN -			
Designed -			
Date -			
AN 1871604			
Verified -			
Date -			
AN			
Audited -			
Date -			
AN			
Approved -			
Date -			
AN			

A	PRELIMINARY ISSUE	19/06/17	TL
REV	AMENDMENTS	DATE	APP'D.

Written dimensions to take precedence over scale. Contractor shall check and verify all dimensions on site. Discrepancies to be brought to the attention of the Superintendent.

LEGEND

- Ex W - EXISTING WATER MAIN
- Ex G - EXISTING GAS MAIN
- Ex E - EXISTING ELECTRICAL CABLE
- Ex S - EXISTING SEWER MAIN & MANHOLE
- Ex T - EXISTING TELECOMM. CABLE
- Ex SD - EXISTING STORMWATER DRAIN & PIT
- Ex RM - EXISTING STORMWATER DRAIN & PIT CONSTRUCTED PRE DEVELOPMENT
- Ex RM - EXISTING STORMWATER DRAIN & PIT CONSTRUCTED PRE DEVELOPMENT (SHOWN WHERE GRADES > 1 in 10)
- Ex RM - ALLOTMENT PAD BOUNDARY
- S - SEWER MAIN AND MANHOLE
- SD - STORMWATER DRAIN & PIT
- SW - SW DRAIN & PIT CONSTRUCTED IN PREVIOUS STAGES
- H - HOUSE DRAIN
- GC - GAS CONDUIT
- WC - WATER CONDUIT
- RW - RECYCLED WATER CONDUIT
- W - WATER
- RW - RECYCLED WATER
- T - TELECOMMUNICATIONS
- E - ELECTRICITY
- G - GAS
- S - STREET NAME SIGN
- DW - DW HYDRANT
- NDW - NDW HYDRANT
- D - DIRECTION OF FALL (1 IN 150 MINIMUM)
- DW - DW WASHOUT
- NDW - NDW WASHOUT
- FS - EXISTING SURFACE LEVEL (CORNER)
- FS - FINISHED SURFACE LEVEL (CORNER)
- EW - EARTHWORKS PAD LEVEL (FUTURE)
- EW - EARTHWORKS PAD LEVEL
- EW - EX. EARTHWORKS PAD LEVEL

AVID Property Group

Coords: MGA
Levels: AHD

Hor 1:250 0m 2.5m 5m 10m 15m
Scale @ A1/A3 1:250/1:500

BLOOMDALE ESTATE
STAGE 27
120 DIGGERS REST - COIMDAI ROAD, DIGGERS REST, 3427
SALES SERVICING PLAN
SHEET 04 OF 04
Drawing No. 12563.27SSP04 Rev A
Sheet No. 04 PRELIMINARY
© Dalton Consulting Engineers Pty Ltd

DALTON CONSULTING ENGINEERS
ABN 788 429 221 049
QUEENSLAND
T 61 7 3374 9000
E info@dceng.com.au

VICTORIA
T 61 3 9813 7400
W dceng.com.au