

FOR CONTINUATION REFER TO SHEET No.02

**NOT TO BE USED FOR CONSTRUCTION**

REV	PRELIMINARY ISSE	23/01/20	TL
A	AMENDMENTS	DATE	APPD.

Written dimensions to take precedence over scale. Contractor shall check and verify all dimensions on site. Discrepancies to be brought to the attention of the Superintendent.

Drawn -  
Date -  
AN -  
Designed -  
Date -  
AN -  
Verified -  
Date -  
AN -  
Approved -  
Date -  
AN -

- Ex W - EXISTING WATER MAIN
- Ex G - EXISTING GAS MAIN
- Ex E - EXISTING ELECTRICAL CABLE
- Ex S - EXISTING SEWER MAIN & MANHOLE
- Ex T - EXISTING TELECOMM. CABLE
- Ex SD - EXISTING STORMWATER DRAIN & PIT
- CON - CONSTRUCTED PRE DEVELOPMENT BATTER (GRADE AS SPECIFIED) (SHOWN WHERE GRADES > 1 in 10)
- ALL - ALLOTMENT PAD BOUNDARY
- FILL - FILLING OVER 200mm

- LEGEND**
- S - SEWER MAIN AND MANHOLE
  - W - WATER
  - RW - RECYCLED WATER
  - T - TELECOMMUNICATIONS
  - E - ELECTRICITY
  - G - GAS
  - GC - STREET NAME SIGN
  - DW - DWYDRANT
  - WASH - DW WASHOUT
  - VALVE - DW VALVE
  - FALL - DIRECTION OF FALL (1 IN 150 MINIMUM)
  - ES - EXISTING SURFACE LEVEL (CORNER)
  - FS - FINISHED SURFACE LEVEL (CORNER)
  - TOB - TOP OF BATTER LEVEL
  - BOB - BOTTOM OF BANK LEVEL

- W - WATER
- RW - RECYCLED WATER
- T - TELECOMMUNICATIONS
- E - ELECTRICITY
- G - GAS
- GC - STREET NAME SIGN
- DW - DWYDRANT
- WASH - DW WASHOUT
- VALVE - DW VALVE
- FALL - DIRECTION OF FALL (1 IN 150 MINIMUM)

**AVID** Property Group

Coords: MGA  
Levels: AHD

Hor 1:250 0m 2.5m 5m 10m 15m

Scale @ A1/A3 1:250/1:500

**AVID PROPERTY GROUP**  
**PARCEL C - STAGE 34**  
 146 DIGGERS REST-COIMADAI ROAD, DIGGERS REST, 3427  
**SALES SERVICES PLAN**  
**SHEET 01 OF 03**  
**Drawing No. 12655.34SSP01 Rev A**  
 Sheet No. 01 **PRELIMINARY**  
 © Dalton Consulting Engineers Pty Ltd

**DALTON CONSULTING ENGINEERS**  
 ABN 78 429 221 049  
 VICTORIA  
 T 61 3 9813 7400  
 W dceng.com.au  
 E info@dceng.com.au

Drawn: [Name], Date: [Date], AN: [Name], Designed: [Name], Date: [Date], AN: [Name], Verified: [Name], Date: [Date], AN: [Name], Approved: [Name], Date: [Date], AN: [Name]

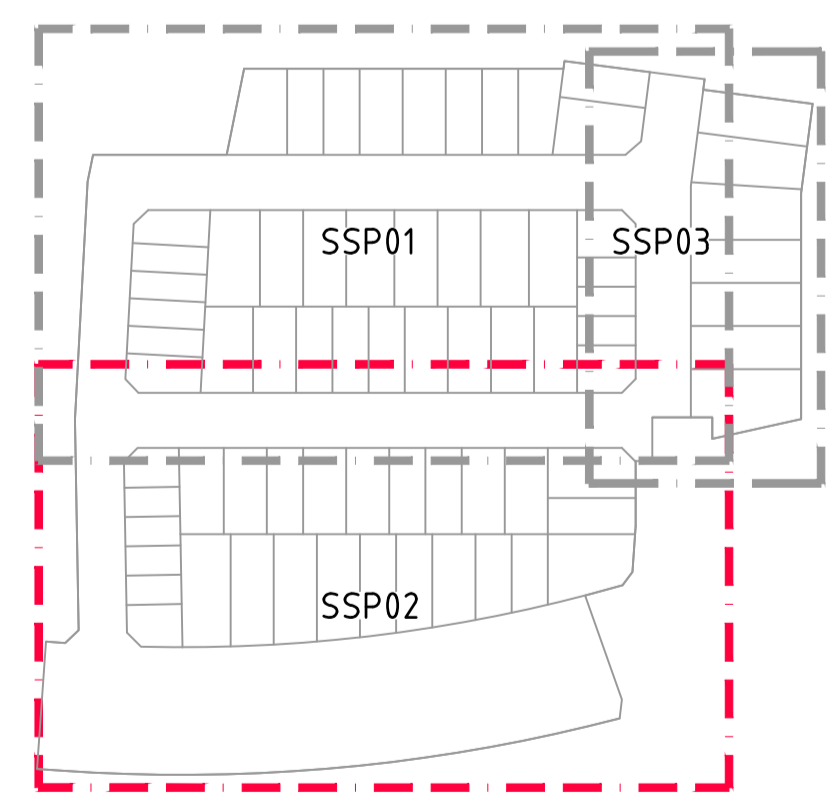
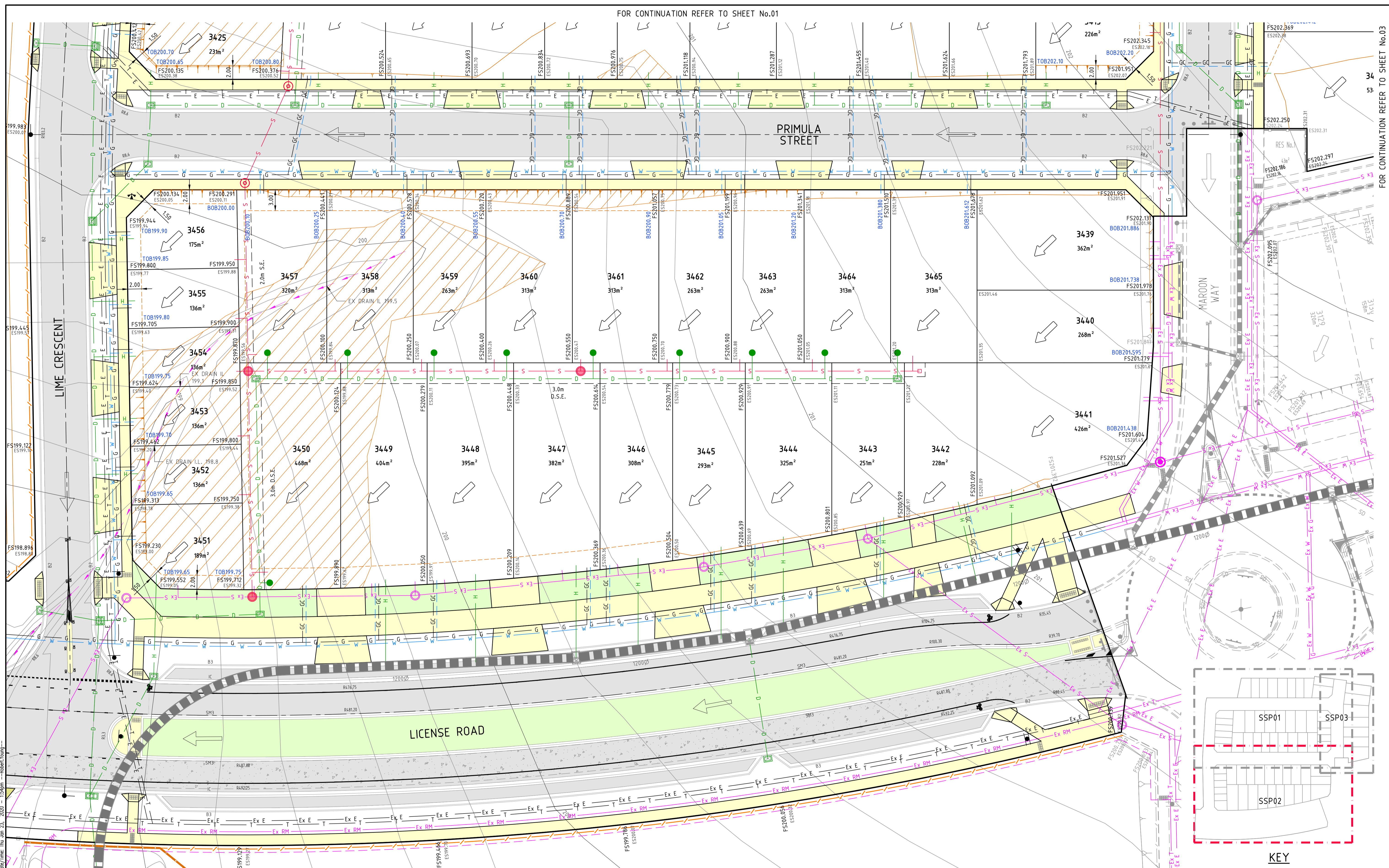

**NOT TO BE USED FOR CONSTRUCTION**

Drawn -			
Date -			
AN -			
Designed -			
Date -			
AN -			
Verified -			
Date -			
AN -			
Approved -			
Date -			
AN -			
REV	AMENDMENTS	DATE	APP'D.
A	PRELIMINARY ISSE	23/01/20	TL

Written dimensions to take precedence over scale. Contractor shall check and verify all dimensions on site. Discrepancies to be brought to the attention of the Superintendent.

**LEGEND**

- Ex W - EXISTING WATER MAIN
- Ex G - EXISTING GAS MAIN
- Ex E - EXISTING ELECTRICAL CABLE
- Ex S - EXISTING SEWER MAIN & MANHOLE
- Ex T - EXISTING TELECOMM. CABLE
- Ex SD - EXISTING STORMWATER DRAIN & PIT
- Ex P - EXISTING PRE DEVELOPMENT BATTER (GRADE AS SPECIFIED) (SHOWN WHERE GRADES > 1 in 10)
- ALLOTMENT PAD BOUNDARY
- FILLING OVER 200mm
- S - SEWER MAIN AND MANHOLE
- SD - STORMWATER DRAIN & PIT
- SW - SW DRAIN & PIT CONSTRUCTED IN PREVIOUS STAGES
- H - HOUSE DRAIN
- GC - GAS CONDUIT
- W - WATER
- RW - RECYCLED WATER
- T - TELECOMMUNICATIONS
- E - ELECTRICITY
- G - GAS
- SS - STREET NAME SIGN
- DW - DW HYDRANT
- W - DW WASHOUT
- V - DW VALVE
- F - DIRECTION OF FALL (1 IN 150 MINIMUM)
- ES - EXISTING SURFACE LEVEL (CORNER)
- FS - FINISHED SURFACE LEVEL (CORNER)
- TOB - TOP OF BATTER LEVEL
- BOB - BOTTOM OF BANK LEVEL
- W - WATER
- RW - RECYCLED WATER
- T - TELECOMMUNICATIONS
- E - ELECTRICITY
- G - GAS
- SS - STREET NAME SIGN
- DW - DW HYDRANT
- W - DW WASHOUT
- V - DW VALVE
- F - DIRECTION OF FALL (1 IN 150 MINIMUM)

**AVID** Property Group

Coords: MGA  
Levels: AHD

Hor 1:250 0m 2.5m 5m 10m 15m  
Scale @ A1/A3 1:250/1:500

**AVID PROPERTY GROUP**  
**PARCEL C - STAGE 34**  
 146 DIGGERS REST-COIMADAI ROAD, DIGGERS REST, 3427  
**SALES SERVICES PLAN**  
**SHEET 02 OF 03**  
**Drawing No. 12655.34SSP02 Rev A**  
 Sheet No. 02 **PRELIMINARY**  
 © Dalton Consulting Engineers Pty Ltd

**DALTON CONSULTING ENGINEERS**  
 ABN 78 429 221 049  
 QUEENSLAND  
 T 61 7 3374 9000  
 E info@dceng.com.au

VICTORIA  
 T 61 3 9813 7400  
 W dceng.com.au

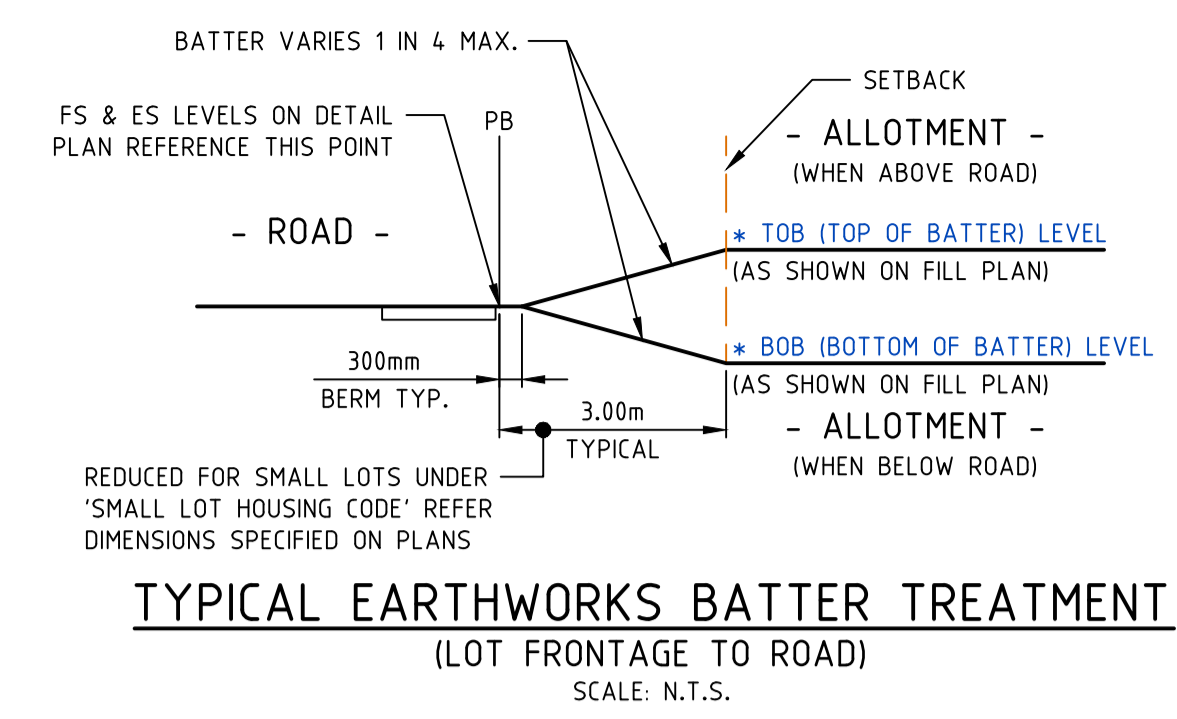
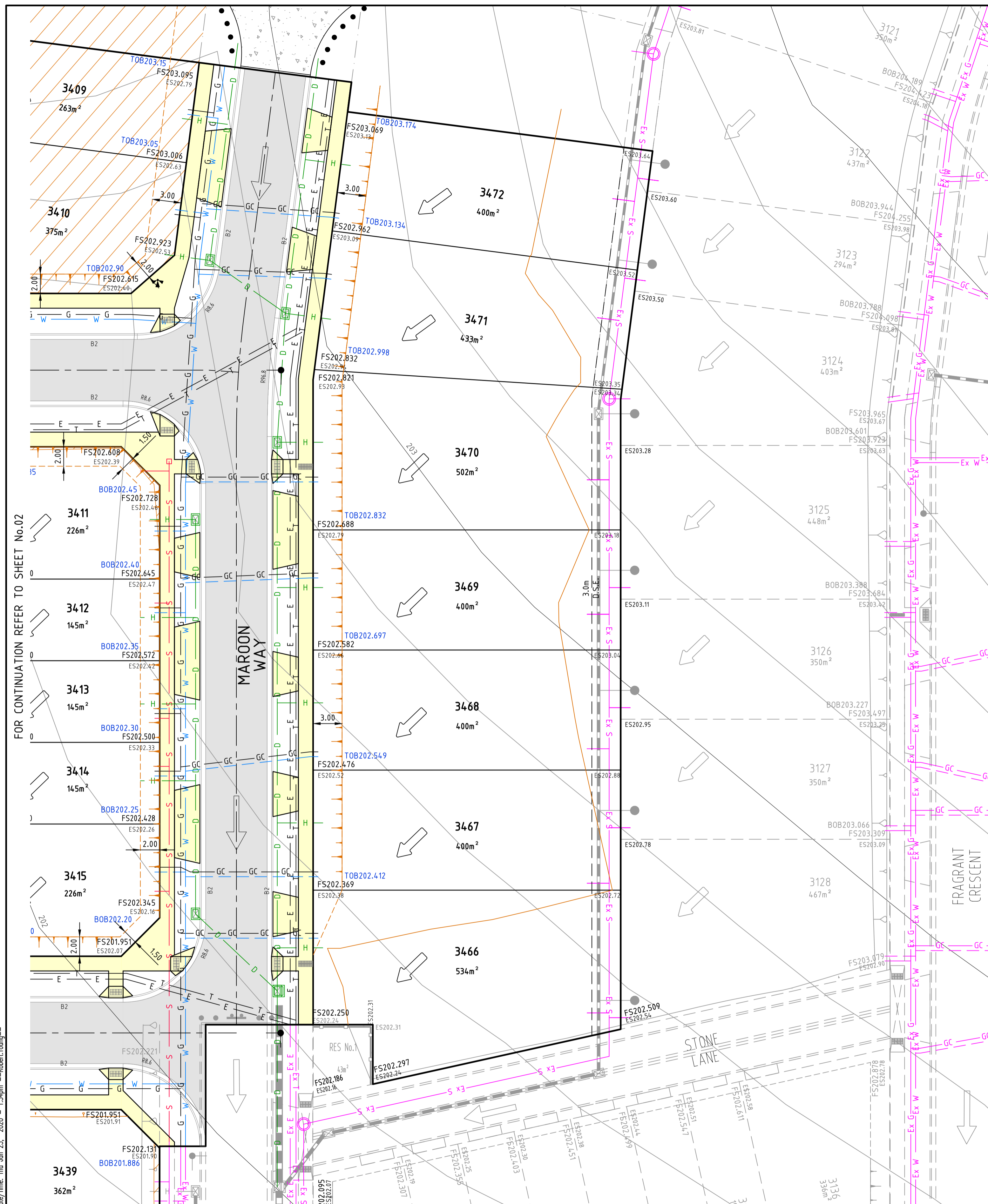

**FILL PLAN NOTES**

THIS PLAN SHOWS DETAILS OF WORKS AFFECTING THE NATURAL SURFACE OF THE LAND WITHIN THE SUBDIVISION WHICH HAVE BEEN CARRIED OUT OR ARE PROPOSED TO BE CARRIED OUT PRIOR TO REGISTRATION OF THE PLAN OF SUBDIVISION, BEING FILL PLACED ON THE LAND TO THE EXTENT AND DEPTH SHOWN ON THIS PLAN.

THIS PLAN DOES NOT SHOW ANY OTHER FILL WHICH MAY HAVE BEEN PLACED ON THE LAND PRIOR TO THE CIVIL WORKS BEING UNDERTAKEN.

THIS PLAN HAS BEEN PREPARED FOR THE PURPOSE OF CONSTRUCTING SUBDIVISIONAL WORKS AND IS NOT A RECORD OF 'AS BUILT DETAILS'.

FILLING SHOWN LESS THAN 200mm DEEP IS GRADED OR SPREAD OVER ALLOTMENTS TO CORRECT MINOR SURFACE IRREGULARITIES SUCH AS FURROWS ETC AND LOT GRADING.

IRRESPECTIVE OF THE DEPTH OF FILLING FOUNDATIONS MUST BE DESIGNED AND CONSTRUCTED IN ACCORDANCE WITH A SOIL CLASSIFICATION AND REPORT PREPARED FOR THE PURPOSE AND IN ACCORDANCE WITH THE APPROPRIATE BUILDING REGULATIONS.

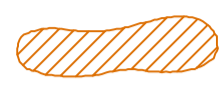
THE AREA MARKED THUS  ON THIS PLAN INDICATES FILL DEEPER THAN 200mm PLACED ON ALLOTMENTS.

THE EXTENT OF AND DEPTH OF FILL MUST BE CONFIRMED BY A PROPER GEOTECHNICAL INVESTIGATION BY AN EXPERIENCED PRACTITIONER.

FOR CONTINUATION REFER TO SHEET No.02

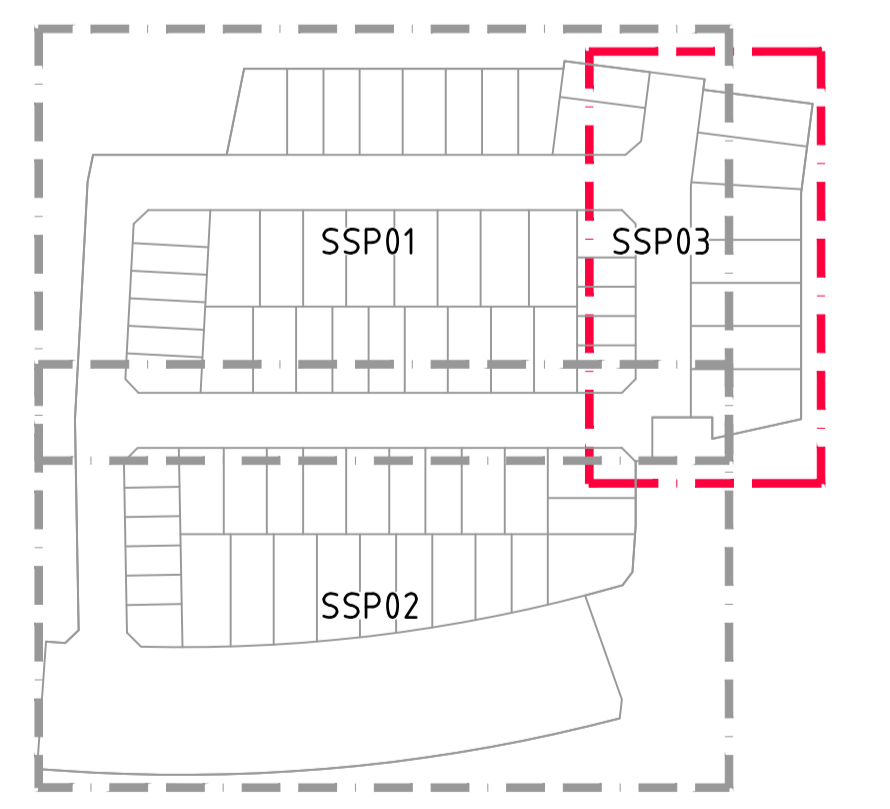

KEY

**NOT TO BE USED FOR CONSTRUCTION**

REV	PRELIMINARY ISSE	23/01/20	TL
A	AMENDMENTS	DATE	APPD.

Written dimensions to take precedence over scale. Contractor shall check and verify all dimensions on site. Discrepancies to be brought to the attention of the Superintendent.

Drawn -  
Date -  
AN -  
Designed -  
Date -  
AN -  
Verified -  
Date -  
AN -  
Approved -  
Date -  
AN -

- Ex W - EXISTING WATER MAIN
- Ex G - EXISTING GAS MAIN
- Ex E - EXISTING ELECTRICAL CABLE
- Ex S - EXISTING SEWER MAIN & MANHOLE
- Ex T - EXISTING TELECOMM. CABLE
- Ex SD - EXISTING STORMWATER DRAIN & PIT
- CON - CONSTRUCTED PRE DEVELOPMENT
- BATTER (GRADE AS SPECIFIED) (SHOWN WHERE GRADES > 1 IN 10)
- ALLOTMENT PAD BOUNDARY
- FILLING OVER 200mm

- LEGEND**
- S - SEWER MAIN AND MANHOLE
  - SD - STORMWATER DRAIN & PIT
  - SW - SW DRAIN & PIT CONSTRUCTED IN PREVIOUS STAGES
  - H - HOUSE DRAIN
  - GC - EXISTING TELECOMM. CABLE
  - W - WATER CONDUIT
  - ES - EXISTING SURFACE LEVEL (CORNER)
  - FS - FINISHED SURFACE LEVEL (CORNER)
  - TOB - TOP OF BATTER LEVEL
  - BOB - BOTTOM OF BANK LEVEL

- W - WATER
- RW - RECYCLED WATER
- T - TELECOMMUNICATIONS
- E - ELECTRICITY
- G - GAS
- SS - STREET NAME SIGN
- DW - DW HYDRANT
- DWV - DW WASHOUT
- DWV - DW VALVE
- D - DIRECTION OF FALL (1 IN 150 MINIMUM)

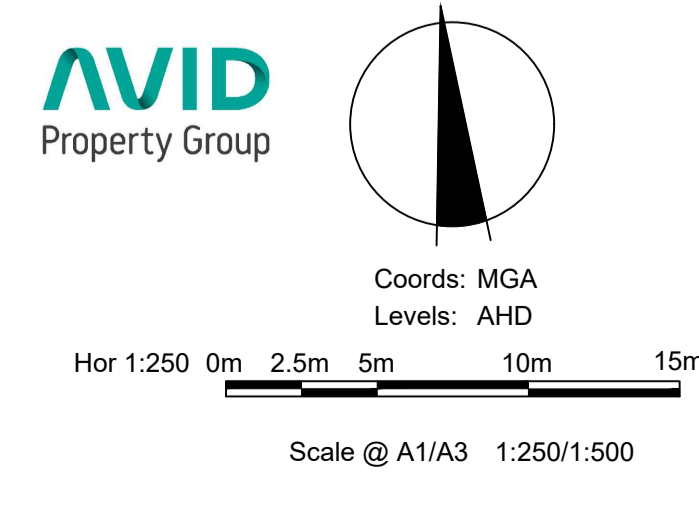

**AVID PROPERTY GROUP**  
**PARCEL C - STAGE 34**  
 146 DIGGERS REST-COIMADAI ROAD, DIGGERS REST, 3427  
**SALES SERVICES PLAN**  
**SHEET 03 OF 03**  
**Drawing No. 12655.34SSP03 Rev A**  
 Sheet No. 03 **PRELIMINARY**  
 © Dalton Consulting Engineers Pty Ltd

**DALTON CONSULTING ENGINEERS**  
 ABN 78 429 221 049  
 QUEENSLAND  
 T 61 7 3374 9000  
 E info@dceng.com.au  
 VICTORIA  
 T 61 3 9813 7400  
 W dceng.com.au