

FOR CONTINUATION REFER TO SHEET No.02

Drawing File: C:\2d\Synergy\delta\ENERGY-ME\12655.33-Bloomdale Stage 33_1322\DESIGN\01_ACA0\03_GENERAL\12655.33SSP01.dwg - SSP01
 Date/Time: Fri May 21, 2021 10:00am - Robert Young

NOT TO BE USED FOR CONSTRUCTION

Drawn Date	AN	R.YOUNG	12/05/21
Designed Date	AN	K.PHAL	12/05/21
Checked Date	AN		
Approved Date	AN		

LEGEND	
— Ex W	EX. WATER MAIN
— Ex G	EX. GAS MAIN
— Ex E	EX. ELECTRICAL CABLE
— Ex S	EX. SEWER MAIN & MH
— Ex T	EX. COMM. CABLE & PIT
— Ex D	EX. DRAIN & PIT
— E	ELECTRICITY
— T	TELECOMMUNICATIONS
— G	GAS
— W	WATER
— DW/G	DW/GAS CONDUITS
— L	LIMIT OF WORKS
— B	BATTER
— A	ALLOTMENT PAD BOUNDARY
— S	SEWER MAIN & MANHOLE
— H	HOUSE DRN PROP. INLET
— I	REGRADE LOT (MIN 1:50)
— O	OVERLAND FLOW ARROW
— T	TOP OF BATTER
— B	BOTTOM OF BATTER
— A	ASPHALT PAVEMENT
— C	CONCRETE PATH D'WAY
— T	TURN AREA
— F	FILLING OVER 300mm
— S	SPEED HUMP
— E	EXISTING SURFACE LEVEL
— F	FINISHED SURFACE LEVEL

Coords: MGA Levels: AHD

DIAL BEFORE YOU DIG
www.1100.com.au

AVID
Property Group

Scale @ A1/A3 1:250 / 1:500

BLOOMDALE ESTATE
PARCEL C - STAGE 33
 146 DIGGERS REST - COIMADAI ROAD, DIGGERS REST, 3427
MELTON CITY COUNCIL
CONTRACT PLANS
SHEET 01 OF 02
 Drawing No. 12655.33SSP01 Rev B
 Sheet No. 01 of 02

DALTON CONSULTING ENGINEERS
 ABN 78 429 221 049
 QUEENSLAND
 T 61 7 3374 9000
 E info@dceng.com.au

VICTORIA
 T 61 3 9813 7400
 W dceng.com.au

PRELIMINARY

Written dimensions to take precedence over scale. Contractor shall check and verify all dimensions on site. Discrepancies to be brought to the attention of the Superintendent.

FOR CONTINUATION REFER TO SHEET No.01

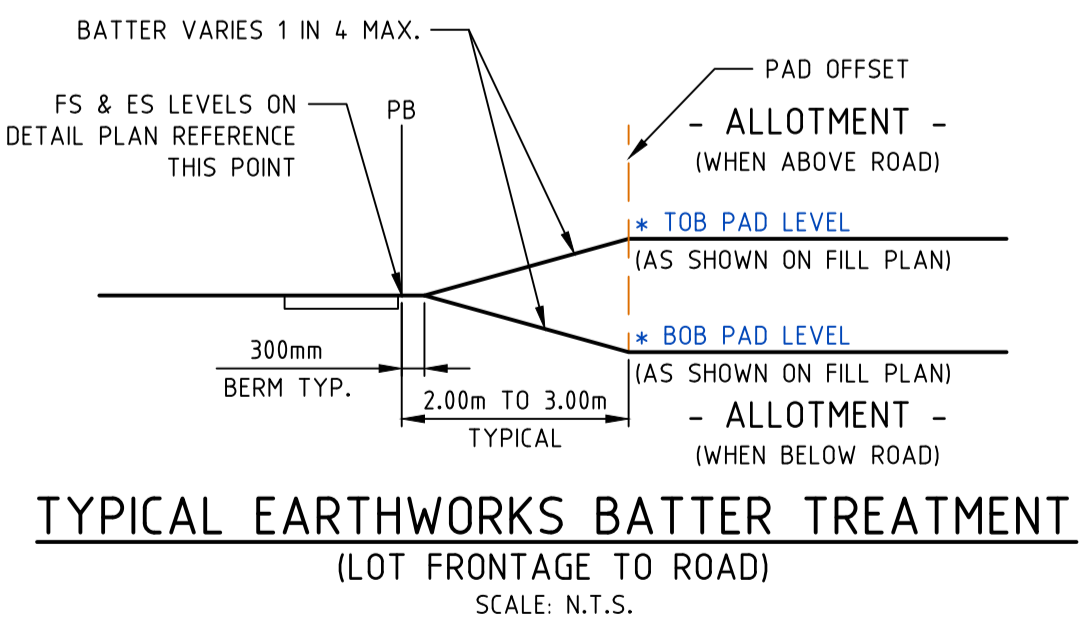
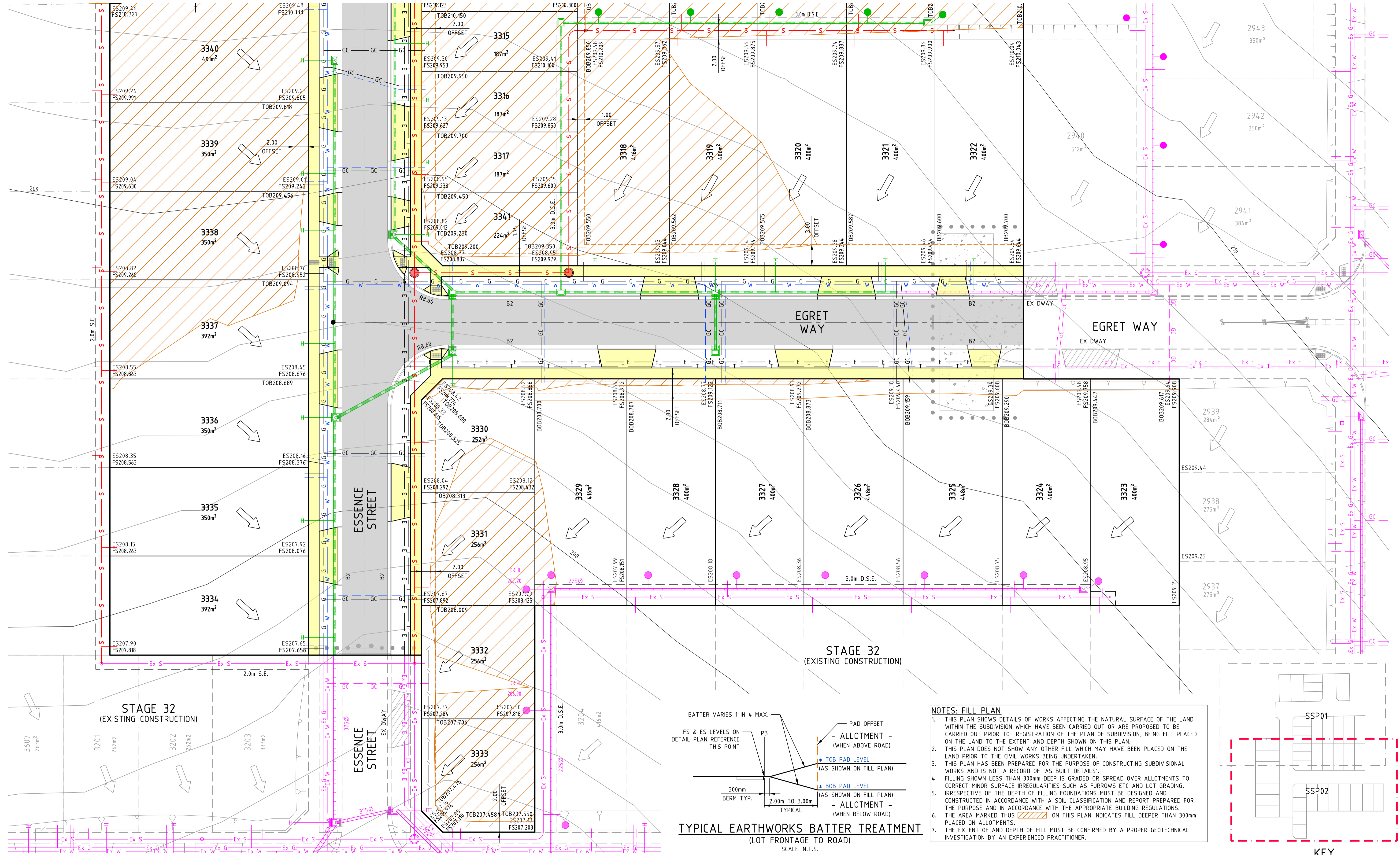

- NOTES: FILL PLAN**
- THIS PLAN SHOWS DETAILS OF WORKS AFFECTING THE NATURAL SURFACE OF THE LAND WITHIN THE SUBDIVISION WHICH HAVE BEEN CARRIED OUT OR ARE PROPOSED TO BE CARRIED OUT PRIOR TO REGISTRATION OF THE PLAN OF SUBDIVISION, BEING FILL PLACED ON THE LAND TO THE EXTENT AND DEPTH SHOWN ON THIS PLAN.
 - THIS PLAN DOES NOT SHOW ANY OTHER FILL WHICH MAY HAVE BEEN PLACED ON THE LAND PRIOR TO THE CIVIL WORKS BEING UNDERTAKEN.
 - THIS PLAN HAS BEEN PREPARED FOR THE PURPOSE OF CONSTRUCTING SUBDIVISIONAL WORKS AND IS NOT A RECORD OF 'AS BUILT DETAILS'.
 - FILLING SHOWN LESS THAN 300mm DEEP IS GRADED OR SPREAD OVER ALLOTMENTS TO CORRECT MINOR SURFACE IRREGULARITIES SUCH AS FURROWS ETC AND LOT GRADING.
 - IRRESPECTIVE OF THE DEPTH OF FILLING FOUNDATIONS MUST BE DESIGNED AND CONSTRUCTED IN ACCORDANCE WITH A SOIL CLASSIFICATION AND REPORT PREPARED FOR THE PURPOSE AND IN ACCORDANCE WITH THE APPROPRIATE BUILDING REGULATIONS.
 - THE AREA MARKED THUS ON THIS PLAN INDICATES FILL DEEPER THAN 300mm PLACED ON ALLOTMENTS.
 - THE EXTENT OF AND DEPTH OF FILL MUST BE CONFIRMED BY A PROPER GEOTECHNICAL INVESTIGATION BY AN EXPERIENCED PRACTITIONER.

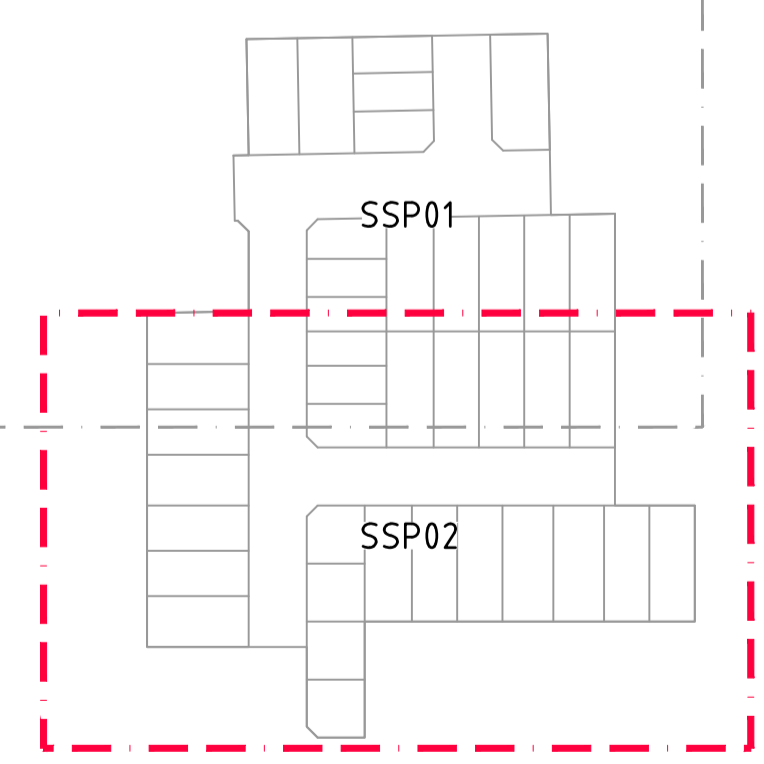

Domain: File: C:\124_Survey\Aerial\ENERGY-ME\12655_33-Blomdale Stage 33_13221_1_DESIGN\01_ACAD\03_GENERAL\12655_33SSP01.dwg -- S5202 Date/Time: Fri May 21, 2021 10:00am -- Robert Young--

NOT TO BE USED FOR CONSTRUCTION

Drawn	R.YOUNG
Date	12/05/21
AN	
Designed	K.PHAL
Date	12/05/21
AN	
Checked	
Date	
AN	
Approved	
Date	
AN	

LEGEND	
	EX. WATER MAIN
	EX. GAS MAIN
	EX. ELECTRICAL CABLE
	EX. SEWER MAIN & MH
	EX. COMM. CABLE & PIT
	EX. DRAIN & PIT
	SIGNAGE
	PSM TM
	ELECTRICITY
	TELECOMMUNICATIONS
	GAS
	WATER
	DW/GAS CONDUITS
	LIMIT OF WORKS
	BATTER
	ALLOTMENT PAD BOUNDARY
	SEWER MAIN & MANHOLE
	SW DRAIN & PIT
	HOUSE DRN PROP. INLET
	REGRADE LOT (MIN 1:50)
	OVERLAND FLOW ARROW
	TOP OF BATTER
	BOTTOM OF BATTER
	ASPHALT PAVEMENT
	CONCRETE PATH D'WAY
	TURN AREA
	FILLING OVER 300mm
	SPEED HUMP
	EXISTING SURFACE LEVEL
	FINISHED SURFACE LEVEL

Coords: MGA Levels: AHD

www.1100.com.au

AVID
Property Group

Scale @ A1/A3 1:250 / 1:500

BLOOMDALE ESTATE
PARCEL C - STAGE 33
 146 DIGGERS REST - COIMADAI ROAD, DIGGERS REST, 3427
MELTON CITY COUNCIL
CONTRACT PLANS
SHEET 02 OF 02
 Drawing No. 12655.33SSP02 Rev B
 Sheet No. 02 of 02

DALTON CONSULTING ENGINEERS
 ABN 78 429 221 049
 QUEENSLAND
 T 61 7 3374 9000
 E info@dceng.com.au

PRELIMINARY