

Drawing File: C:\126\Synergy\data\SYNERGY-HE\12655-37-Bloomdale Stage 37_13261_DESIGN\01_A40\03_GENERAL\12655_37SSP01.dwg - SSP01
 Date/Time: Tue Jul 27, 2021 - 3:18pm - Robert Young

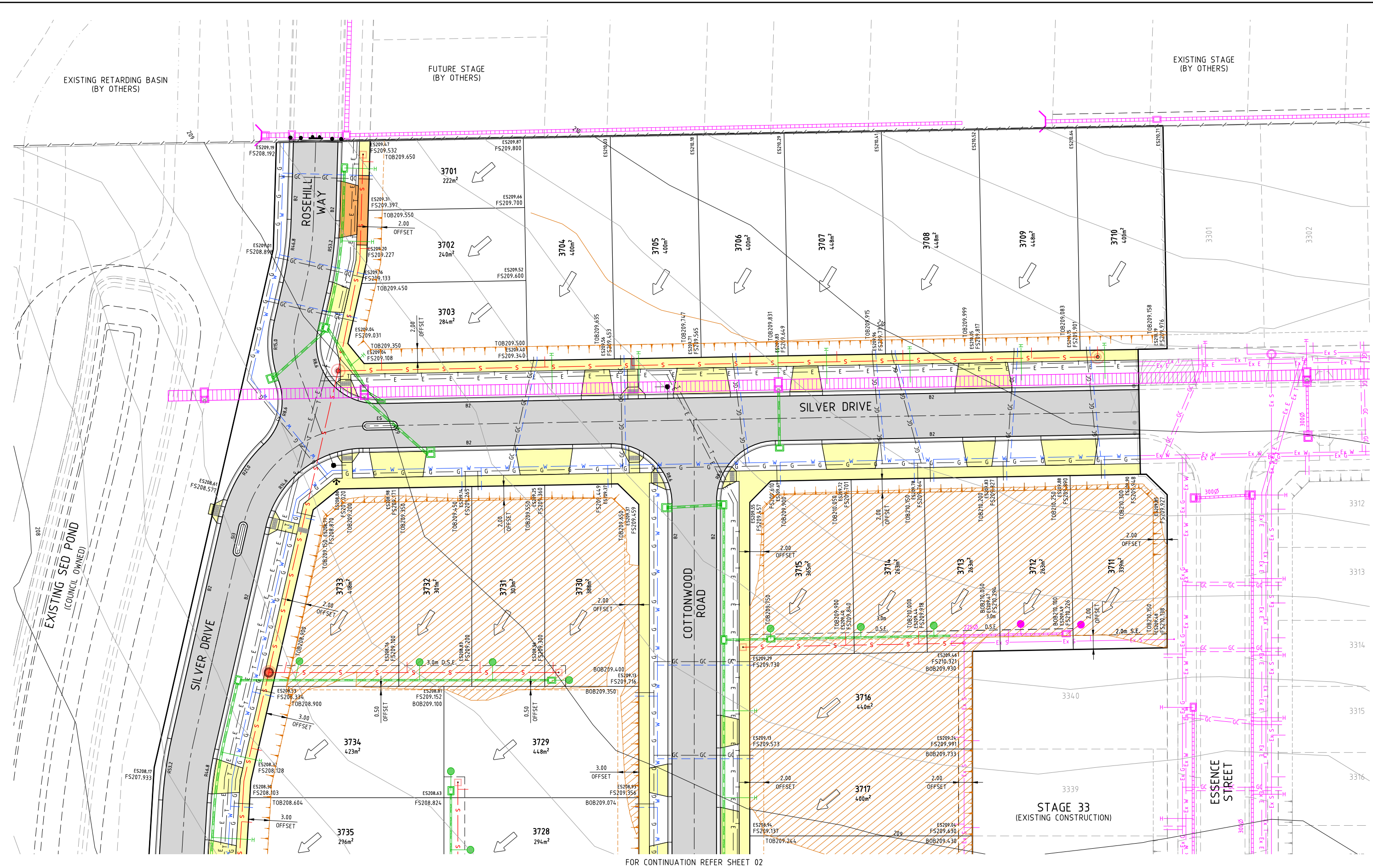

FOR CONTINUATION REFER SHEET 02

NOT TO BE USED FOR CONSTRUCTION			
REV	DESCRIPTION	DATE	AMEND
A	PRELIMINARY ISSUE	27/07/21	KPI/RV TL

Drawn Date: R.YOUNG 27/06/21
 Designed Date: K.PHAL 27/06/21
 Checked Date: AN
 Approved Date: AN
 Date: AN
 APPD

Drawn Date: R.YOUNG 27/06/21
 Designed Date: K.PHAL 27/06/21
 Checked Date: AN
 Approved Date: AN
 Date: AN
 APPD

- LEGEND**
- EX W - EX. WATER MAIN
 - EX G - EX. GAS MAIN
 - EX E - EX. ELECTRICAL CABLE
 - EX S - EX. SEWER MAIN & MH
 - EX T - EX. COMM. CABLE & PIT
 - EX D - EX. DRAIN & PIT
 - PSH | TBM
 - E - ELECTRICITY
 - T - TELECOMMUNICATIONS
 - G - GAS
 - W - WATER
 - GC - DW/GAS CONDUITS
 - S - SEWER MAIN & MANHOLE
 - SW - SW DRAIN & PIT
 - H - HOUSE DRN | PROP. INLET
 - REGRADE LOT (MIN 1:50)
 - OVERLAND FLOW ARROW
 - FILLING OVER 300mm
 - BATTER
 - ALLOTMENT PAD BOUNDARY
 - ASPHALT PAVEMENT
 - CONCRETE PATH | D'WAY
 - HEAVY DUTY D'WAY
 - EXISTING SURFACE LEVEL
 - FINISHED SURFACE LEVEL
 - TOP OF BATTER
 - TOE OF BATTER

AVID
Property Group

Coords: MGA Levels: AHD

DIAL BEFORE YOU DIG
www.1100.com.au

Scale @ A1/A3 1:250 / 1:500

BLOOMDALE ESTATE
PARCEL C - STAGE 37
 146 DIGGERS REST - COIMADAI ROAD, DIGGERS REST 3427
 MELTON CITY COUNCIL
CONTRACT PLANS
SHEET 01 OF 02
 Drawing No. 12655.37SSP01 Rev A
 Sheet No. 01 of 02

DALTON CONSULTING ENGINEERS
 ABN 78 429 221 049
 VICTORIA
 T 61 3 9813 7400
 W dcheng.com.au
 QUEENSLAND
 T 61 7 3374 9000
 E info@dceng.com.au

PRELIMINARY

FOR CONTINUATION REFER SHEET 01

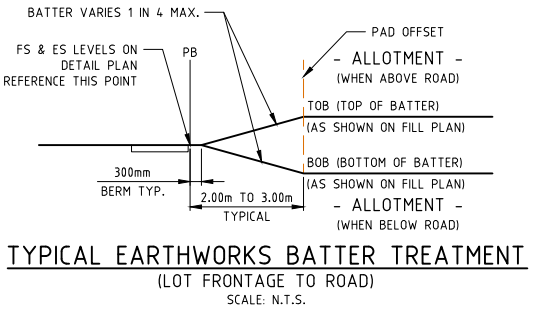
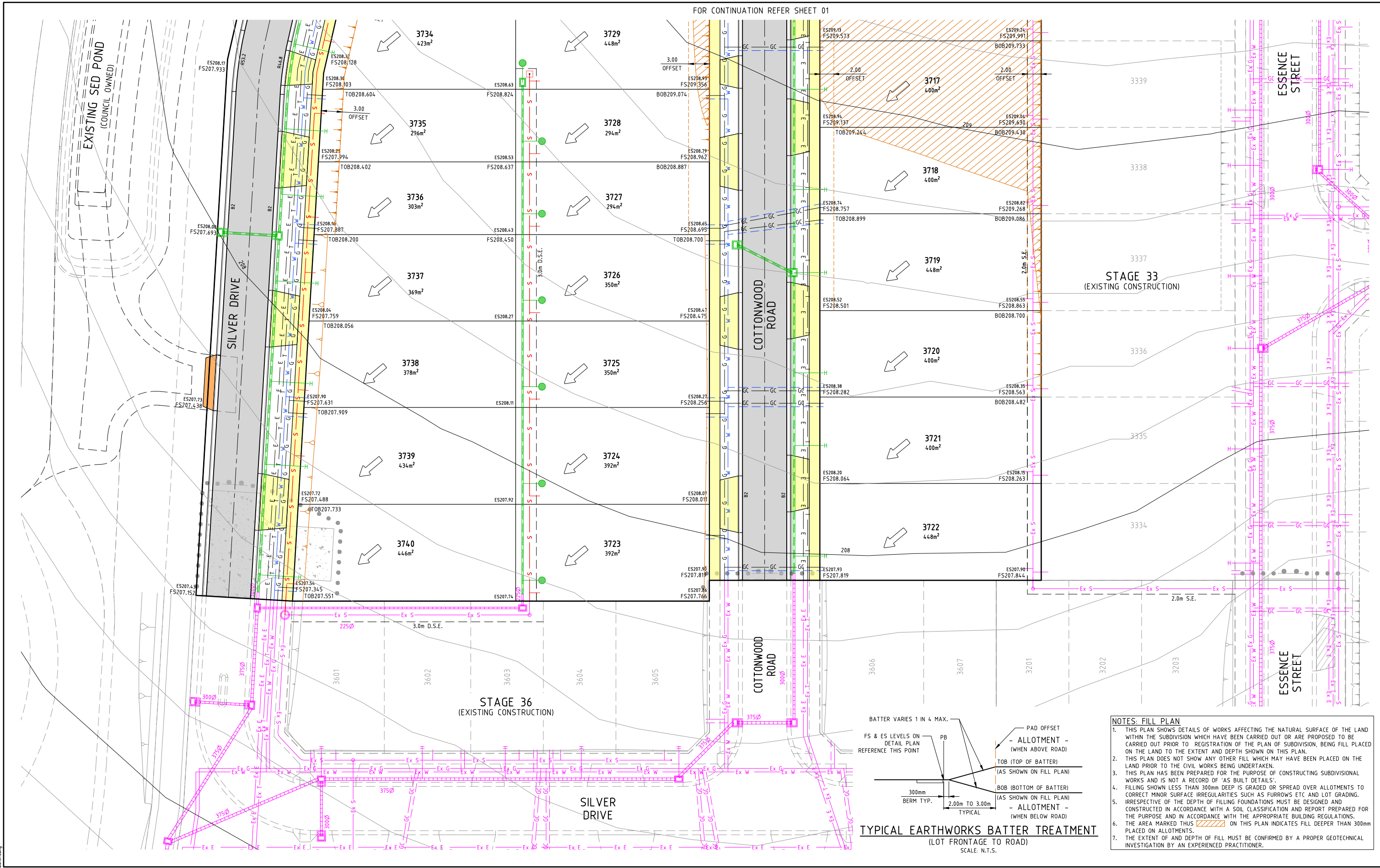

- NOTES: FILL PLAN**
1. THIS PLAN SHOWS DETAILS OF WORKS AFFECTING THE NATURAL SURFACE OF THE LAND WITHIN THE SUBDIVISION WHICH HAVE BEEN CARRIED OUT OR ARE PROPOSED TO BE CARRIED OUT PRIOR TO REGISTRATION OF THE PLAN OF SUBDIVISION, BEING FILL PLACED ON THE LAND TO THE EXTENT AND DEPTH SHOWN ON THIS PLAN.
 2. THIS PLAN DOES NOT SHOW ANY OTHER FILL WHICH MAY HAVE BEEN PLACED ON THE LAND PRIOR TO THE CIVIL WORKS BEING UNDERTAKEN.
 3. THIS PLAN HAS BEEN PREPARED FOR THE PURPOSE OF CONSTRUCTING SUBDIVISIONAL WORKS AND IS NOT A RECORD OF 'AS BUILT' DETAILS.
 4. FILLING SHOWN LESS THAN 300mm DEEP IS GRADED OR SPREAD OVER ALLOTMENTS TO CORRECT MINOR SURFACE IRREGULARITIES SUCH AS FURROWS ETC AND LOT GRADING.
 5. IRRESPECTIVE OF THE DEPTH OF FILLING FOUNDATIONS MUST BE DESIGNED AND CONSTRUCTED IN ACCORDANCE WITH A SOIL CLASSIFICATION AND REPORT PREPARED FOR THE PURPOSE AND IN ACCORDANCE WITH THE APPROPRIATE BUILDING REGULATIONS.
 6. THE AREA MARKED WITH ON THIS PLAN INDICATES FILL DEEPER THAN 300mm PLACED ON ALLOTMENTS.
 7. THE EXTENT OF AND DEPTH OF FILL MUST BE CONFIRMED BY A PROPER GEOTECHNICAL INVESTIGATION BY AN EXPERIENCED PRACTITIONER.

NOT TO BE USED FOR CONSTRUCTION

REV	DESCRIPTION	DATE	AMEND	APPD
A	PRELIMINARY ISSUE	27/07/21	KPI/RV	TL

Drawn Date AN R.YOUNG 27/06/21
 Designed Date AN K.PHAL 27/06/21
 Checked Date AN
 Approved Date AN

- LEGEND**
- Ex W - EX. WATER MAIN
 - Ex G - EX. GAS MAIN
 - Ex E - EX. ELECTRICAL CABLE
 - Ex S - EX. SEWER MAIN & MH
 - Ex T - EX. COMM. CABLE & PIT
 - Ex D - EX. DRAIN & PIT
 - Signage
 - PSM | TBM
 - E - ELECTRICITY
 - T - TELECOMMUNICATIONS
 - G - GAS
 - W - WATER
 - GC - DW/GAS CONDUITS
 - S - SEWER MAIN & MANHOLE
 - SW DRAIN & PIT
 - House Drn | Prop. Inlet
 - Regrade Lot (Min 1:50)
 - Overland Flow Arrow
 - Filling Over 300mm
 - Batter
 - Allotment Pad Boundary
 - Asphalt Pavement
 - Concrete Path | D'Way
 - Heavy Duty D'Way
 - Existing Surface Level
 - Finished Surface Level
 - Top of Batter
 - Toe of Batter

Coords: MGA Levels: AHD
 www.1100.com.au

AVID
Property Group

Scale @ A1/A3 1:250 / 1:500

BLOOMDALE ESTATE
PARCEL C - STAGE 37
 146 DIGGERS REST - COIMADAI ROAD, DIGGERS REST 3427
 MELTON CITY COUNCIL
 CONTRACT PLANS
 SHEET 02 OF 02
 Drawing No. 12655.37SSP02 Rev A
 Sheet No. 02 of 02

DALTON CONSULTING ENGINEERS
 ABN 78 429 221 049
 VICTORIA T61 3 9813 7400 Wdceng.com.au
 QUEENSLAND T61 7 3374 9000 E info@dceng.com.au

PRELIMINARY

Drawing File: C:\126\1261\126101\DESIGN\01_A40\03_GENERAL\12655.37SSP02.dwg - SSP02
 Date/Time: Tue Jul 27, 2021 - 3:18pm - Robert Young