

STAGE 39
(FUTURE PARK RESERVE)

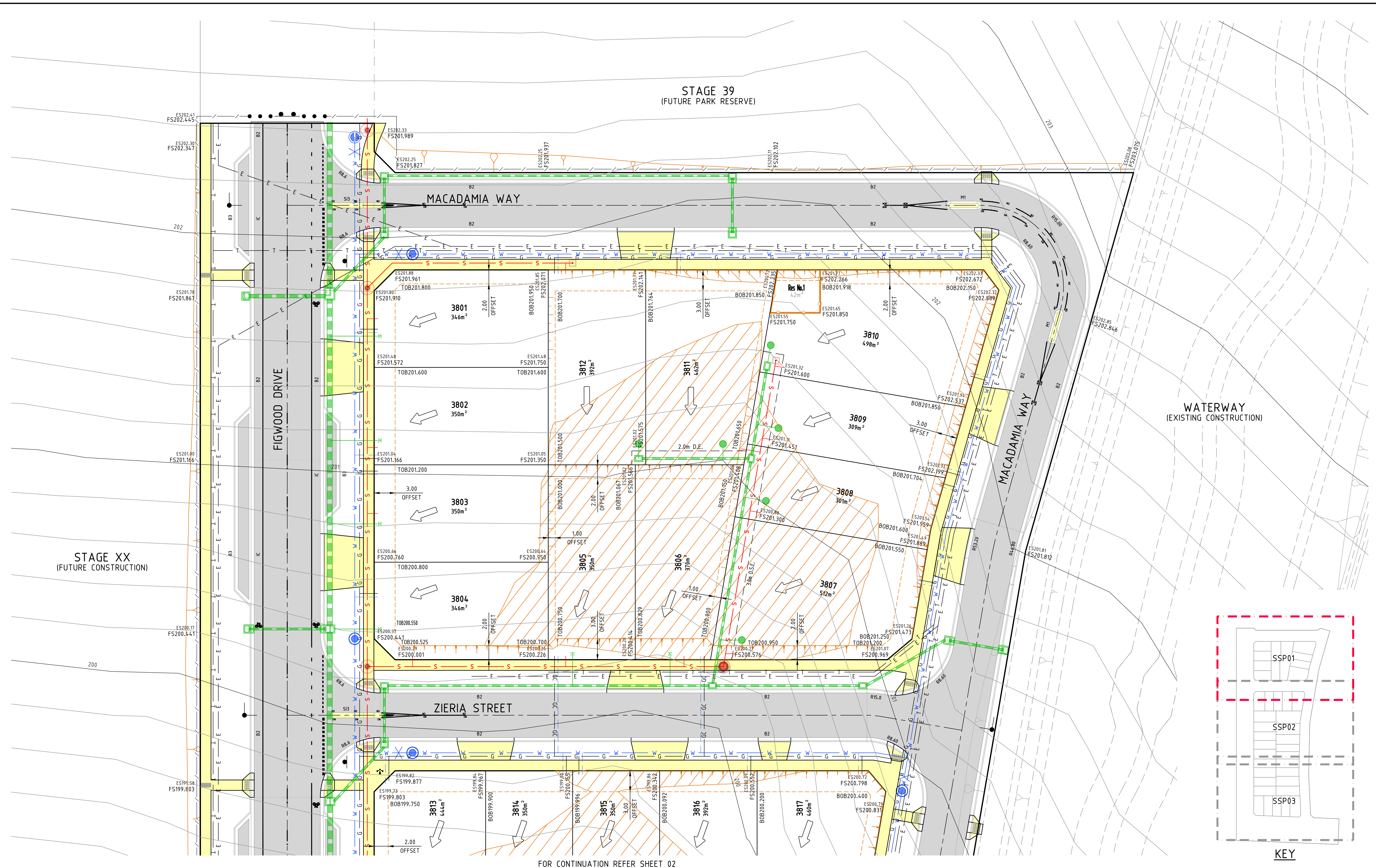

WATERWAY
(EXISTING CONSTRUCTION)

STAGE XX
(FUTURE CONSTRUCTION)

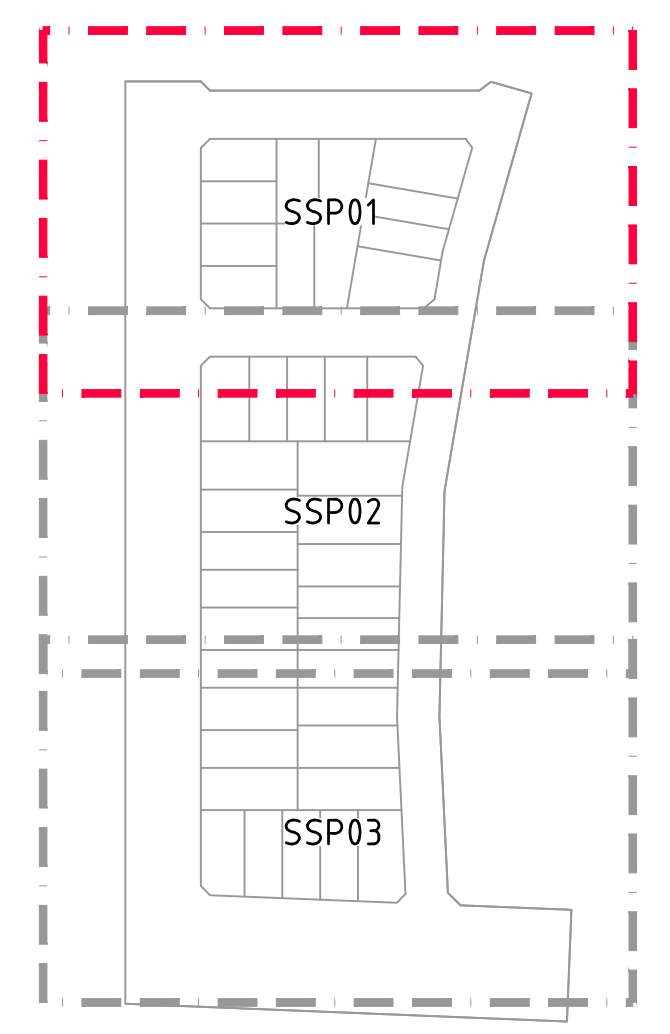

KEY

FOR CONTINUATION REFER SHEET 02

Drawing File: C:\2d\Synergy\delta\ENERGY-ME\12655_38-Bloomdale Stage_38 (PO Number 38092)_1327\1 DESIGN\01_ACAD\03_GENERAL\12655_38SSP01.dwg - 3801
 Date/Time: Wed Nov 02, 2022 - 11:59am - Robert Young

REV	DESCRIPTION	DATE	AMEND	APPD
D	FINAL CLIENT ISSUE	02/11/22	KP/RY	TL
C	PRELIMINARY ISSUE	18/01/22	KP/RY	TL
B	PRELIMINARY ISSUE	03/11/21	KP/RY	TL
A	PRELIMINARY ISSUE	28/10/21	KP/RY	TL

Drawn
Date
AN
 Designed
Date
K.PHAL
28/10/21
 Checked
Date
AN
 Approved
Date
AN

LEGEND

EX W	EX. WATER MAIN	E	ELECTRICITY
EX G	EX. GAS MAIN	T	TELECOMMUNICATIONS
EX E	EX. ELECTRICAL CABLE	G	GAS
EX S	EX. SEWER MAIN & MH	W	WATER
EX T	EX. COMM. CABLE & PIT	DW/G	DW/GAS CONDUITS
EX D	EX. DRAIN & PIT	GC	SEWER MAIN & MANHOLE
SIGNAGE		SW	SW DRAIN & PIT
PSM TBM		H	HOUSE DRN PROP. INLET

	REGRADE LOT (MIN 1:50)		FS21.650	FINISHED SURFACE LEVEL
	ASPHALT PAVEMENT		ES20.06	EX. SURFACE LEVEL
	CONCRETE PATH D'WAY		TOB21.650	TOP OF BATTER LEVEL
	HEAVY DUTY D'WAY		BOB21.650	BOTTOM OF BATTER LEVEL
	RAISED PLATFORM			BATTER
	LANDSCAPING			BENCHING
	FILLING OVER 300mm			FENCE (TYPE 1)
	WATER HYDRANTS, WASHBAYS & VALVES			FENCE (TYPE 2)

Coords: MGA Levels: AHD

 www.byd.com.au

Scale @ A1/A3
 0m 2.5m 5m 10m 15m
 1:250 / 1:500

BLOOMDALE ESTATE
PARCEL C - STAGE 38
 146 DIGGERS REST - COIMADAI ROAD, DIGGERS REST 3427
MELTON CITY COUNCIL
CONTRACT PLANS
SHEET 01 OF 03
 Drawing No. 12655.38SSP01 Rev D
 Sheet No. 01 of 03

DALTON CONSULTING ENGINEERS
 ABN 78 429 221 049
 QUEENSLAND
 T 61 7 3374 9000
 E info@dceng.com.au

FOR CONTINUATION REFER SHEET 01

ZIERIA STREET

FIGWOOD DRIVE

MACADAMIA WAY

WATERWAY
(EXISTING CONSTRUCTION)

STAGE XX
(FUTURE CONSTRUCTION)

FOR CONTINUATION REFER SHEET 03

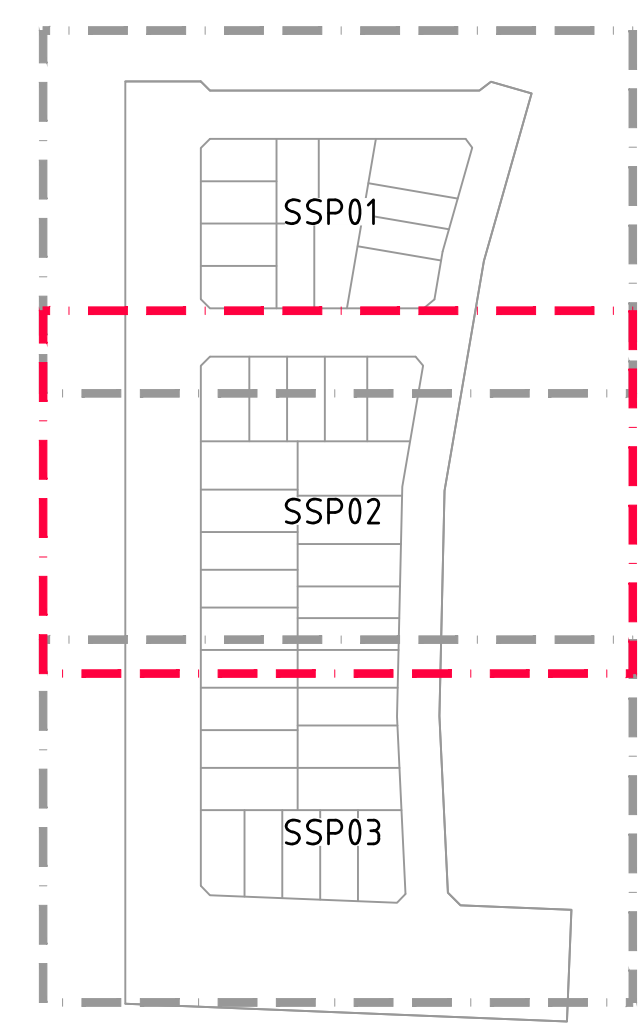

KEY

Drawing File: C:\124_Synergy\delta\delta\ENERGY-ME\12655_38-Bloomdale Stage_38 (PO Number 38002)_13271_LDESIGN\01_ACAD\03_GENERAL\12655_38SSP02.dwg
 Date/Time: Wed Nov 02, 2022 - 11:59am - Robert Young

Drawn	R.YOUNG
Date	28/10/21
AN	
Designed	K.PHAL
Date	28/10/21
AN	
Checked	
Date	
AN	
Approved	
Date	
AN	

© Dalton Consulting Engineers Pty Ltd

LEGEND

- Ex W — EX. WATER MAIN
- Ex G — EX. GAS MAIN
- Ex E — EX. ELECTRICAL CABLE
- Ex S — EX. SEWER MAIN & MH
- Ex T — EX. COMM. CABLE & PIT
- Ex D — EX. DRAIN & PIT
- SIGNAGE
- PSM | TBM
- E — ELECTRICITY
- T — TELECOMMUNICATIONS
- G — GAS
- W — WATER
- GC — DW/GAS CONDUITS
- S — SEWER MAIN & MANHOLE
- SW — SW DRAIN & PIT
- H — HOUSE DRN | PROP. INLET
- R — REGRADE LOT (MIN 1:50)
- A — ASPHALT PAVEMENT
- C — CONCRETE PATH | D'WAY
- H — HEAVY DUTY D'WAY
- L — RAISED PLATFORM
- LA — LANDSCAPING
- F — FILLING OVER 300mm
- W — WATER HYDRANTS, MASHBOTS & VALVES
- FS21.650 — FINISHED SURFACE LEVEL
- ES020.66 — EX. SURFACE LEVEL
- TOB21.650 — TOP OF BATTER LEVEL
- BOB21.650 — BOTTOM OF BATTER LEVEL
- B — BATTER
- B — BENCHING
- F — FENCE (TYPE 1)
- F — FENCE (TYPE 2)

Coords: MGA Levels: AHD

AVID
Property Group

Scale @ A1/A3 1:250 / 1:500

BLOOMDALE ESTATE
PARCEL C - STAGE 38
 146 DIGGERS REST - COIMADAI ROAD, DIGGERS REST 3427
MELTON CITY COUNCIL
CONTRACT PLANS
SHEET 02 OF 03
 Drawing No. 12655.38SSP02 Rev D
 Sheet No. 02 of 03

DALTON CONSULTING ENGINEERS
 ABN 78 429 221 049
 QUEENSLAND
 T 61 7 3374 9000
 E info@dceng.com.au

VICTORIA
 T 61 3 9813 7400
 W dceng.com.au

CONSTRUCTION

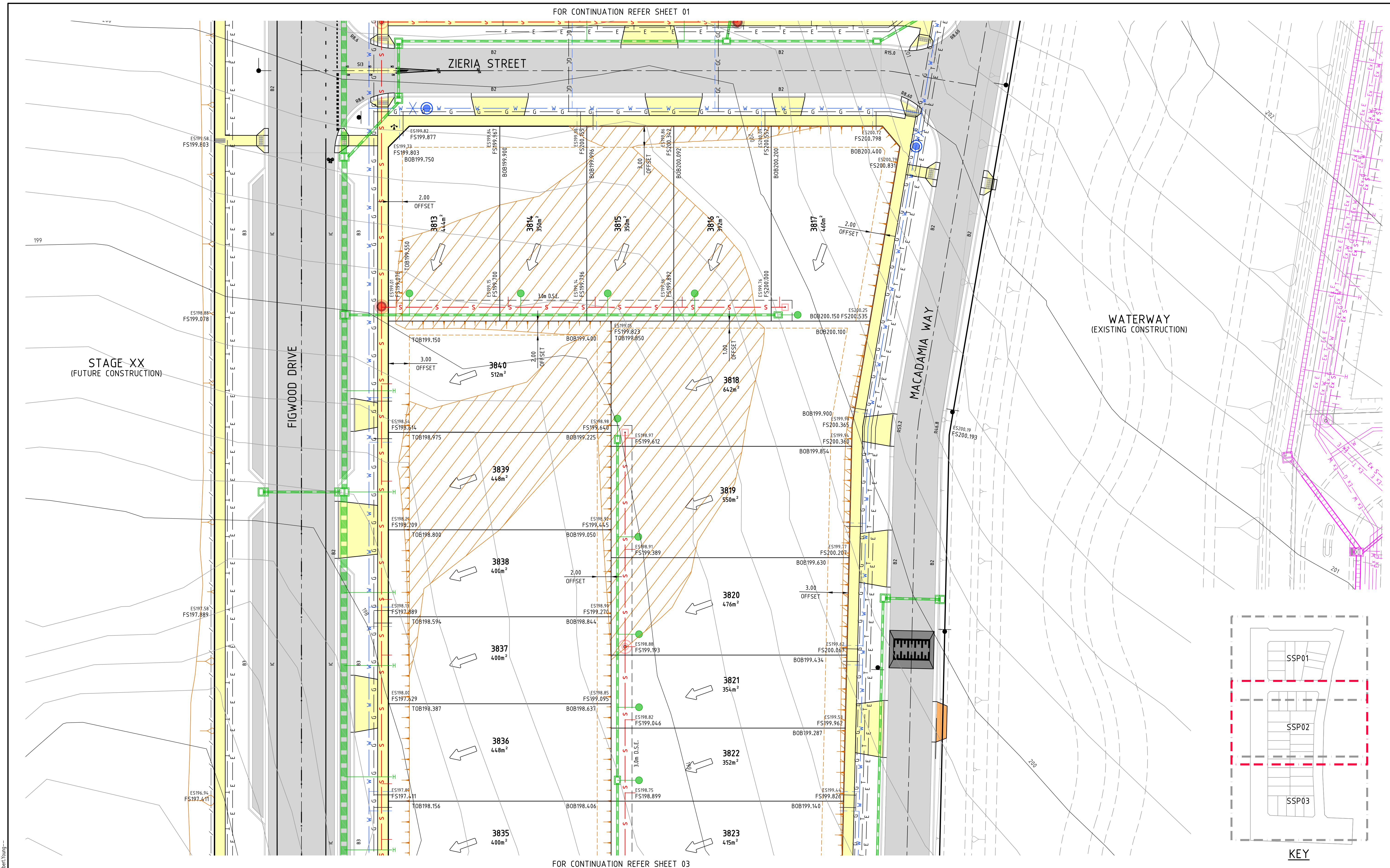

FOR CONTINUATION REFER SHEET 02

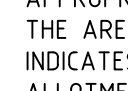
- NOTES: FILL PLAN**
- THIS PLAN SHOWS DETAILS OF WORKS AFFECTING THE NATURAL SURFACE OF THE LAND WITHIN THE SUBDIVISION WHICH HAVE BEEN CARRIED OUT OR ARE PROPOSED TO BE CARRIED OUT PRIOR TO REGISTRATION OF THE PLAN OF SUBDIVISION, BEING FILL PLACED ON THE LAND TO THE EXTENT AND DEPTH SHOWN ON THIS PLAN.
 - THIS PLAN DOES NOT SHOW ANY OTHER FILL WHICH MAY HAVE BEEN PLACED ON THE LAND PRIOR TO THE CIVIL WORKS BEING UNDERTAKEN.
 - THIS PLAN HAS BEEN PREPARED FOR THE PURPOSE OF CONSTRUCTING SUBDIVISIONAL WORKS AND IS NOT A RECORD OF 'AS BUILT DETAILS'.
 - FILLING SHOWN LESS THAN 300mm DEEP IS GRADED OR SPREAD OVER ALLOTMENTS TO CORRECT MINOR SURFACE IRREGULARITIES SUCH AS FURROWS ETC AND LOT GRADING.
 - IRRESPECTIVE OF THE DEPTH OF FILLING FOUNDATIONS MUST BE DESIGNED AND CONSTRUCTED IN ACCORDANCE WITH A SOIL CLASSIFICATION AND REPORT PREPARED FOR THE PURPOSE AND IN ACCORDANCE WITH THE APPROPRIATE BUILDING REGULATIONS.
 - THE AREA MARKED THUS  ON THIS PLAN INDICATES FILL DEEPER THAN 300mm PLACED ON ALLOTMENTS.
 - THE EXTENT OF AND DEPTH OF FILL MUST BE CONFIRMED BY A PROPER GEOTECHNICAL INVESTIGATION BY AN EXPERIENCED PRACTITIONER.

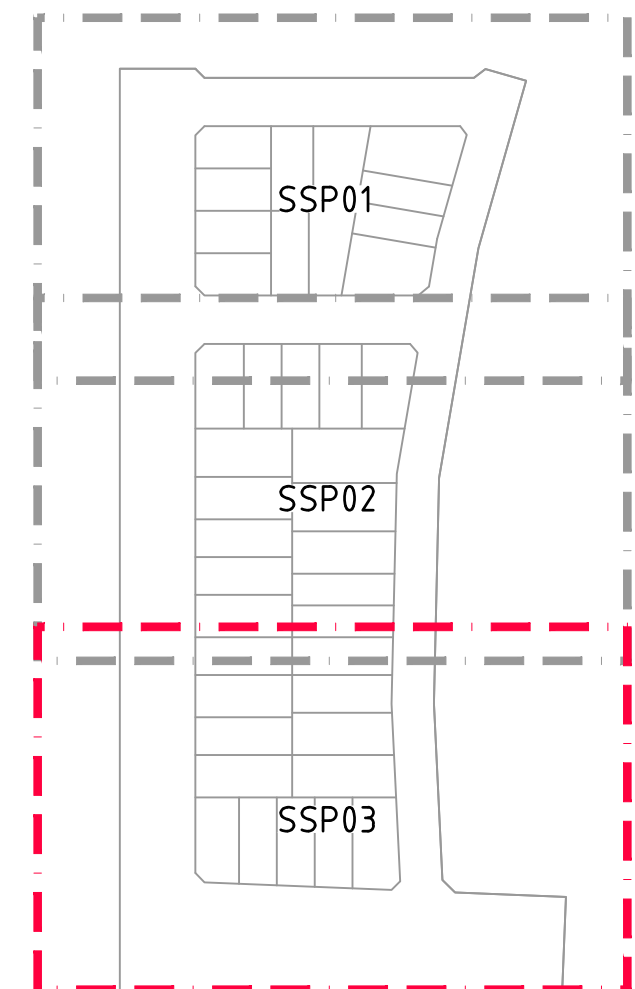

KEY

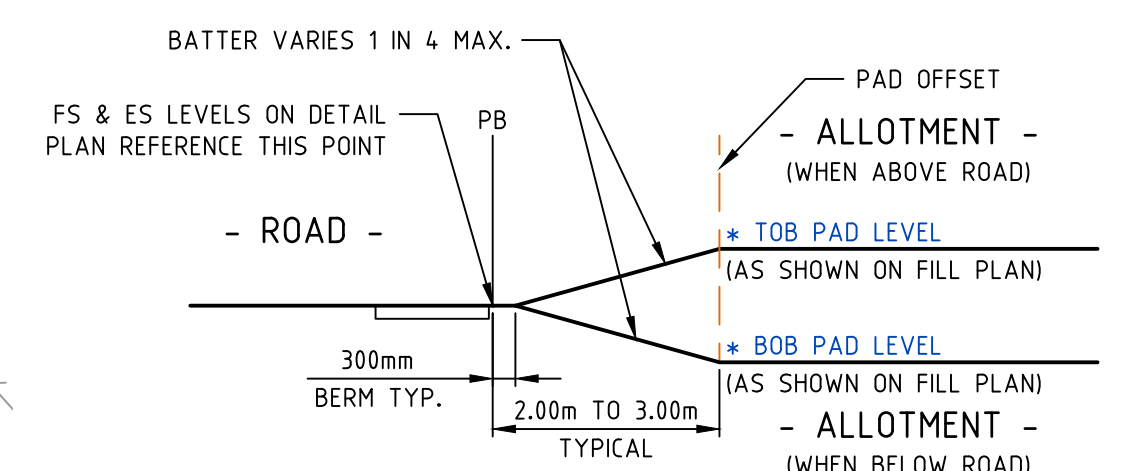

TYPICAL EARTHWORKS BATTER TREATMENT
(LOT FRONTAGE TO ROAD)
SCALE: N.T.S.

WATERWAY
(EXISTING CONSTRUCTION)

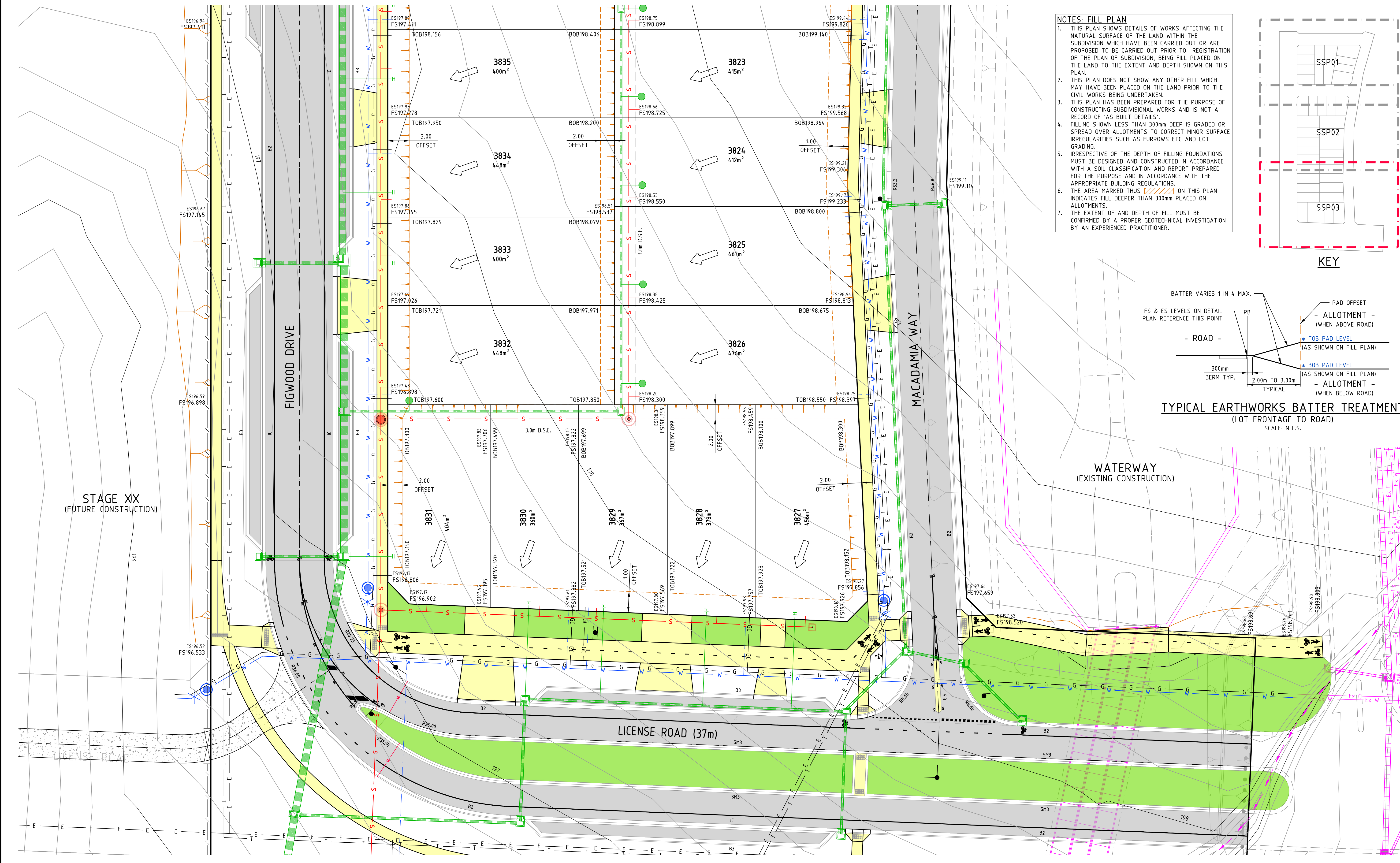

STAGE XX
(FUTURE CONSTRUCTION)

Drawing File: C:\24_Synergy\delta\delta\ENERGY-ME\12655_38-Bloomdale Stage_38 (PO Number 38602)_1327\1_LAYOUT\01_ACAD\03_GENERAL\12655_38SSP03.dwg
 Date/Time: Wed Nov 02, 2022 - 11:59am
 User: Robert Young

REV	DESCRIPTION	DATE	AMEND	APP'D
D	FINAL CLIENT ISSUE	02/11/22	KP/RY	TL
C	PRELIMINARY ISSUE	18/01/22	KP/RY	TL
B	PRELIMINARY ISSUE	03/11/21	KP/RY	TL
A	PRELIMINARY ISSUE	28/10/21	KP/RY	TL

Drawn Date AN
 28/10/21
 R.YOUNG
 Designed Date K.PHAL
 28/10/21
 Checked Date AN
 Approved Date AN

- LEGEND**
- Ex W - EX. WATER MAIN
 - Ex G - EX. GAS MAIN
 - Ex E - EX. ELECTRICAL CABLE
 - Ex S - EX. SEWER MAIN & MH
 - Ex T - EX. COMM. CABLE & PIT
 - Ex D - EX. DRAIN & PIT
 - Signage
 - PSM | TBM
 - Electricity
 - Telecommunications
 - Gas
 - Water
 - DW/GAS CONDUITS
 - Sewer Main & Manhole
 - SW Drain & Pit
 - House Drn | Prop. Inlet

- Regrade Lot (Min 1:50)
- Asphalt Pavement
- Concrete Path | D'Way
- Heavy Duty D'Way
- Raised Platform
- Landscaping
- Filling Over 300mm
- Water Hydrants, Washbais & Valves
- FS21.650 - FINISHED SURFACE LEVEL
- ES20.06 - EX. SURFACE LEVEL
- TOB21.650 - TOP OF BATTER LEVEL
- BOB21.650 - BOTTOM OF BATTER LEVEL
- Batter
- Benching
- Fence (Type 1)
- Fence (Type 2)

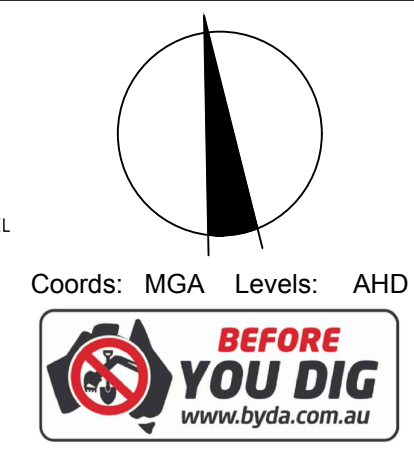

AVID
Property Group

0m 2.5m 5m 10m 15m
 Scale @ A1/A3 1:250 / 1:500

BLOOMDALE ESTATE
PARCEL C - STAGE 38
 146 DIGGERS REST - COIMADAI ROAD, DIGGERS REST 3427
MELTON CITY COUNCIL
CONTRACT PLANS
SHEET 03 OF 03
 Drawing No. 12655.38SSP03 Rev D
 Sheet No. 03 of 03

DALTON CONSULTING ENGINEERS
 ABN 78 429 221 049
 QUEENSLAND
 T 61 7 3374 9000
 E info@dceng.com.au

VICTORIA
 T 61 3 9813 7400
 W dceng.com.au

CONSTRUCTION